



## Campion Close, BLACKWATER, Hampshire GU17 9DU

PRICE £450,000

\*NO ONWARD CHAIN\* Jigsaw Estates are pleased to present to the market this detached property situated in a quiet cul-de-sac location which offers easy access to both Camberley, Frimley & Farnborough. The property is located only a short distance from Blackwater which offers a number of local amenities including supermarkets and pubs. The Meadows shopping Centre with Marks & Spencers, Tesco and Next are also close by and there is easy access to Camberley town centre and Farnborough with its mainline station. Accommodation comprises three bedrooms, living room, dining room and re-fitted kitchen. Further benefits include a cloakroom, en-suite shower room and family bathroom. Outside to the rear there is a private garden and decking area with side access. To the front there is a driveway for two cars (with ample scope to extend the drive to give additional parking). Viewings are highly recommended.

Mis-descriptions Act: We wish to inform prospective purchasers that we have not carried out a detailed survey or tested the services, appliances and specific fittings including any heating system for this property. Floorplans shown are for illustrative purposes only and are not drawn to scale.



- THREE BEDROOMS
- TWO RECEPTION ROOMS
- NO ONWARD CHAIN
- DINING ROOM
- DRIVEWAY FOR 2 CARS
- CLOAKROOM
- DETACHED
- CUL-DE-SAC
- LIVING ROOM
- RE-FITTED KITCHEN
- EN-SUITE SHOWER ROOM

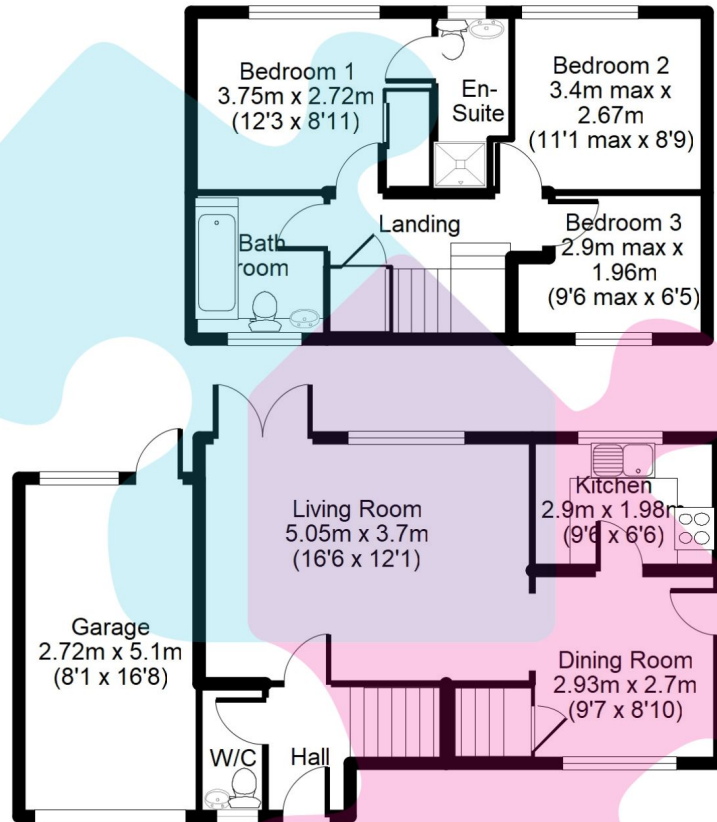

Approx. Total Floor Area:  
94 Sq M = 1011 Sq Ft  
(Includes Garage)

Floorplan is for illustration purposes only.  
All measurements are approximate and should be verified.

