

A 27.16 acre parcel of land in a stunning position nestled in the foothills of the Cambrian mountains, West Wales



Lot 1, Land at Ffynnon Wen, Bontnewydd, Aberystwyth, Ceredigion. SY23
4JJ.

£145,000

REF: A/5052/LD Guide Price

- *** Unspoilt position at the foothills of the Welsh Cambrian Mountains *** A 27.16 acre parcel of land split into good sized and manageable paddocks *** Recently stocked fenced and with new gated entrance point and hard standing
- *** Drainage works carried out on all boundaries *** Majority level pasture although being returned to nature in recent times - In need of attention *** Source of the Aeron River runs through the land - Natural water supply *** Perfect for Animal keeping or for alternative uses *** Picturesque rural location
- *** Rarely available parcel of land enjoying far reaching views over the surrounding Cambrian Mountains *** Great opportunity - A Conservationists' dream with good productive pasture capabilities *** Contact the Sole Selling Agents today



LAMPETER
12, Harford Square, Lampeter,
Ceredigion, SA48 7DT
Tel:01570 423623
lampeter@morgananddavies.co.uk



ABERAERON
4, Market Street, Aberaeron,
Ceredigion, SA46 0AS
Tel:01545 571 600
aberaeron@morgananddavies.co.uk



CARMARTHEN
11, Lammas St, Carmarthen,
Carmarthenshire, SA31 3AD
Tel:01267 493444
carmarthen@morgananddavies.co.uk

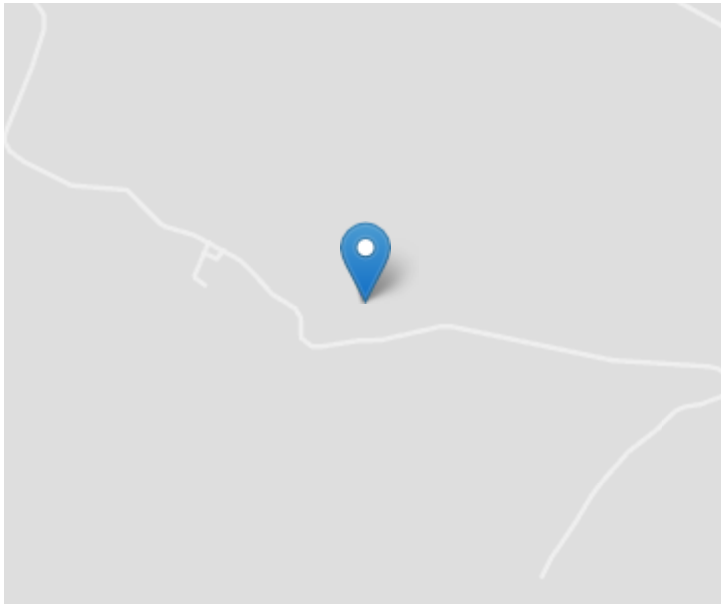

MAIN IMAGE



LAND (FIRST IMAGE)



LAND (SECOND IMAGE)



LOCATION

In delightful countryside surroundings close to the rural Community of Bontnewydd which lies some 12 miles South from the Coastal Resort University Town and Administrative Centre of Aberystwyth, some 11 miles from the Georgian Harbour Town of Aberaeron and some 7 miles from the Market Town of Tregaron in the upper reaches of the Teifi Valley in an area renowned for country pursuits that include walking, cycling, fishing and Bird watching.

GENERAL DESCRIPTION

Morgan & Davies are delighted to market this well positioned and highly appealing parcel of land. The land extends to approximately 27.16 acres or thereabouts and is split into well managed paddocks, recently Stock proofed with good gated access point and hard standing area.

The land suits a range of uses, from Animal keeping to amenity land, and in all very appealing and a viewing is highly recommended. Contact the Sole Selling Agents today.

ENTRANCE



Services

We are informed by the current Vendors that the land benefits from natural water supply on the land.

DRAINAGE WORKS



RIVER AERON



what3words

what3words will point you to where the properties lies on the map - [connects.idealists.takeover](https://www.what3words.com/)

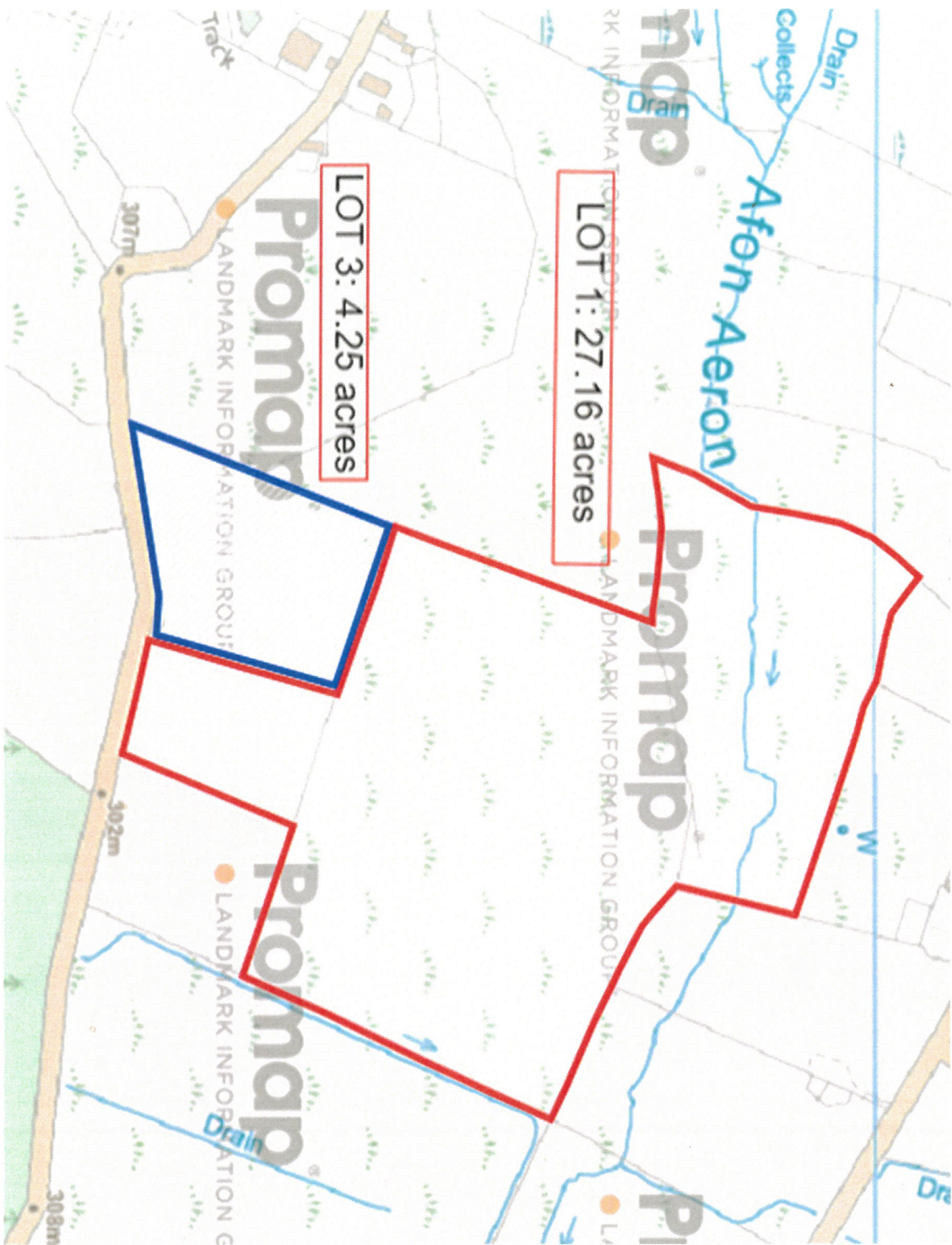

LOT 1: 27.16 acres

LOT 3: 4.25 acres

Promap

Promap

Promap

Promap

LANDMARK INFORMATION GROUP

LANDMARK INFORMATION GROUP

307m

302m

308m

Drain Collects

Afon Aeron

W

Drain

LANDMARK INFORMATION GROUP

LANDMARK INFORMATION GROUP

LANDMARK INFORMATION GROUP

