

Truuli



New Barns Avenue, Mitcham, Surrey, CR4

£550,000 Freehold

- Four bedroom family home
- Off street parking
- En suite shower to primary bedroom
- Scope to extend to the rear
- Close to Mitcham Common
- Quiet and peaceful location

New Barns Avenue, Mitcham, Surrey, CR4

£550,000 Freehold

*** Agents comments *** " Move straight into this four-bedroom mid-terrace family home located just minutes away from Mitcham Common, on a sought-after road.

The property offers versatility for a growing family with the potential to extend to the rear (subject to planning permission)....."

Ground Floor
453 sq.ft. (42.1 sq.m.) approx.

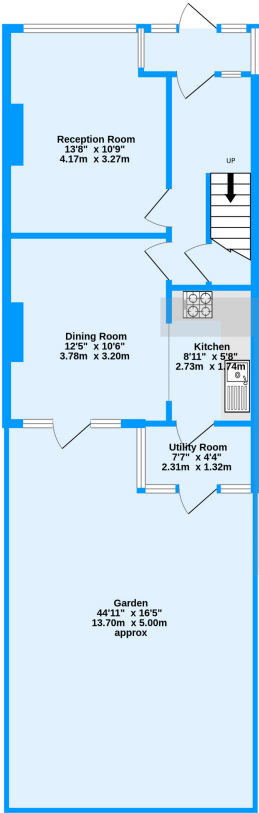

1st Floor
413 sq.ft. (38.3 sq.m.) approx.

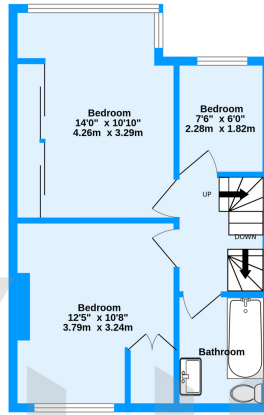

2nd Floor
318 sq.ft. (29.5 sq.m.) approx.

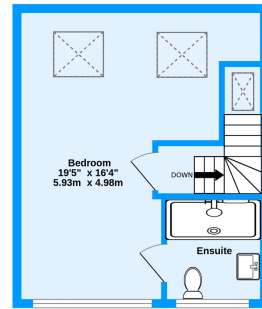

New Barns Avenue, Mitcham, CR4

TOTAL FLOOR AREA : 1184 sq.ft. (110.0 sq.m.) approx.
Measurements are approximate. Not to scale. Illustrative purposes only
Made with Metropix ©2023

