

# Truuli



## Giffin Street, London, SE8 4RJ

£400,000 Leasehold

- Private and secluded garden
- New carpets recently put down
- Part tiled bathroom
- Two double bedrooms
- Excellent community atmosphere
- Superb transport links

Southbridge Place, Surrey, CR0 4HA

Tel: 0330 043 0002

Email: [save@truuli.co.uk](mailto:save@truuli.co.uk) Web: [www.truuli.co.uk](http://www.truuli.co.uk)

# Giffin Street, London, SE8 4RJ

£400,000 Leasehold

\*\*\* Vendors comments \*\*\* "Living in Central Deptford has been a privilege and an incredible convenience and now it's time to pass on this gem to its next owner."

This ground floor flat with a private garden offers the perfect blend of comfort, connectivity, and community in one of London's most vibrant neighbourhoods."

Giffin Street

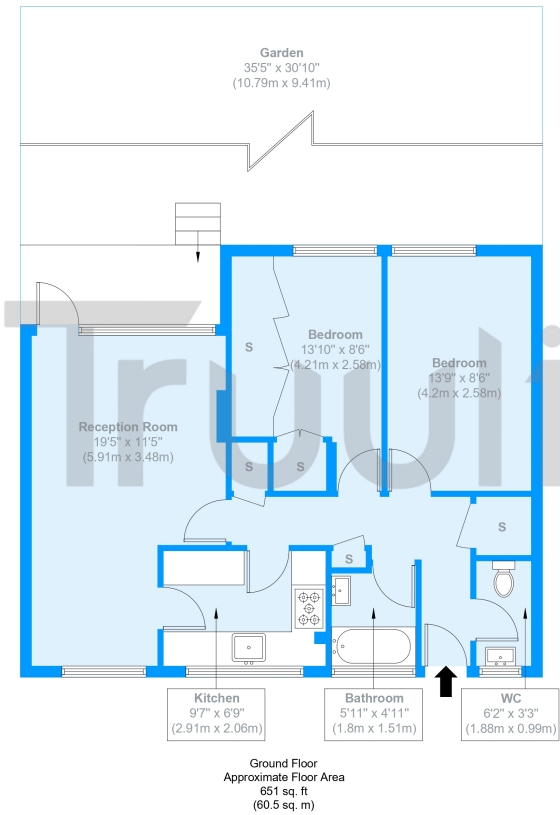

Approximate Gross Internal Area = 60.5 sq m / 651 sq ft

The Floor plan is not to scale and measurements and areas shown are approximate and therefore should be used for illustrative purposes only. The plan has been prepared in accordance with the RICS code of Measuring Practice and whilst we have confidence in the information produced it must not be relied on. Maximum lengths and widths are represented on the floor plan. If there is any aspect of particular importance, you should carry out or commission your own inspection of the property.  
Copyright @ BleuPlan

