



A contemporary and stylish two-bedroom apartment in a sought-after location close to the town centre and trainline. This well maintained development benefits from a secure entry system, allocated parking and communal areas. The apartment has a spacious open plan kitchen/living/dining room, plentiful storage, two double bedrooms and a family bathroom.

This apartment presents the perfect opportunity for first-time buyers

Opportunity for SHARED OWNERSHIP purchase at 40% or full purchase



Property Information

-  SOUGHT AFTER LOCATION
-  SECURE, ALLOCATED PARKING
-  POPULAR DEVELOPMENT WITH SECURE ENTRY SYSTEMS
-  40% SHARED OWNERSHIP
-  2 DOUBLE BEDROOMS
-  OPEN - PLAN KITCHEN/DINING/LIVING ROOM
-  ONWARD CHAIN COMPLETE

					
x2	x1	x1	x1	N	N
Bedrooms	Reception Rooms	Bathrooms	Parking Spaces	Garden	Garage

Location

The property is ideally located for the commuter, being just a 10 minute walk from Maidenhead Train Station which forms part of Crossrail and a short distance to the A404 providing access to the M4 and M40. Maidenhead is a large town in the Royal Borough of Windsor and Maidenhead offering a good range of well known High Street retailers, complimented by a wide variety of independent and specialist stores. The town is currently under regeneration with a new shopping experience in development along with the addition of many new bars and restaurants. The property also enjoys a good range of local shopping including a Sainsburys Local and pharmacy just a short walk away

Floor Plan

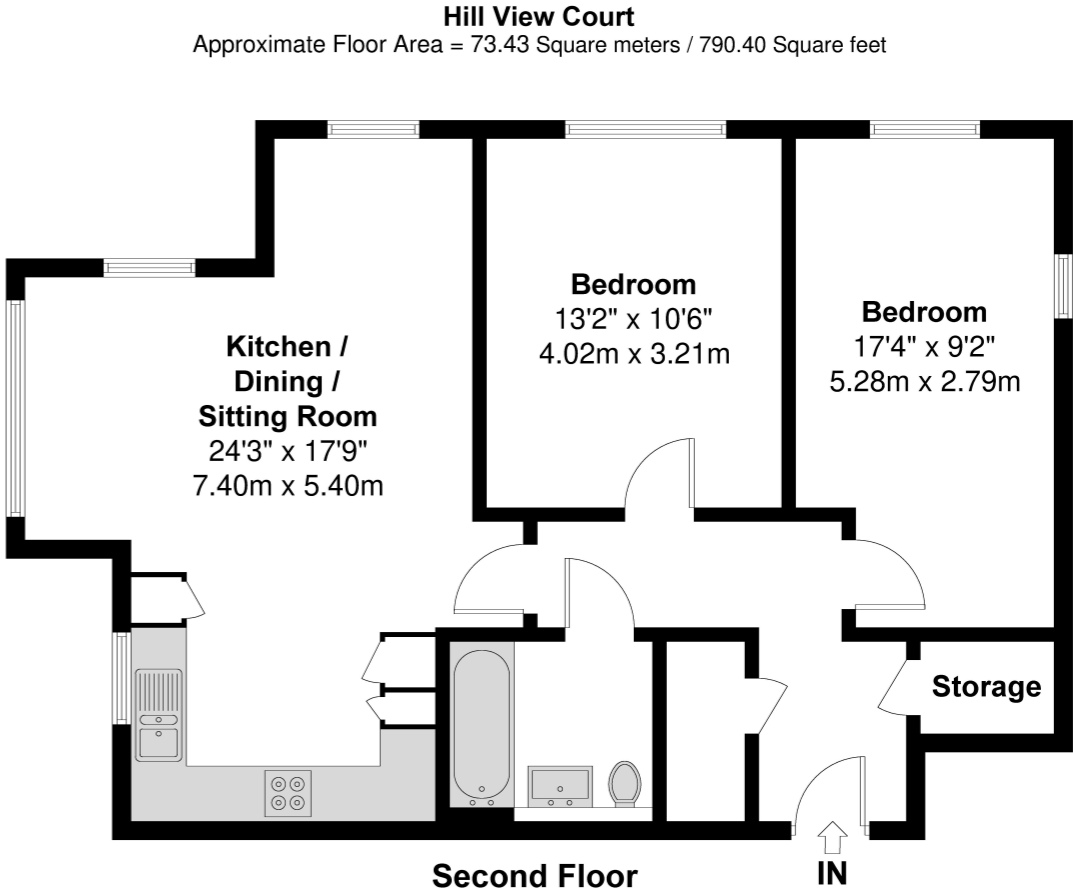

Illustration for identification purposes only, measurements are approximate, not to scale.

Prospective purchasers should be aware that these sales particulars are intended as a general guide only and room sizes should not be relied upon for carpets or furnishing. We have not carried out any form of survey nor have we tested any appliance or services, mechanical or electrical. All maps are supplied by Goview.co.uk from Ordnance Survey mapping. Care has been taken in the preparation of these sales particulars, which are thought to be materially correct, although their accuracy is not guaranteed and they do not form part of any contract.

