

FOR SALE

£200,000 Leasehold



Edith Court, New Road, Bedfont, Feltham, Greater London. TW14 8HF

- Entrance Hall
- Lounge/ Diner
- Open Plan Kitchen
- Large Bedroom
- Modern Bathroom
- Balcony
- 170 Year Lease
- Top Floor Apartment
- Communal Garden
- Highly Recommended



PROPERTY DESCRIPTION

A spacious and well kept top floor apartment with balcony and complete chain. Located in a popular residential road just a short distance from Bedford High Street and Hatton Cross Underground Station, as well as benefitting from a long lease approximately 170 years. Contact our office now for more information.



Entrance Hall

Approached via a side aspect UPVC door, laminate flooring, built in airing cupboard housing the hot water tank.

Living Room

Front and side aspect double glazed windows and door to balcony. Laminate flooring, wall mounted electric radiator and entryway to;

Kitchen

Front aspect double glazed windows, a range of eye and base level units with integrated drainage sink, oven, electric hob, extractor fan and space for white goods, table and chairs.

Bedroom

Side aspect double glazed windows, built in wardrobe, carpeted flooring and wall mounted electric radiator.

Balcony

South facing and large enough for table and chairs.

Tenure

We have been advised there is approximately 170 year lease remaining with an annual service charge of £2304 and no service charge. We recommend this information be confirmed with your solicitor prior to exchange.



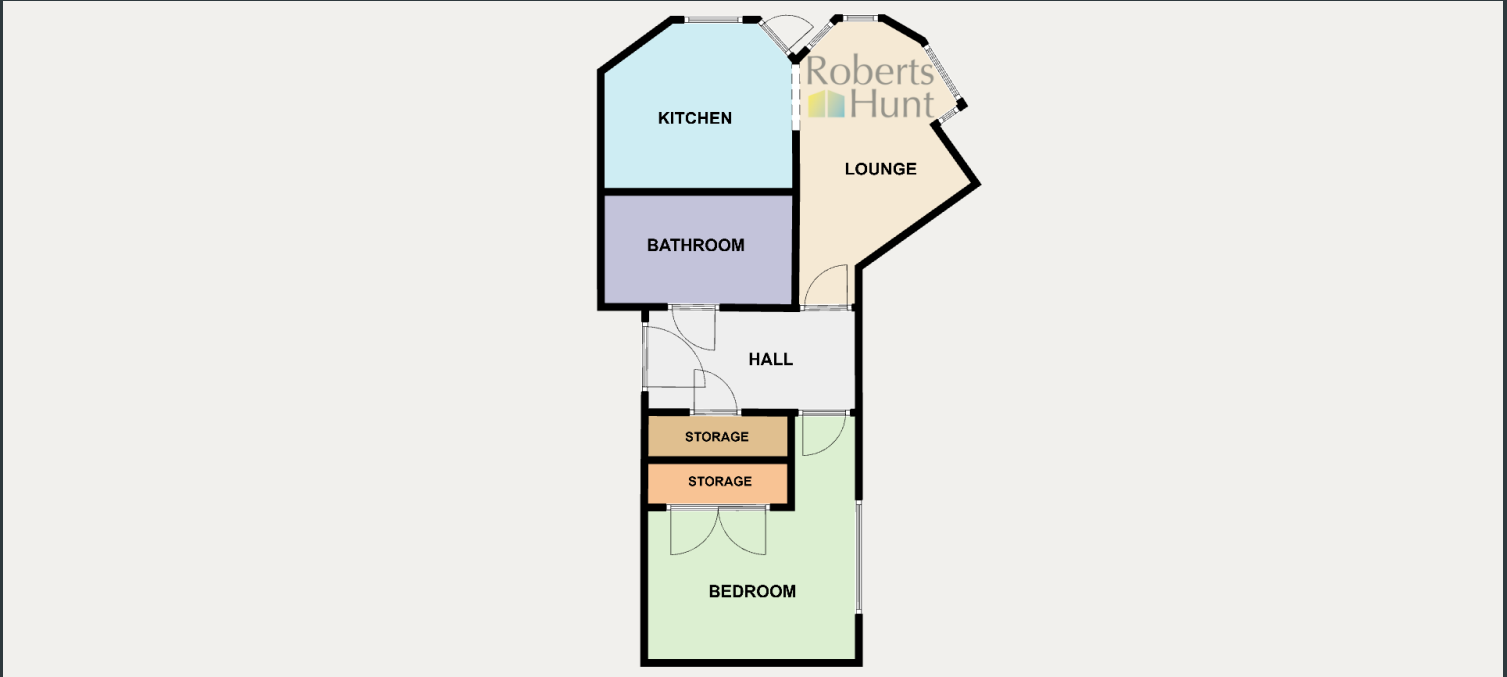

Energy Efficiency Rating		
	Current	Potential
Very energy efficient - lower running costs		
(92+) A		
(81-91) B		
(69-80) C		78
(55-68) D	61	
(39-54) E		
(21-38) F		
(1-20) G		
Not energy efficient - higher running costs		
England, Scotland & Wales		EU Directive 2002/91/EC