



## Apartment 133, Holden Mill Blackburn Road, BOLTON, Lancashire BL1 7LS

AVAILABLE DECEMBER!!! The Purple Property Shop are delighted to market this stunning two bedroom split-level apartment located on the 1st floor of this sought after development. In full the property comprises: entrance hallway, open-plan lounge/diner and kitchen, the bathroom and master bedroom are located on the ground floor; there is a further double bedroom situated on the first floor. Also benefitting from two large storage cupboards. There is a beautiful sun-terrace off the lounge which offers great outdoor space for a large table and chairs. The property is warmed via electric storage heaters and has double glazing in place. There is an indoor parking space available with the apartment at no additional cost. Located in-between Dunscair and Astley Bridge, close to a number of local amenities and schools. Within close proximity to the network, great for working professionals. A holding deposit of one weeks rent will be required. For more information please go to [www.purplepropertyshop.com](http://www.purplepropertyshop.com)

£725 pcm

**the purple**  
property shop

Tel: 01204 598979

## Hallway

Laminate flooring, modern decoration, and intercom security system. Access to the bathroom, open-plan lounge/kitchen/diner, bedroom 1 and stairs to bedroom 2.

## Lounge/Diner

7.28m x 3.09m (23' 11" x 10' 2") Fabulous and spacious open-plan lounge/dining area, laminate flooring with modern & subtle decoration. Accessing an open-plan kitchen. Plenty of natural light floods the room with a large feature patio sliding door to a terrace.

## Kitchen

2.99m x 1.65m (9' 10" x 5' 5") Modern fitted kitchen which comprises: integrated fridge freezer, dishwasher, four ring electric hob/oven/extractor fan. Incorporating a stainless steel sink with draining board and mixer tap. Base and wall mounted storage units. Splash backs, neutral decoration and laminate flooring.

## Bedroom 1

4.51m x 2.70m (14' 10" x 8' 10") Beautifully presented master bedroom offering mirror fronted integrated wardrobes. Laminate flooring, modern decoration and an elongated feature window to the rear elevation looking out onto the decked terrace.

## Bathroom

2.38m x 1.69m (7' 10" x 5' 7") Three piece bathroom suite in white comprising: w/c, hand wash pedestal basin with chrome mixer tap and tile panelled bath which has a wall mounted chrome shower head. Vinyl flooring, partially tiled.

## First Floor

### Stairs & Landing

Carpeted with neutral decoration accessing the second guest bedroom.

### Bedroom 2

5.36m into recess x 2.70m (17' 7" x 8' 10") Double guest bedroom which has carpeted flooring with neutral decoration and a rear elevation window overlooking the terrace. Accessing a large storage cupboard.

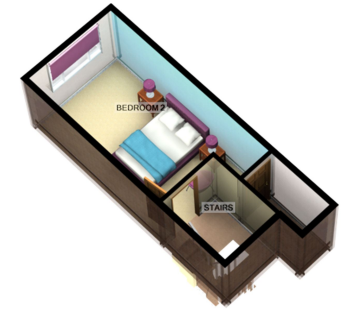

1ST FLOOR  
APPROX. FLOOR  
AREA 197 SQ.FT.  
(18.3 SQ.M.)



GROUND FLOOR  
APPROX. FLOOR  
AREA 658 SQ.FT.  
(61.1 SQ.M.)

TOTAL APPROX. FLOOR AREA 855 SQ.FT. (79.5 SQ.M.)

For illustrative purposes only. Decorative finishes, fixtures, fittings and furnishings do not represent the current state of the property. Measurements are approximate. Not to scale. Made with Metropix ©2017