

Truuli



Bouchier House, Oakfield Road, Croydon, Surrey, CR0

£93,000 Leasehold

- Balcony off of the living room
- Access to a communal roof terrace and bike storage
- Two double bedrooms
- 30% Shared ownership
- Central location for all amenities
- Convenient location close to an array of transport options
- Top floor modern apartment

2, Lansdowne Road, Croydon, Surrey, CR9 2ER

Tel: 0330 043 0002

Email: save@truuli.co.uk Web: www.truuli.co.uk

Bourchier House, Oakfield Road, Croydon, Surrey, CR0

£93,000 Leasehold

30% Shared Ownership ***Vendor's comments:*** "I bought my flat 8 years ago on a shared ownership scheme. This enabled me to be able to get onto the property ladder. I chose Croydon due to all of the regeneration works and terrific transport links.

I am having to sell my beautiful home as I am returning to work in January and I have been assigned a new site that isn't commutable daily with childcare needs".

Third Floor
696 sq.ft. (64.6 sq.m.) approx.

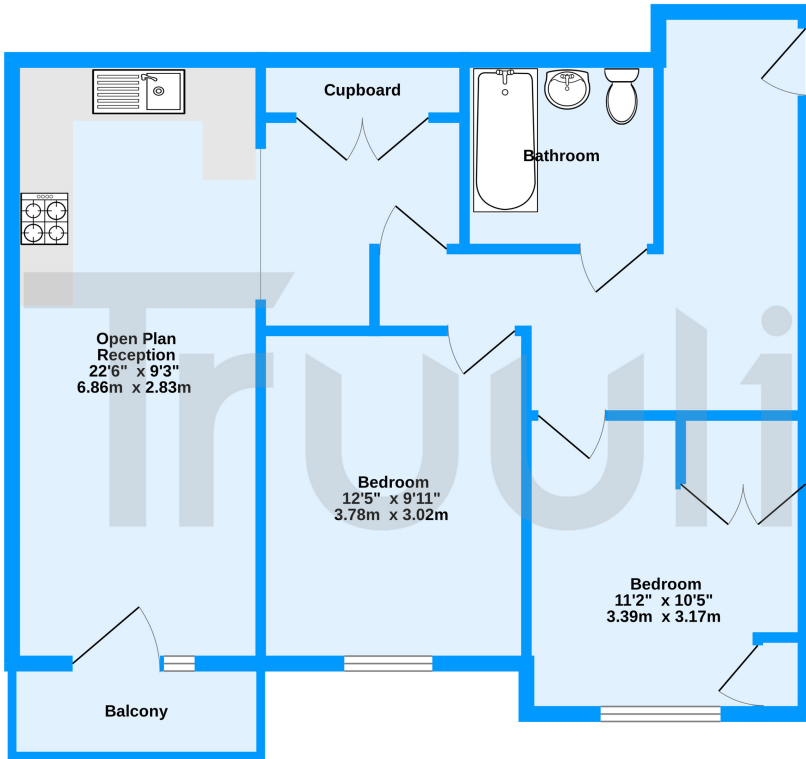

Bourchier House, Oakfield Road, Croydon, CR0
TOTAL FLOOR AREA: 696 sq.ft. (64.6 sq.m.) approx.
Measurements are approximate. Not to scale. Illustrative purposes only
Made with Metropix ©2023

Energy Efficiency Rating		
	Current	Potential
Very energy efficient - lower running costs		
(92+)		
A		
(81-91)		
B		
(69-80)		
C		
(55-68)		
D		
(39-54)		
E		
(21-38)		
F		
(1-20)		
G		
Not energy efficient - higher running costs		
England, Scotland & Wales	EU Directive 2002/91/EC	

