



34 Langford Road, Henlow, Bedfordshire, SG16 6AF

£450,000

Set back from from road and situated just off a private road is this individual detached bungalow. Built just over 5 years ago to a high specification to include a quality fitted hand painted kitchen/diner with utility room, formal lounge with multi fuel burner, two double bedrooms plus bathroom and cloakroom. Outside is a gated entrance with gravelled driveway providing ample off road parking, a summer house and the rear garden backs onto open countryside with a gate taking you out to amazing countryside walks. This energy efficient property also comes with solar panels and a large loft space, that could potentially be converted to additional accommodation subject to planning. and also offers individually controlled underfloor heating to all rooms.



- INDIVIDUAL DETACHED BUNGALOW
- PRIVATE QUIET LOCATION
- LOUNGE WITH MULTI-FUEL BURNER
- BESPOKE OPEN PLAN KITCHEN & DINING AREA
- TWO DOUBLE BEDROOMS
- BATHROOM & CLOAKROOM
- AMAZING VIEWS OVER OPEN COUNTRYSIDE
- DRIVEWAY WITH PARKING FOR SEVERAL CARS
- COUNTRY WALKS ON YOUR DOORSTEPS
- SOLAR PANELS

Approximate Gross Internal Area
69.9 sq m / 752 sq ft

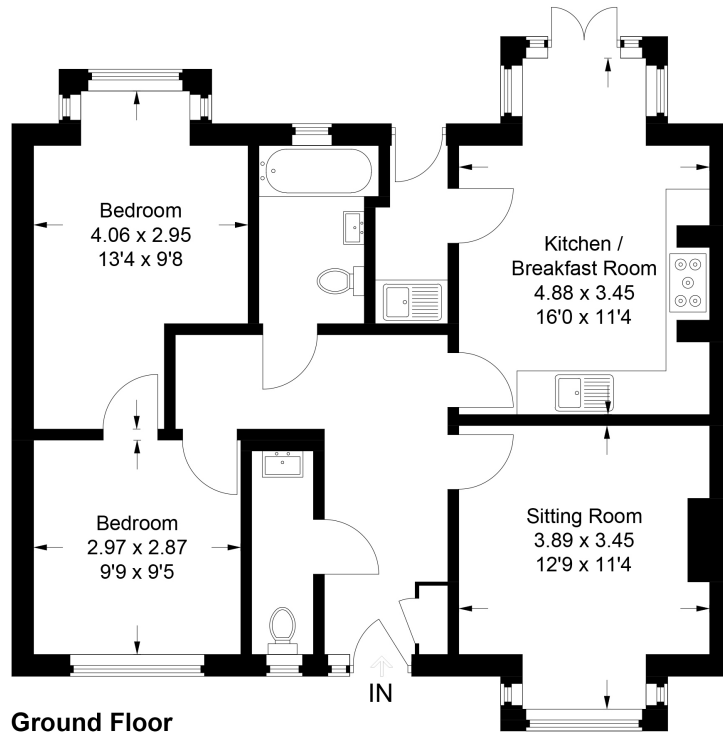

Ground Floor

This plan is for layout guidance only. Not drawn to scale unless stated. Windows and door openings are approximate. Whilst every care is taken in the preparation of this plan, please check all dimensions, shapes and compass bearings before making any decisions reliant upon them.

© CJ Property Marketing Ltd Produced for Lane & Bennetts

