



Peppermint Road

Hitchin | Hertfordshire | SG5 1RY

www.stonegate-estates.co.uk



PEPPERMINT ROAD

Property Description

A well positioned and presented two bedroom ground floor apartment located in this highly desirable location close to the town centre and station.

This part furnished apartment has numerous benefits and features a spacious open plan living/kitchen room with the added benefit of a bay window and is presented in immaculate order throughout. The accommodation comprises of an open plan kitchen/living space with fitted kitchen, two double bedrooms, one with en-suite shower room and fitted wardrobe and a family bathroom. Further benefits include a storage cupboard, allocated parking space and a bike store.

Peppermint Road is a popular modern development located in Hitchin town centre and 0.7 miles, a 14 min walk from the station.

Hitchin is a charming medieval market town and has many fine Tudor and Georgian buildings, particularly around the market square. Near to the market square stands the large medieval parish church of St Mary. The town provides good shopping as well as a swimming pool, football team, two theatres, a wide variety of restaurants and pubs and highly regarded girls and boys schools. There is also a mainline railway station providing direct access to Kings Cross, St Pancras and Cambridge.

£295,000 Leasehold



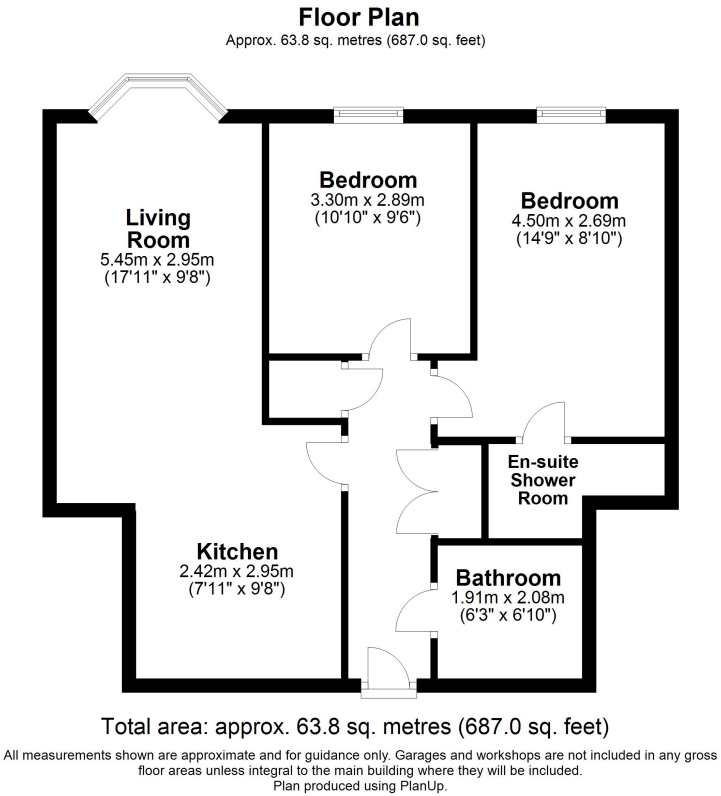



- Ground Floor Apartment
- Two Double Bedrooms
- Allocated Parking
- En-Suite Shower Room
- Town Centre Location
- Walking Distance to Station
- Good Size Accommodation

EPC Rating: B

Stonegate Estate Agents

01462 438979

sales@stonegate-estates.co.uk | www.stonegate-estates.co.uk

