



21d Court Meadow, Stone, Berkeley, GL139LR

Internal Area (Approx)

195.30 Sq.M / 2102.70 Sq.Ft

For identification only. Not to scale.

Produced by Energy Plus

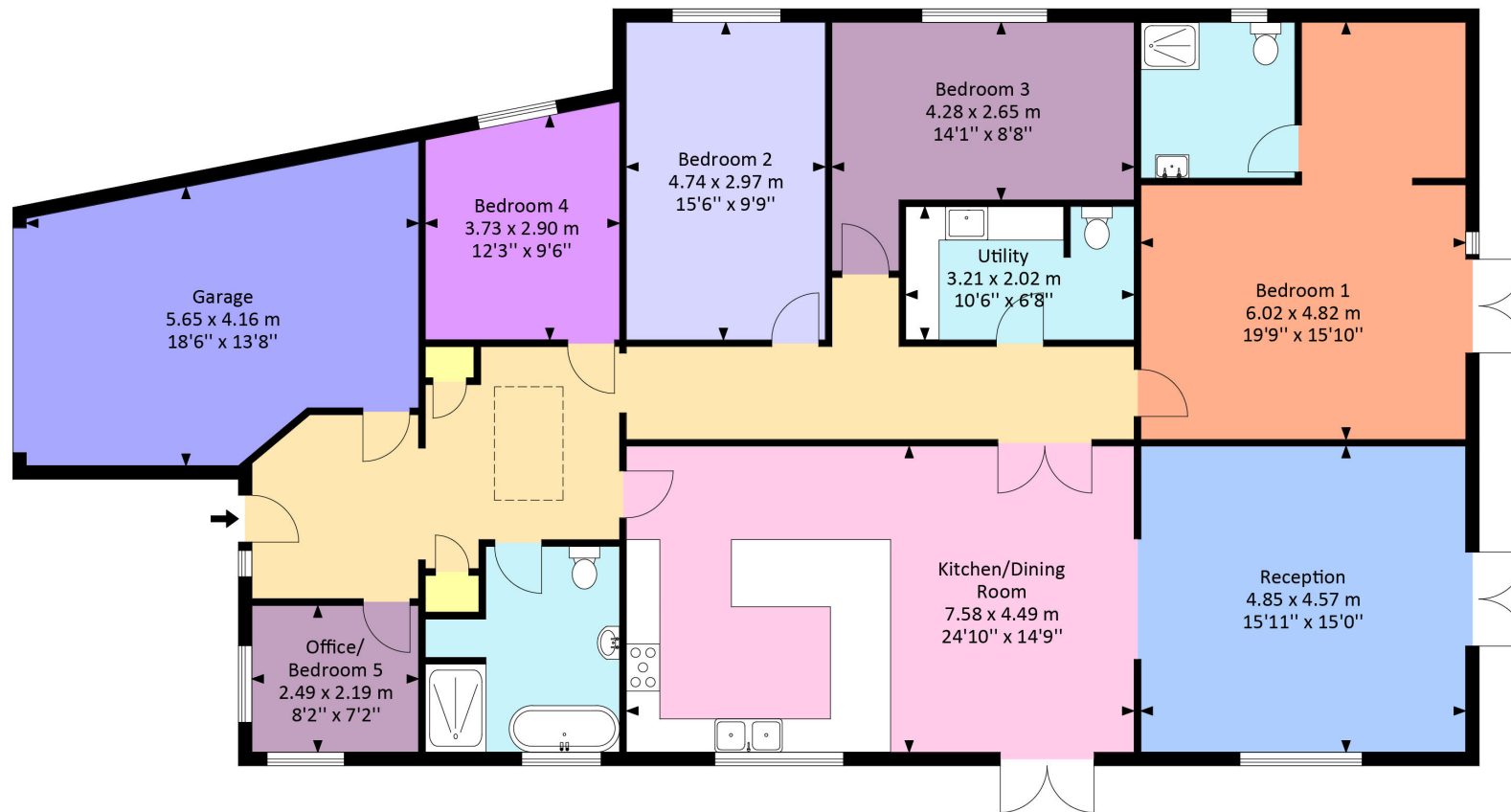

Ground Floor

Laurel House 21D Court Meadow, Stone, Gloucestershire GL13 9LR

This unique modern detached bungalow offers fantastic family space, in a village setting convenient for M5 J14. Country rambles start right from the front door and the village primary school is just a short walk away, beyond the village green. Step inside to discover a spacious and contemporary home, finished off 'just so'. The kitchen/dining/family room includes quality fitted cabinets, granite counters and a breakfast bar, plus plenty of space for everyone to sit and eat together. A separate living room has French doors to the rear garden. There are four double bedrooms, a further fifth bedroom/study/playroom, dressing room, en-suite wet-room and a luxury bathroom. In addition, there is a utility room and cloakroom as well. Practical benefits include double-glazing, LPG central heating (underfloor), generous loft space and an integral garage. Moving outside we find plenty of parking to the front plus landscaped patios and lawn to the side and rear. If you are looking for something individual and quite special, this could be just the place for you - highly recommended!

Situation

The village of Stone is situated approximately 1 mile from junction 14 of the M5 ideal for commuting to Gloucester to the north and Bristol to the south. In the last Ofsted report the local primary school in the village was rated 'Outstanding'. Secondary schools include The Castle School in Thornbury and Katharine Lady Berkeley's in Kingswood. In nearby Falfield, approximately one mile away, is a general stores and post office and Thornbury with it's range of amenities is approximately 4 miles distance providing supermarkets, post office, restaurants and Leisure Centre/Golf Club.

Property Highlights, Accommodation & Services

- Unique Detached Bungalow
- Village Setting Convenient M5 J14
- Walking Distance To Village School
- Fantastic Family Space
- Living Room With French Doors To Garden
- Open-Plan Kitchen/Dining/Family Room
- Four Double Bedrooms
- Bedroom 5/Study/Playroom
- Luxury Bathroom, En-Suite Wet-Room
- Integral Garage

Directions

Travelling north on the A38 once in the village of Stone turn left before the church into Court Meadow. Follow the road round to the left and Laurel House will be found on the right hand side.

Local Authority & Council Tax - Stroud - Tax Band E

Tenure - Freehold

Contact & Viewing - Email: mil_thornburysales@milburys.co.uk Tel: 01454 417336

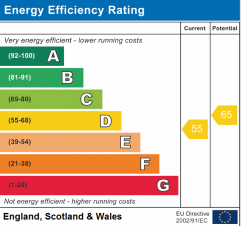
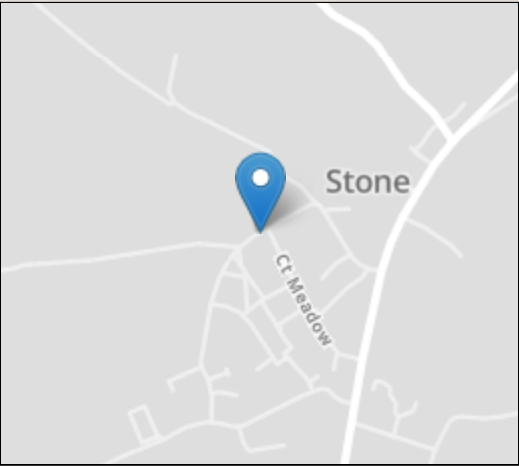

IMPORTANT NOTICE Milburys Estate Agents Ltd, their clients and any joint agents give notice that they have not tested any apparatus, equipment, fixtures, fittings, heating systems, drains or services and so cannot verify they are in working order or fit for their purpose. Interested parties are advised to obtain verification from their surveyor or relevant contractor. Statements pertaining to tenure are also given in good faith and should be verified by your legal representative. Digital images may, on occasion, include the use of a wide angle lens. Please ask if you have any queries about any of the images shown, prior to viewing. Where provided, floor plans are shown purely as an indication of layout. They are not scale drawings and should not be treated as such. Complete listings and full details of all our properties (both for sale and to let) are available at www.milburys.co.uk





