



Flat 1, 121 High Street, Kirkcaldy, Fife, KY1 1LW

Beautifully Presented, Two Bedroom First Floor Flat, Part of a Modern Conversion of a Period Stone Terrace

Up to date price and viewing info at mov8realestate.com/property

espc rightmove[®] Zoopla
find your happy

Property Description

Light and beautifully-presented, two-bedroom, first floor flat, forming part modern conversion of a period stone-built terrace. Located in the heart of Kirkcaldy's historic town centre, in Fife.

Comprises an; entrance hallway, living/dining room, kitchen, two double bedrooms, and a bathroom. Highlights include a modern fitted kitchen, contemporary flooring and lighting, and an impressive skylight cupola for the public room.

Tastefully finished there is also gas central heating, double glazing, a stylish bathroom with a separate shower cubicle and multiple TV points. A secured entry door is accessed from Hill Street to the rear, with a charming enclosed passageway opening to a further communal terrace and entrance hall.

A lengthy L-shaped hallway gives access throughout the property, including to a walk-in store cupboard and the secured entry phone system. Set to the rear is an impressive public room with spot lighting and an exceptionally large skylight cupola offering a unique living space. Set internally, a good-sized modern kitchen includes stone-effect worktops, a tiled surround, sink with drainer and an integrated oven and gas hob. The two stylish bedrooms quietly overlook the pedestrianised High Street, tastefully finished in contemporary decor and flooring. A generous fully tiled bathroom is set internally, and fitted with a modern suite, including a separate integrated shower.



Flat 1, 121 High Street, Kirkcaldy KY1 1LW

Approximate Gross Internal Area: (840 sq ft - 78 sq m.)

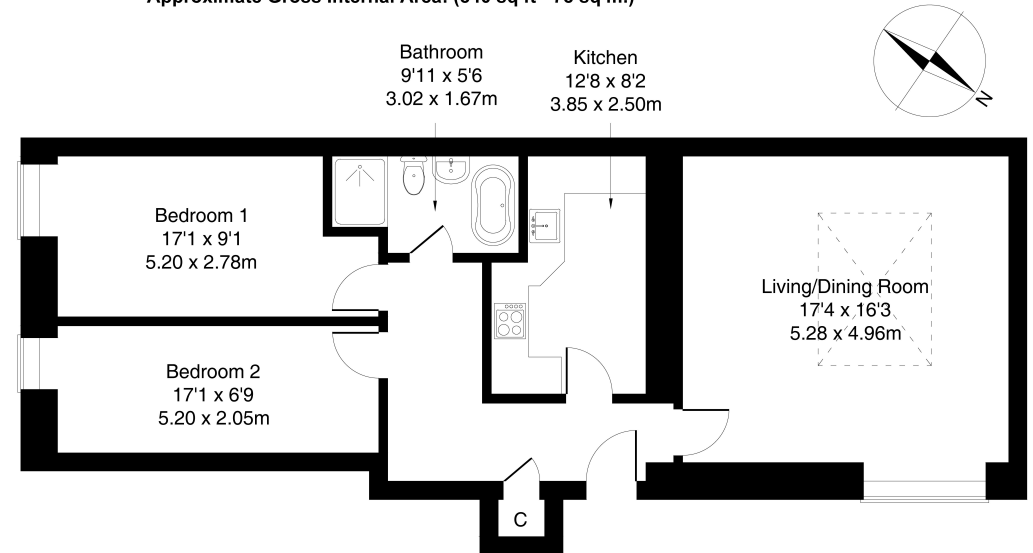

Legal Disclaimer : Floor-plan and measurements are for illustrative guidance only, and not intended to form part of any contract.

Area Description

Kirkcaldy is located on the north coast of the Firth of Forth, and is one of Fife's principal towns. It provides a wide range of retail, cultural and leisure services, as well as primary and secondary schooling, and further education at the Adam Smith College. It is home to a museum and an art gallery, as well as the renowned Adam Smith Theatre. Shopping facilities to be found in the Fife Central Retail

Park include a Sainsbury's, B&Q and Next, with many other high-street names also to be found in the town centre, whilst the modern Victoria Hospital serves much of Fife. The railway station brings Edinburgh and Dundee within easy commuting distance, whilst the A92 allows easy access to the motorway network and Edinburgh Airport.





Our Services

-  Free pre-sale property valuations
-  Great value fixed estate agency fees
-  Extensive buyer matching database
-  Purchase and sale conveyancing

Contact Us

0345 646 0208

sales@mov8realestate.com

www.mov8.com

Head Office

6 Redheughs Rigg, Edinburgh, EH12 9DQ

Glasgow Office

77 Renfrew Street, Glasgow, G2 3BZ



Estate Agents and Solicitors



These particulars do not form part of any contract and the statements or plans contained herein are not warranted nor are they to scale. All descriptions, dimensions, areas, reference to condition and necessary permissions for use and occupation and other details are given in good faith, and are believed to be correct, but any prospective purchaser should not rely on them as statements or representations of fact, and any prospective purchaser must satisfy themselves by inspection or otherwise as to the correctness of each of them. The Seller shall not be bound to accept the highest or any offer nor to accept a full offer of the Fixed Price where this is applicable. Approximate measurements have been taken by sonic device and measurements are most often taken to the widest point of any room or space. Services and appliances have not been tested for efficiency or safety and no warranty is given as to their compliance with any Regulations. Offers should be made using the Combined Standard Clauses.