



Jefferson Place,
Bromley, Kent. BR2 9FX

Tenure: Leasehold

2 Bedrooms | 1 Reception Room | 2 Bathrooms



Rare to the market is this stunning two bedroom, two bathrooms "duplex" penthouse apartment within the Trinity Village development. The apartment is set over two floors and offers ample living space throughout. Entering the apartment you will find a double bedroom, family bathroom and an open-plan kitchen / living room with access to a private balcony. Upstairs you will find a further bedroom with en-suite. Situated within close proximity of local shops and transport links, the property benefits from a lift, gated entrance and secure parking. EPC Rating C.

Enquiries To:

T: 020 8467 2252

E: beosales@georgeproctor.com

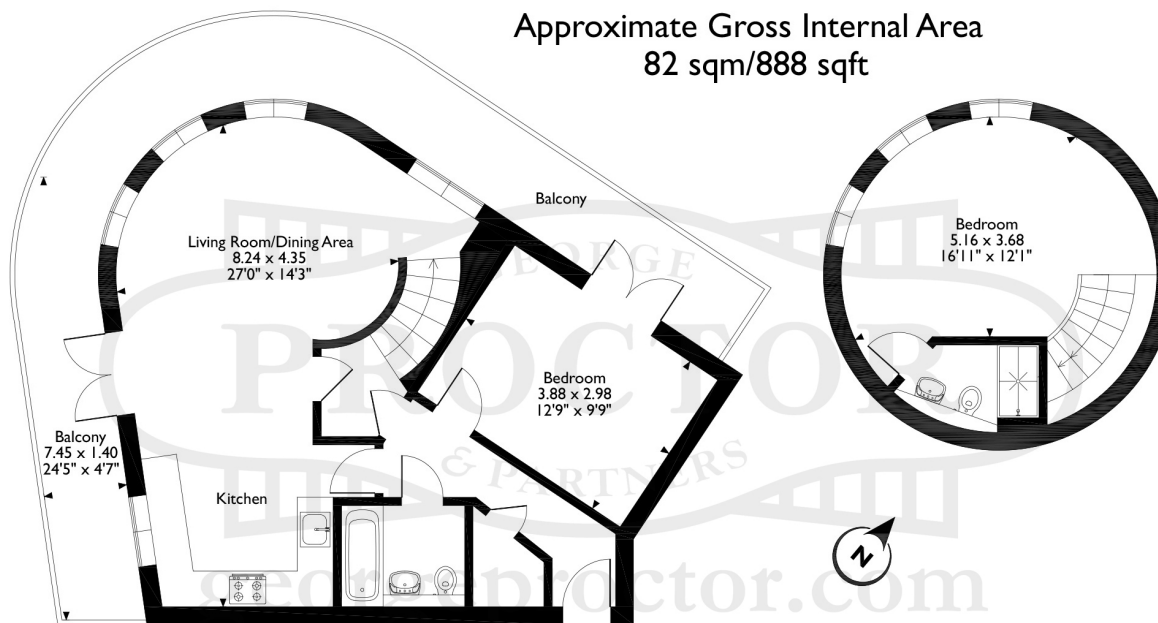

Third Floor (Level 1)

Fourth Floor (Level 2)

Please note that the location of doors, windows and other items are approximate and this floorplan is to be used for illustrative purposes only. Unauthorized reproduction is prohibited.

These particulars whilst believed to be accurate are made without responsibility on the part of the vendor or agents, their accuracy is not guaranteed nor do they form part of any contract and no warranty is given. Services or appliances have not been tested and no guarantee can be given as to their operation, buyers should seek professional advice where necessary. All measurements are approximate and may be rounded to the nearest three inches (10 cm). Floor plans, where shown, are indicative only. Any photographs included may be taken with the use of a wide angle lens. If there is a matter of particular interest please contact us for further information, especially before travelling any distance to view. Map reproduced by permission of Geographers A-Z Map Co Ltd. Licence No. A0514. This map is based upon Ordnance Survey maps with the permission of the controller of Her Majesty's Stationary Office.

The Bickley Estate Office

Southborough Road, Bickley, Kent, BR1 2EB