

FOR SALE

£475,000 Freehold



Oakland Wood, Hatfield, Hertfordshire. AL10 8LU

- CHAIN FREE
- GARAGE AND DRIVEWAY
- FOUR BEDROOMS
- TWO BATHROOMS
- KITCHEN/DINER
- EN-SUITE
- WALKING DISTANCE TO TRAIN STATION
- CLOSE TO BISOPS GIRLS SCHOOL



PROPERTY DESCRIPTION

****GUIDE PRICE £475,000 - £500,000****

This chain free four bedroom home situated in the heart of Hatfield has been beautifully finished and ready to move into. The ground floor has a garage and leads into the stunning kitchen/diner along with separate W/C, on the first floor you will find the lounge, master bedroom and en-suite, then to the second floor has three good size bedrooms, family bathroom and plenty of storage.

Local amenities include;

Bishops Girls School (Outstanding) 0.2 Miles

Asda 0.2 miles

Town Centre 0.2 Miles

Doctors 0.2 miles

Hatfield Station 0.9 miles



ROOM DESCRIPTIONS

ENTRANCE HALL

W/C

1.64m x 0.88m (5' 5" x 2' 11")

GARAGE

5.01m x 2.60m (16' 5" x 8' 6")

KITCHEN/DINER

3.36m x 4.59m (11' 0" x 15' 1")

FIRST FLOOR

EN-SUITE

1.53m x 2.32m (5' 0" x 7' 7")

BEDROOM THREE

2.96m x 4.01m (9' 9" x 13' 2")

LOUNGE

4.41m x 4.58m (14' 6" x 15' 0")

SECOND FLOOR

BEDROOM FOUR

2.70m x 2.0m (8' 10" x 6' 7")

BEDROOM TWO

3.67m x 2.52m (12' 0" x 8' 3")

MASTER BEDROOM

2.98m x 4.60m (9' 9" x 15' 1")



FLOORPLAN & EPC

KALM
- ESTATE AGENTS -

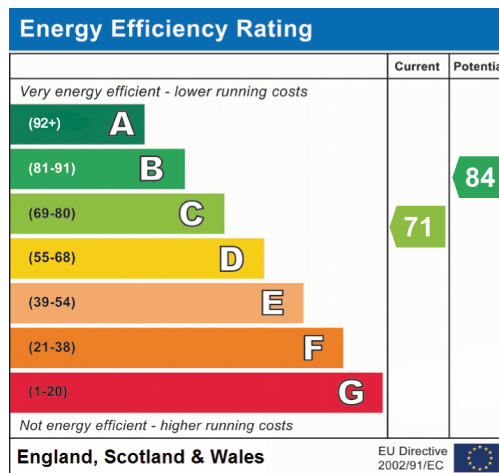
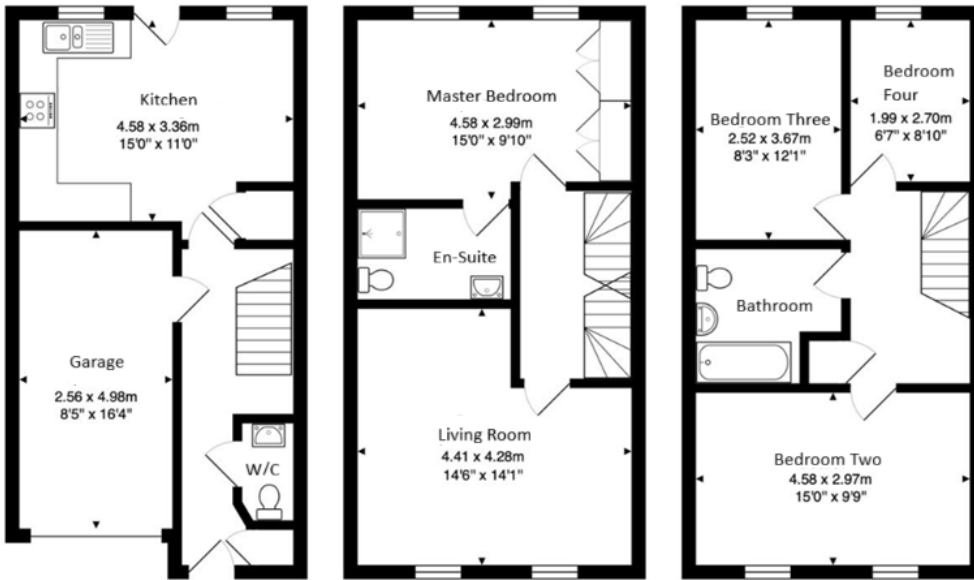

Stevenage
29, Shephall Green, Stevenage, SG2 9XS
01438 572020
linzi.davis@kalmestateagents.co.uk