



LILY
COTTAGES
1901

50

52

50 Littledale Street, Kempston, Bedford, Bedfordshire MK42 8PH

WALDENS ESTATE AGENTS



50 Littledale Street
Kempston
Bedford
Bedfordshire
MK42 8PH

£245,000

3 Bedroom semi-detached property built around 1901 and offered for sale with no onward chain. Situated close to local shops and Addison Howard Park. Lounge/diner, kitchen, downstairs bathroom, enclosed rear garden.

- 3 Bed Semi-Detached Property
- No onward chain
- Lounge/diner
- Kitchen
- Downstairs bathroom
- Double glazed windows
- Gas central heating
- Enclosed rear garden

- Council Tax Band B
- Energy Efficiency Rating D



Close to Addison Howard Park and an array of local shops. Local bus routes.



Entering the property into the hallway with stairs to first floor and door to living area. Lounge/diner with ample room to entertain with windows to front and rear aspect. Kitchen with a range of units, space for all white goods, door to rear garden. Bathroom comprising of shower cubicle, wash hand basin, WC. On the first floor are the 3 Bedrooms with the second bedroom housing the boiler. On the outside the rear garden is all laid to paving. Gated side access leading to the front.



Ground Floor

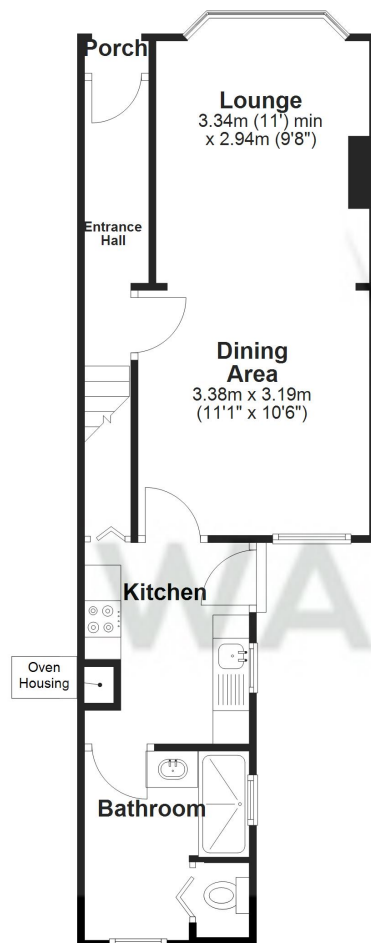

First Floor

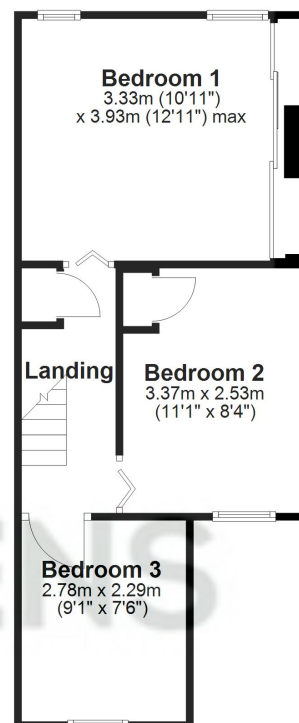

Total area: approx. 73.1 sq. metres (786.3 sq. feet)

| Energy Efficiency Rating | | |
|---|-----------|-------------------------|
| | Current | Potential |
| Very energy efficient - lower running costs | | |
| (92+) A | | 83 |
| (81-91) B | | |
| (69-80) C | | |
| (55-68) D | 59 | |
| (39-54) E | | |
| (21-38) F | | |
| (1-20) G | | |
| Not energy efficient - higher running costs | | |
| England, Scotland & Wales | | EU Directive 2002/91/EC |

01234 856684 | sales@waldens.co.uk | www.waldens.co.uk | 188-190 Bedford Road, Bedford, MK42 8BL

The information contained in the property details are designed to help you decide whether you would like to view the property and to avoid wasting your time in viewing unsuitable properties. We endeavour to ensure accurate information is detailed, but we are largely guided by information supplied to us by the seller. We are unable to check all aspects of the property as this would be prohibitive. Some of the photographs are taken using a wide- angled lens. Where a floor plan has been provided, this is for guidance purposes only.

