

FOR SALE

£350,000

Riverside Gardens, Wembley, Greater London. HA0



Peter Gamble & Co. offer to the market this lovely GROUND FLOOR 2 BEDROOM MAISONETTE WITH PRIVATE GARDEN.

Situated in a prime position with easy access to Alperton and Hanger lane tube stations, Riverside Gardens is a quiet cul-de-sac offering space and privacy.

This good sized maisonette benefits from a large private rear garden and NO service charges!

Gas central heating and double glazing.











# Approximate Gross Internal Area 579 sq ft - 54 sq m

Ground Floor Area 530 sq ft – 49 sq m

Outbuilding Area 49 sq ft – 5 sq m

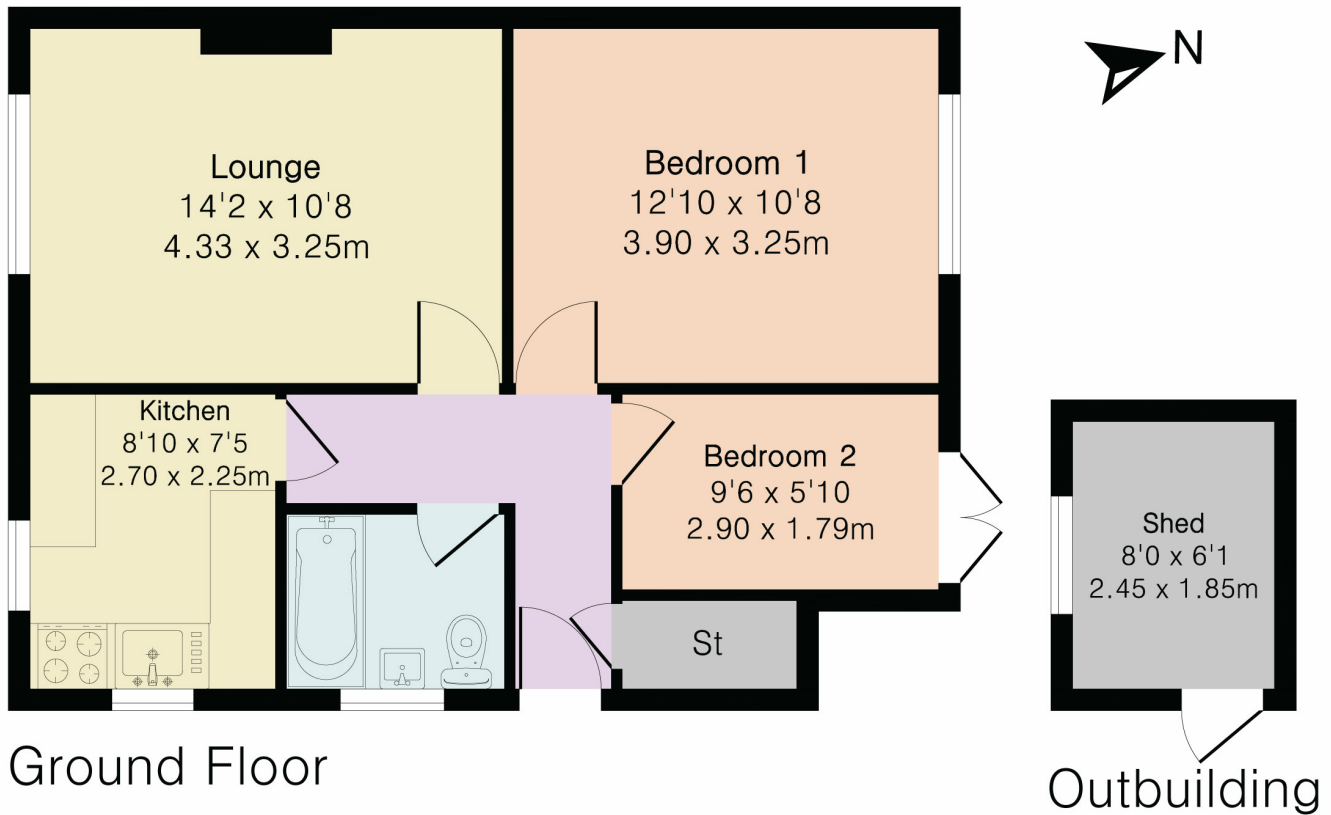

Although Pink Plan Ltd ensures the highest level of accuracy, measurements of doors, windows and rooms are approximate and no responsibility is taken for error, omission or misstatement. These plans are for representation purposes only as defined by RICS code of measuring practise. No guarantee is given on total square footage of the property within this plan. The figure icon is for initial guidance only and should not be relied on as a basis of valuation.

