

Silver Road

Street, BA16 0JS

COOPER
AND
TANNER



Asking Price Of
£90,000 Leasehold

🛏 1 🛋 1 🚿 1 EPC C

Description

We are delighted to bring to the market this lovely first floor retirement apartment in the heart of Street. A short distance from the town center, this is a very convenient location. With one bedroom including fitted wardrobe, a bathroom, kitchen and large open plan living/dining room, it would suit an individual or a couple. A small resident's garden has a seating area and washing line.

FIRST FLOOR
482 sq.ft. (44.8 sq.m.) approx.

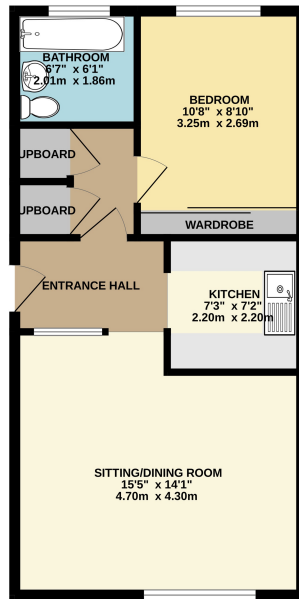

ONE BEDROOM RETIREMENT APARTMENT

TOTAL FLOOR AREA: 482 sq.ft. (44.8 sq.m.) approx.
While every attempt has been made to ensure the accuracy of the floorplan contained here, measurements of doors, windows, rooms and any other items are approximate and no responsibility is taken for any error, omission or misstatement. This plan is for illustrative purposes only and should be used as such by any prospective purchaser. The services, systems and appliances shown have not been tested and no guarantee as to their operability or efficiency can be given.
Made with Metrepa 01223



Features

- One bedroom retirement apartment
- Single storey living for the over 55's
- Central location close to shops and amenities
- Double glazing and electric heating throughout
- 999 year lease commenced in 1987
- Ground rent and service charge are currently approx. £1080 per annum



Local Information

- Council Tax Band A
- Tenure Leasehold
- EPC Rating C

STREET OFFICE

Telephone 01458 840416

86, High Street, Street, Somerset BA16 0EN

street@cooperandtanner.co.uk

**COOPER
AND
TANNER**

Important Notice: These particulars are set out as a general outline only for the guidance of intended purchasers and do not constitute, nor constitute part of, an offer or contract. All descriptions, dimensions, reference to condition and necessary permissions for use and occupation, warranties and other details are given without responsibility and any intending purchasers should not rely on the m as statements or representations of fact but must satisfy themselves by inspection or otherwise as to the correctness of each of them.

