



DERBYSHIRE



Flat 15 Meadow Court, Bridge Street, Belper, Derbyshire DE56 1HE
£185,000 - Leasehold



PROPERTY DESCRIPTION

Derbyshire Properties are pleased to present for sale this first floor over 60s two bedroom apartment. The property is presented to an extremely high standard with beautifully fitted kitchen and shower room.

Meadow Court is a highly sought after due to its central Belper location close to the doctors, Dentist and all the towns amenities. The property also offers substantial visitor parking and laundrette on site.

POINTS OF INTEREST

- Ground Floor Garden Apartment
- 2 Double Bedrooms
- Over 60s
- Beautiful Kitchen & Shower Room
- Pleasant Outlook & Views Of The Chevin
- Allocated Parking
- Highly Sought After
- Viewing Essential

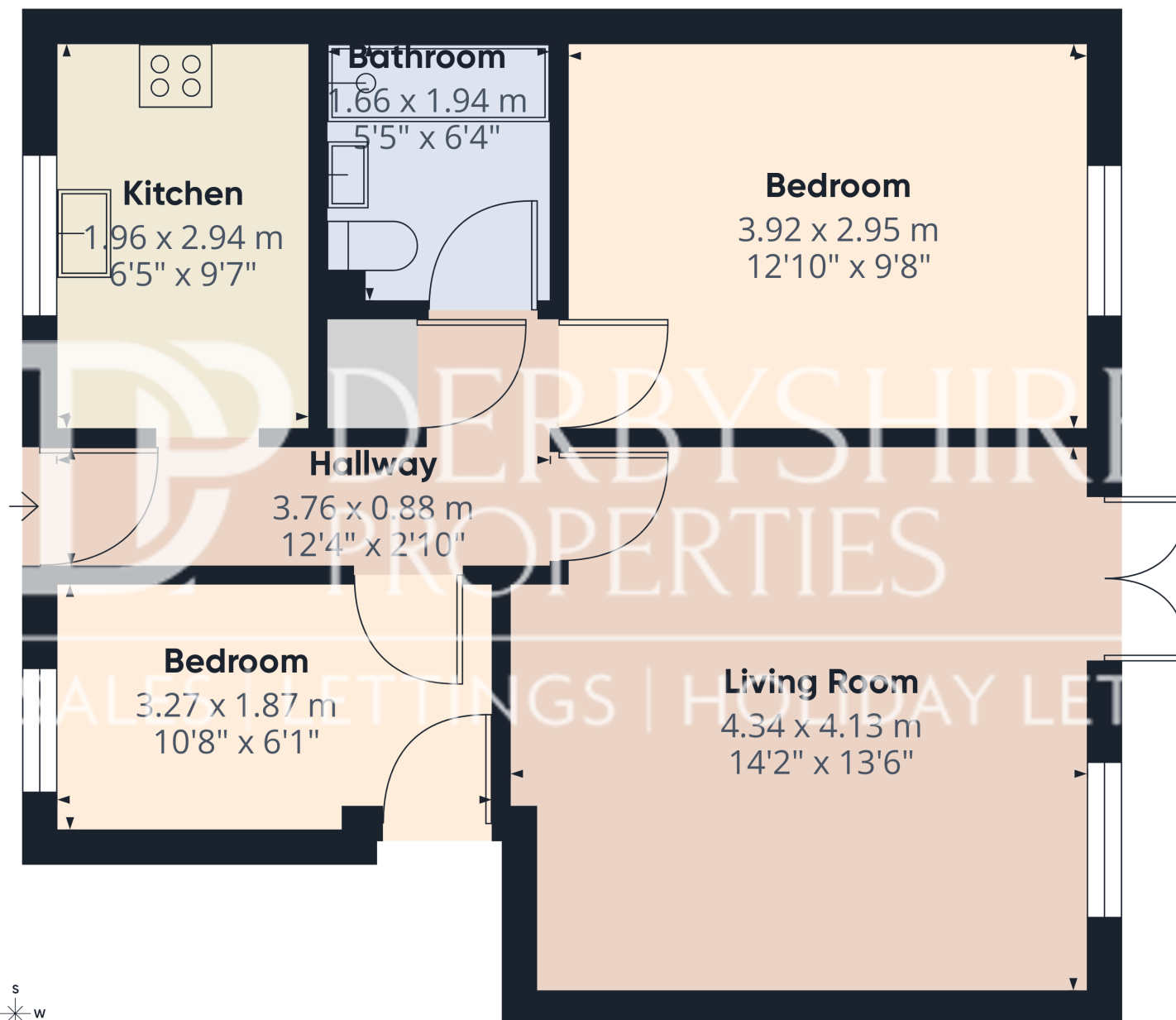

Approximate total area⁽¹⁾

49 m²
526 ft²

(1) Excluding balconies and terraces

Calculations reference the RICS IPMS 3C standard. Measurements are approximate and not to scale. This floor plan is intended for illustration only.

GIRAFFE360