



Wissen Drive, Letchworth Garden City, Hertfordshire, SG6 1FT

GUIDE PRICE £270,000

Lane & Bennetts are pleased to bring to the market this stylishly presented, first floor apartment in a sought after location, just 15 minutes from the town and station. A spacious hallway with generous storage greets you at the entrance to the apartment. The well proportioned apartment consists of two double bedrooms, both with built-in wardrobes and an en suite shower room to the master bedroom plus an additional bathroom. The dual aspect, open plan living area, complete with 'Juliet' balcony is decorated in an industrial 'loft apartment' style. The kitchen has been upgraded from the original design to increase the storage. There is an integrated electric cooker with extractor hood over and space and plumbing to house a fridge freezer.



95 Wissen Drive

Approximate Gross Internal Area
657 sq ft - 61 sq m

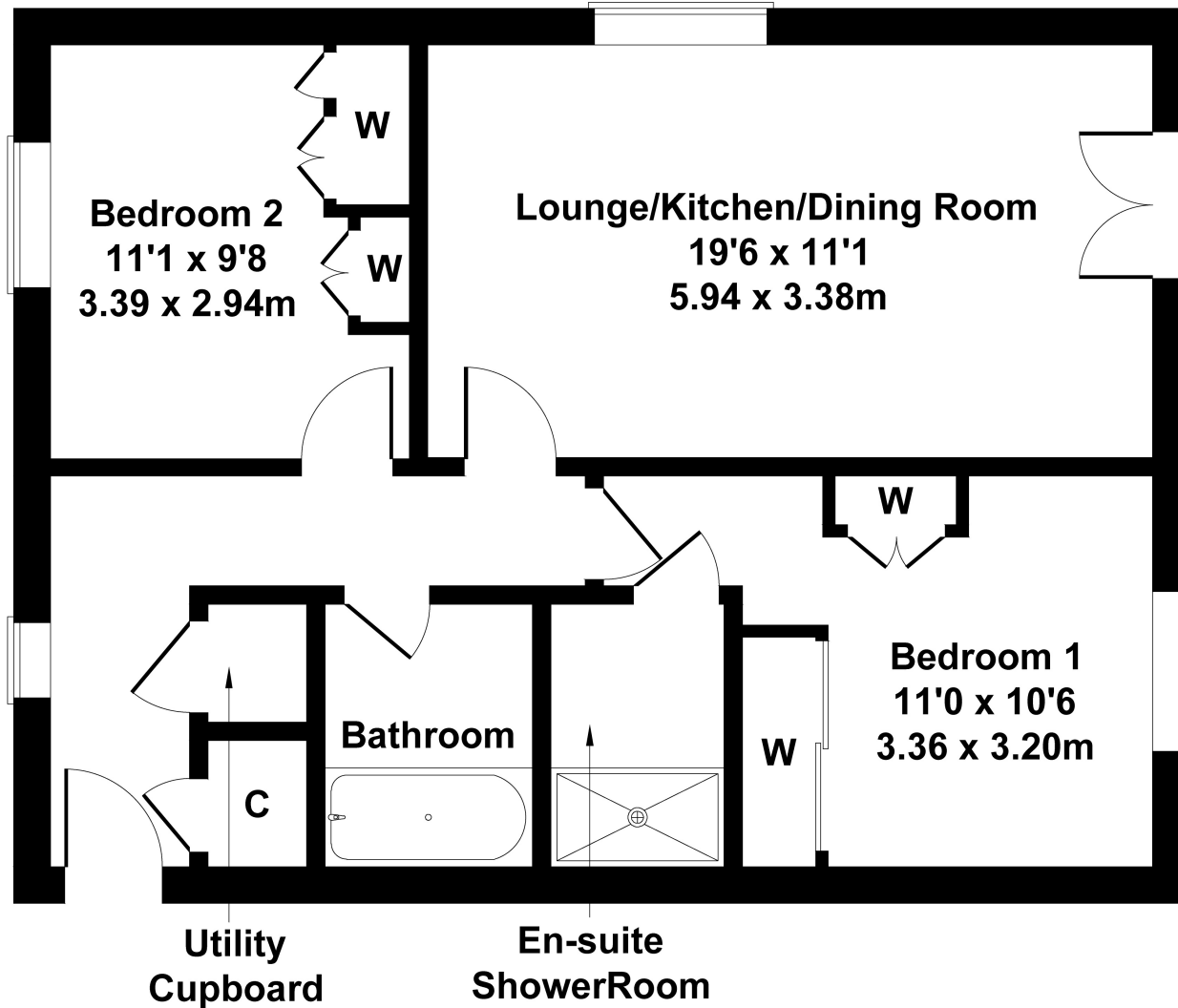

Not to Scale. Produced by The Plan Portal 2022
For Illustrative Purposes Only.

- TWO BEDROOM FIRST FLOOR APARTMENT
- STYLISHLY PRESENTED OPEN PLAN LIVING
- DELIGHTFUL JULIET BALCONY
- FIRST TIME BUYER / INVESTOR OPPORTUNITY
- LESS THAN 15 MINUTES TO TOWN & STATION
- EN SUITE TO MASTER BEDROOM
- INTEGRATED APPLIANCES
- ALLOCATED PARKING & SECURE BIKE STORAGE
- Tenure: Leasehold 108 years remaining | Council Tax Band: C | EPC: B

