



## Chalcot Gardens, Belsize Park, NW3

£3,300  
pcm



## Chalcot Gardens, Belsize Park, NW3

Located in the heart of Belsize Park and on a setback private road, is this hugely impressive two double bedroom, two bathroom apartment situated on the first floor with balcony.

This flat is offered unfurnished and further benefits from 724 sq Ft (67 Sq M) of internal space including a generous 22ft reception room with high ceilings, master bedroom with en-suite and a second double bedroom.

Chalcot Gardens is perfectly situated just yards away from the restaurants and local amenities found on England's Lane and with Belsize Park underground (Northern Line) situated just 0.4 miles away.

### Features

- Two Double Bedrooms
- Two Bathrooms
- Located In The Heart Of Belsize Park
- Private Road
- Balcony
- First Floor Apartment
- Just Yards Away From The Local Amenities On England's Lane
- Offered Unfurnished
- Available From 11th August 2023







Chalcot Gardens,  
Belsize Park, NW3

**Chalcot Gardens, NW3**

Approximate Area = 67.3 sq m / 724 sq ft  
Including Limited Use Area (0.2 sq m / 2 sq ft)

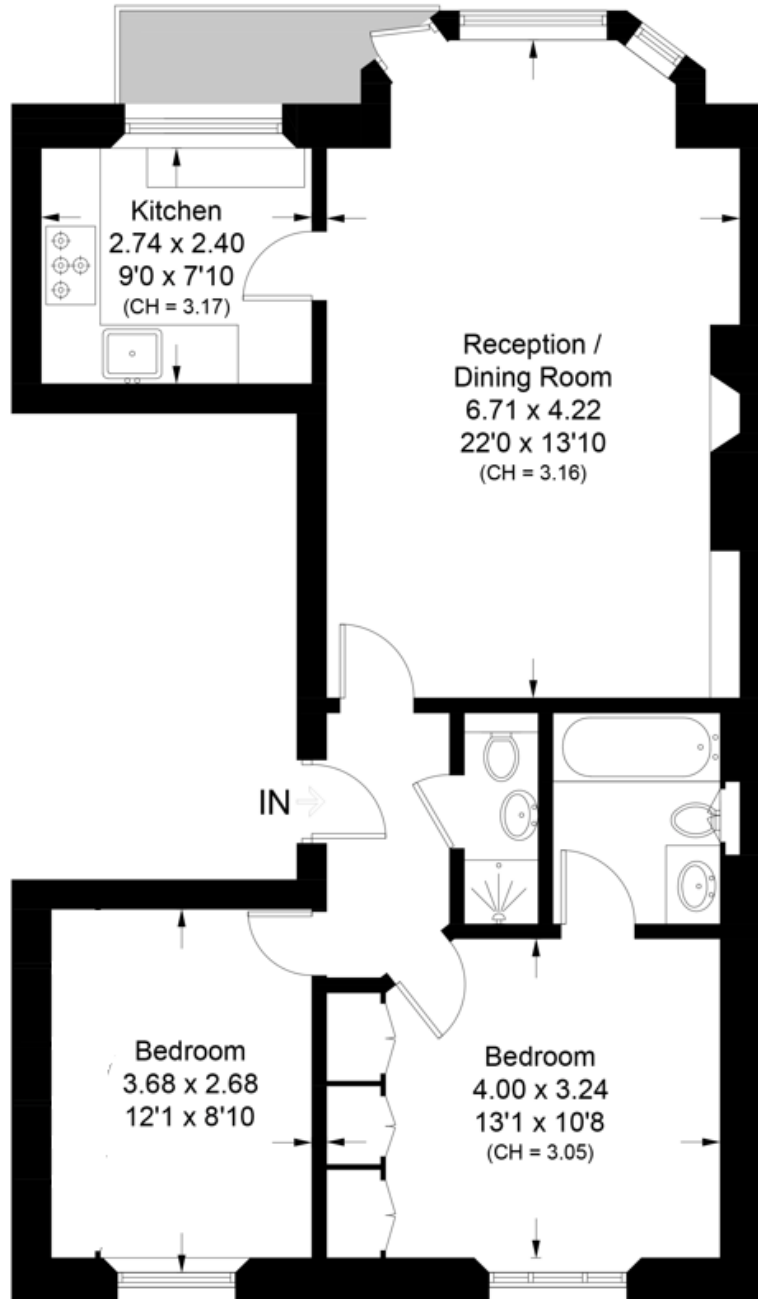

**First Floor**

Surveyed and drawn in accordance with the International property measurements standards (IPMS 2: Residential)  
Not drawn to scale unless stated. Whilst every care is taken in the preparation of this plan,  
please check all dimensions, shapes and compass bearings before making any decisions reliant upon them.