



Day & Co
ESTATE AGENTS

28 Cavendish Street
Keighley
BD21 3RG



20 Willow Tree Close, Long Lee,
Keighley, West Yorkshire, BD21
4RZ

£172,500

T: 01535 664609

W: www.dayandcoestateagents.co.uk

E: keighley@dayandcoestateagents.co.uk

- SEMI-DETACHED BUNGALOW
- GAS CENTRAL HEATING & DOUBLE GLAZING
- NO CHAIN

- TWO BEDROOMS
- GARDENS & GARAGE
- EPC RATING D

SUMMARY

** A WELL PRESENTED, NEWLY DECORATED TWO BEDROOM SEMI-DETACHED BUNGALOW, GAS CENTRAL HEATING (NEW BOILER 2023), DOUBLE GLAZING, GARDENS & GARAGE, POPULAR RESIDENTIAL LOCATION, NO CHAIN, EPC RATING D **

FULL DESCRIPTION

A well presented, newly decorated two bedroom semi-detached bungalow, situated in the popular residential location of Long Lee. The accommodation comprises of an entrance hallway, spacious lounge measures approximately 17ft in length with double glazed window to the front. The kitchen has a range of base and wall mounted units, sink, built in cupboard, double glazed windows to the front. There are two bedrooms to the rear, the second bedroom having double glazed patio doors and completing the accommodation is the shower room having a shower cubicle, WC, wash hand basin, double glazed window to the side. Gas central heating (New Boiler 2023) and double glazing. Externally the property has a drive leading to a garage, additional shed, gardens with patio and water feature. No Chain. EPC rating is D.

GROUND FLOOR

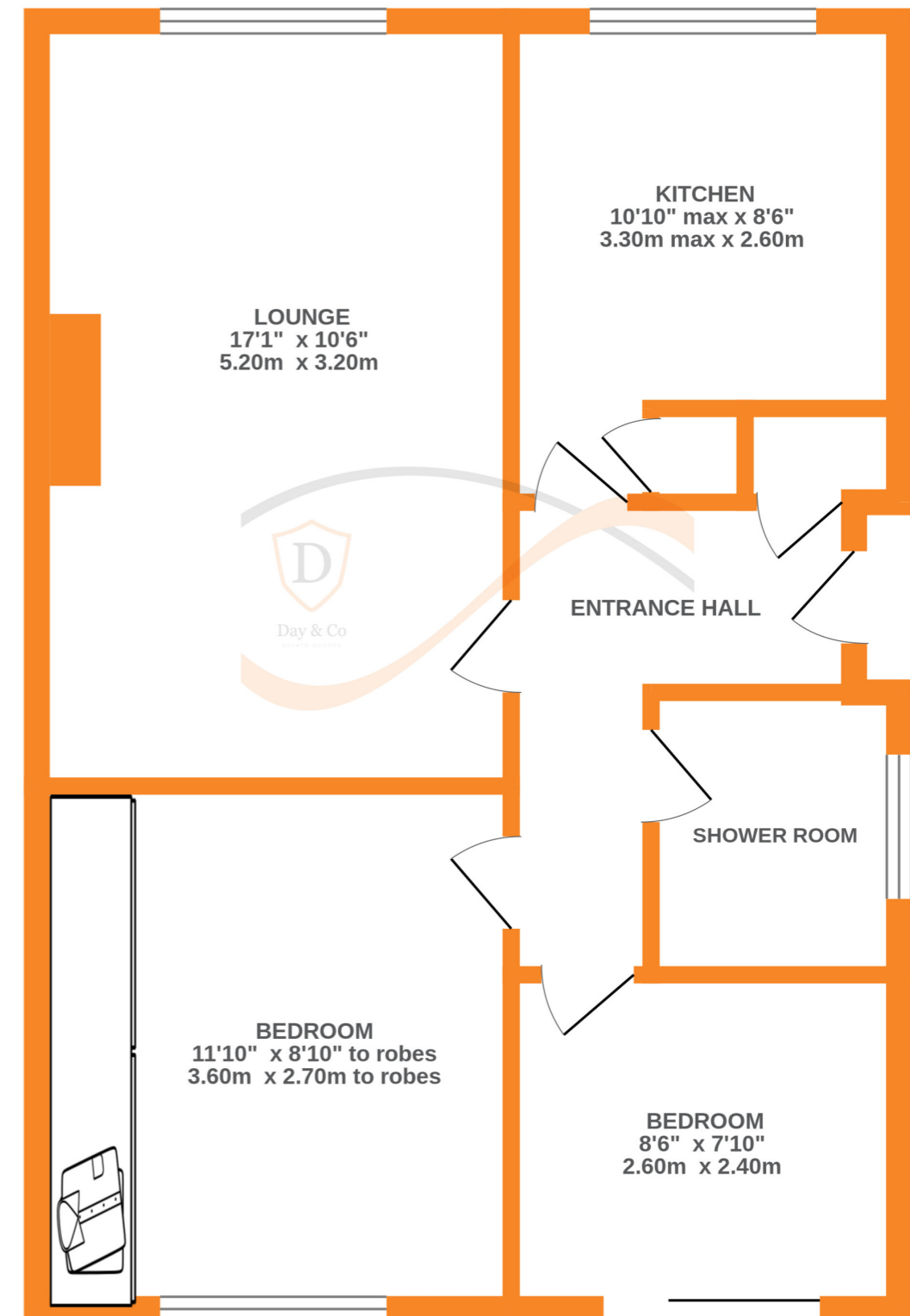

Whilst every attempt has been made to ensure the accuracy of the floorplan contained here, measurements of doors, windows, rooms and any other items are approximate and no responsibility is taken for any error, omission or mis-statement. This plan is for illustrative purposes only and should be used as such by any prospective purchaser. The services, systems and appliances shown have not been tested and no guarantee as to their operability or efficiency can be given.
Made with Metropix ©2024