





Ashview Gardens, Ashford, Surrey TW15 3RE
£699,950 - Freehold



PROPERTY DESCRIPTION

Gregory Brown are delighted to offer to the market for sale for the first time in many years, this unique detached property, situated within a popular and quiet location, just a short walk from Ashford High Street and Station. The size and scope of the gardens are truly astounding and must be viewed to be appreciated! The current owners have prepared the property beautifully for sale, with new carpets and décor throughout, it's ready to move straight in. The ample accommodation currently comprises of a large open-plan kitchen/dining room, and two further reception rooms, while upstairs boasts three bedrooms and a family bathroom. Further benefits include gas heating, double-glazing, off-street parking for several cars, and a detached garage. Offering significant potential to extend (STPP) while still retaining large and beautiful grounds, we feel that this house offers a once in a lifetime opportunity to the right buyer. Viewings strictly by appointment with the vendors sole agent.

POINTS OF INTEREST

- EXPANSIVE GARDENS
- WALKING DISTANCE TO HIGH STREET
- WALKING DISTANCE TO STATION
- NO ONWARD CHAIN
- DETACHED GARAGE
- POTENTIAL TO EXTEND (S.T.P.P.)





GROUND FLOOR
662 sq.ft. (61.5 sq.m.) approx.

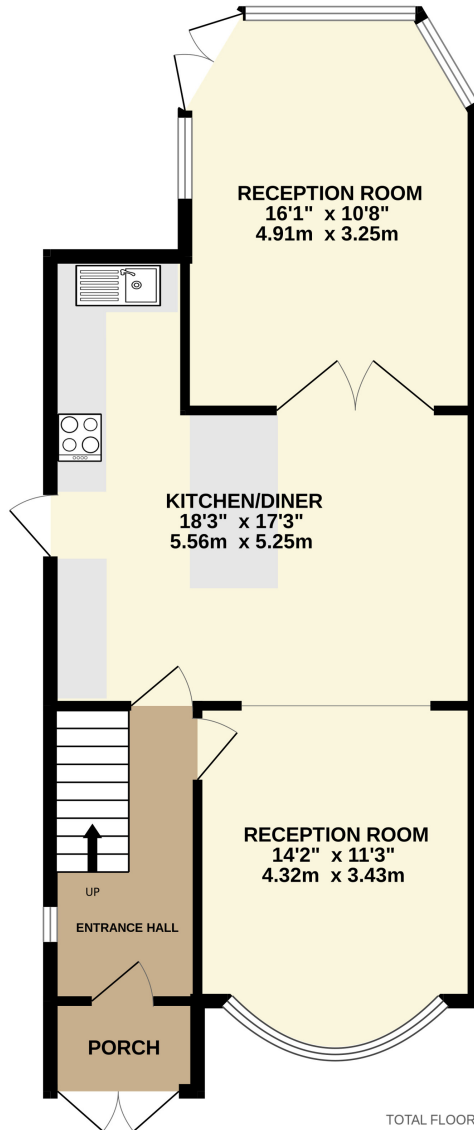

1ST FLOOR
459 sq.ft. (42.7 sq.m.) approx.

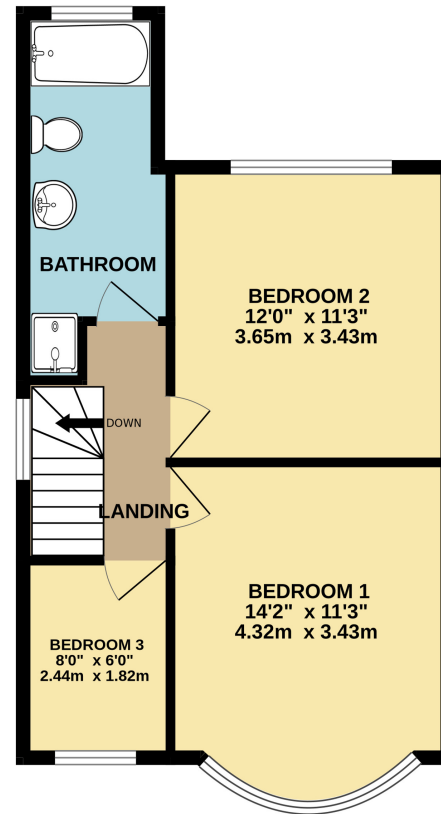

TOTAL FLOOR AREA : 1122 sq.ft. (104.2 sq.m.) approx.

Whilst every attempt has been made to ensure the accuracy of the floorplan contained here, measurements of doors, windows, rooms and any other items are approximate and no responsibility is taken for any error, omission or mis-statement. This plan is for illustrative purposes only and should be used as such by any prospective purchaser. The services, systems and appliances shown have not been tested and no guarantee as to their operability or efficiency can be given.

Made with Metropix ©2024