



Guide Price £250,000 Leasehold



Sidcup Hill, Sidcup, Kent DA14 6JD



PROPERTY DESCRIPTION

GUIDE PRICE • £250,000 - £260,000 • RE/MAX SELECT are delighted to offer for sale this unique and spacious one bedroom maisonette, close to Sidcup High Street's amenities and transportation links, including Sidcup station. This property comprises large double bedroom, living room, fitted kitchen, and bathroom. Further benefits include double glazing, gas central heating, and allocated parking.

Total Internal Area approx: 464.35 sq ft (43.28 sq m). CHAIN FREE.





ROOM DESCRIPTIONS

Ground Floor

Entrance Hallway

Wood-effect flooring, storage cupboard.

Living Room

3.84m x 3.62m (12' 7" x 11' 11") Wood-effect flooring, radiator, double glazed bay windows.

Kitchen

1.90m x 1.85m (6' 3" x 6' 1") Tiled flooring; range of wall and base units with complementary worktops; stainless steel sink with mixer tap; gas hob, built-in oven, stainless steel extractor hood; space and connections for washing machine; space and connections for fridge/freezer; double glazed windows.

Bedroom

3.84m x 3.21m (12' 7" x 10' 6") Wood flooring, radiator, double glazed bay windows.

Shower Room

Tiled flooring, part-tiled walls; walk-in shower enclosure with thermostatic shower over; wash-hand basin with mixer tap; w/c, radiator, double glazed windows.

External

Front Driveway

Off street parking; provision for visitor parking.

Information

- Lease: 89 years remaining
- Ground Rent: £100.00 per annum
- Council Tax: Band B

FLOORPLAN

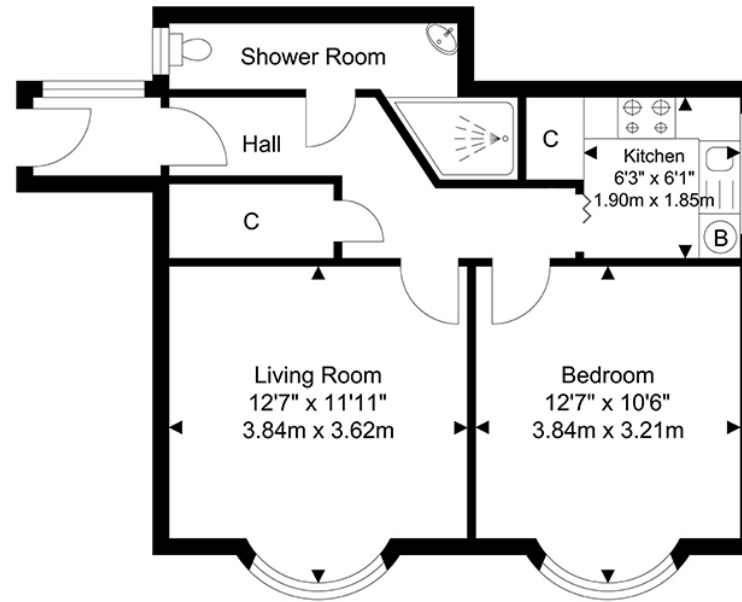

Ground Floor
Approximate Floor Area
464.35 SQ.FT.
(43.14 SQ.M.)

TOTAL APPROX FLOOR AREA 464.35 SQ. FT / 43.14 SQ. M
For Identification Purposes Only.

