

Approx Gross Internal Area  
80 sq m / 863 sq ft

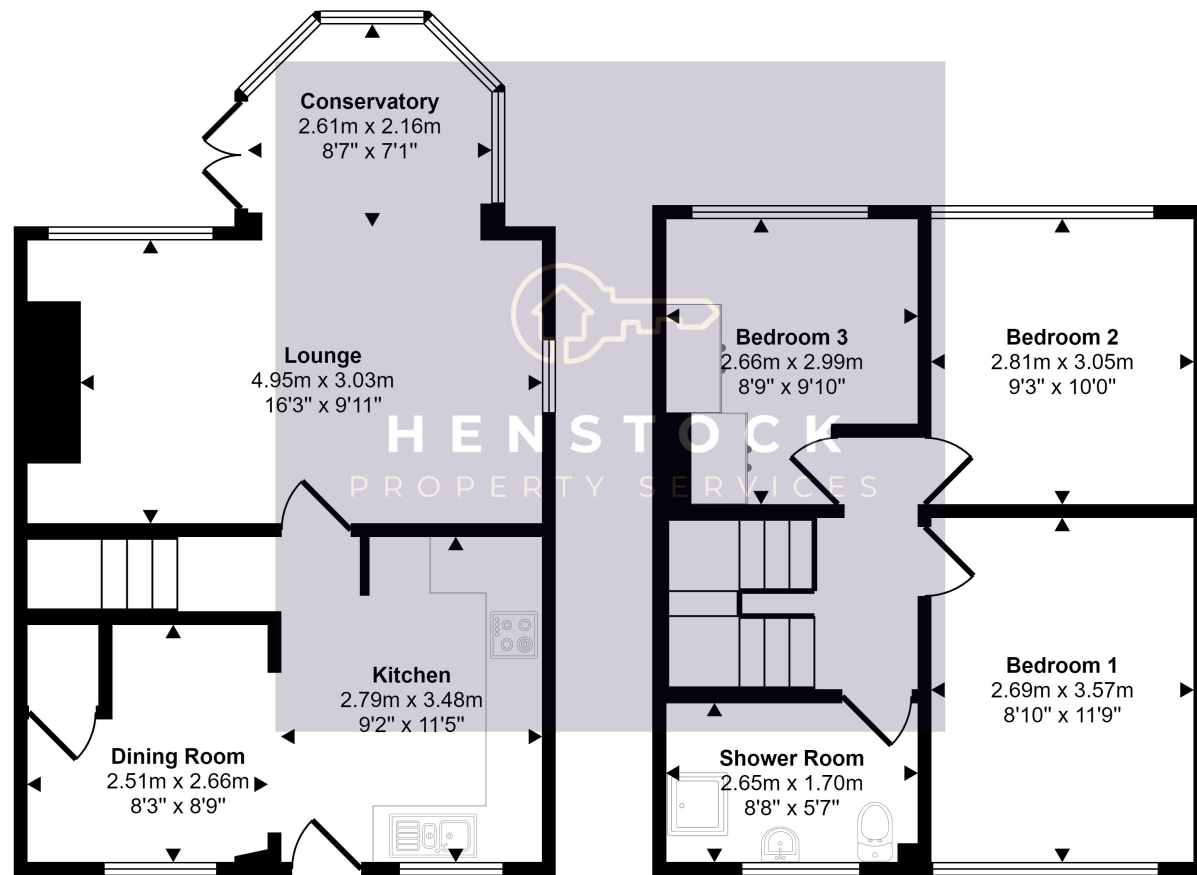

Ground Floor  
Approx 42 sq m / 456 sq ft

First Floor  
Approx 38 sq m / 407 sq ft

This floorplan is only for illustrative purposes and is not to scale. Measurements of rooms, doors, windows, and any items are approximate and no responsibility is taken for any error, omission or mis-statement. Icons of items such as bathroom suites are representations only and may not look like the real items. Made with Made Snappy 360.



**HENSTOCK**  
PROPERTY SERVICES



## 18 Schoolside Lane, Middleton, Manchester, Lancashire M24 4PD

- 3 BEDROOMS
- RECENTLY FITTED BATHROOM & KITCHEN / DINER
- RECENTLY FITTED BOILER
- ATTACHED GARAGE
- REAR GARDEN
- CONSERVATORY
- OFF ROAD PARKING TO FRONT

**£205,000**





PROPERTY DESCRIPTION

Henstock Property Services are pleased to market this well presented 3 bedroomed end terraced family home. The living accommodation briefly comprises; modern fitted kitchen with separate dining area, integral garage / store room, large rear lounge with conservatory, 3 bedrooms and a bathroom. The property also has the benefit of gas central heating, uPVC double glazed windows, raised garden to rear. This property has been extensively upgraded with a new kitchen, bathroom and media wall installed. Some of the rooms are left unpainted, providing a good opportunity for a buyer to put their own stamp on the property without having to do any major works. The property also benefits from a recently fitted boiler. Ideally situated in this popular residential area within easy reach of schools, shops/supermarkets, leisure/fitness facilities, good public transport services and a short distance from the M60 & M62 motorway links.

Entrance

Kitchen

2.79m x 3.48m (9' 2" x 11' 5")

Lounge

4.95m x 3.03m (16' 3" x 9' 11")

Conservatory

2.61m x 2.16m (8' 7" x 7' 1")

Upper Floor

Bedroom 1

2.69m x 3.57m (8' 10" x 11' 9")

Bedroom 2

2.81m x 3.05m (9' 3" x 10' 0")

Bedroom 3

2.66m x 2.99m (8' 9" x 9' 10")

Shower Room

2.65m x 1.70m (8' 8" x 5' 7")

