



EDWARD KNIGHT
ESTATE AGENTS



14 Canons Walk, Northampton NN2 8HR
£240,000 - Freehold



PROPERTY DESCRIPTION

Edward Knight Estate Agents are pleased to bring to the market this two bedroom semi-detached bungalow situated in this popular suburb of Kingsthorpe. This bungalow offers great space throughout. The accommodation briefly comprises: Entrance hall, spacious lounge/diner, kitchen, two double bedrooms, conservatory and shower room. Externally to the front is a block paved driveway leading to the a single garage. To the rear is a low maintenance garden with a pond. No upwards chain.

POINTS OF INTEREST

- Semi Detached Bungalow
- Two Bedrooms
- Conservatory
- Low Maintenance Rear Garden
- Garage and Driveway
- Double Glazing & Gas Radiator Heating Throughout
- Close to Amenities
- Popular Location of Kingsthorpe
- Council Tax Band - B

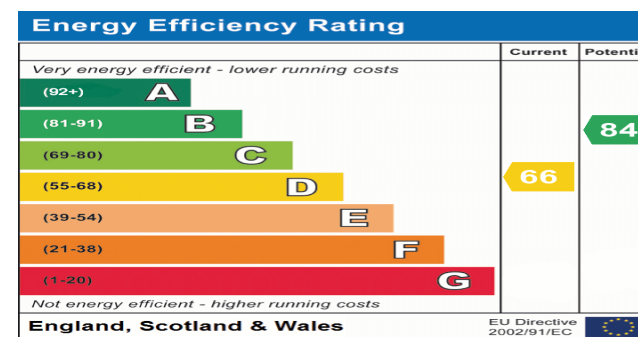

GROUND FLOOR
713 sq.ft. (66.2 sq.m.) approx.

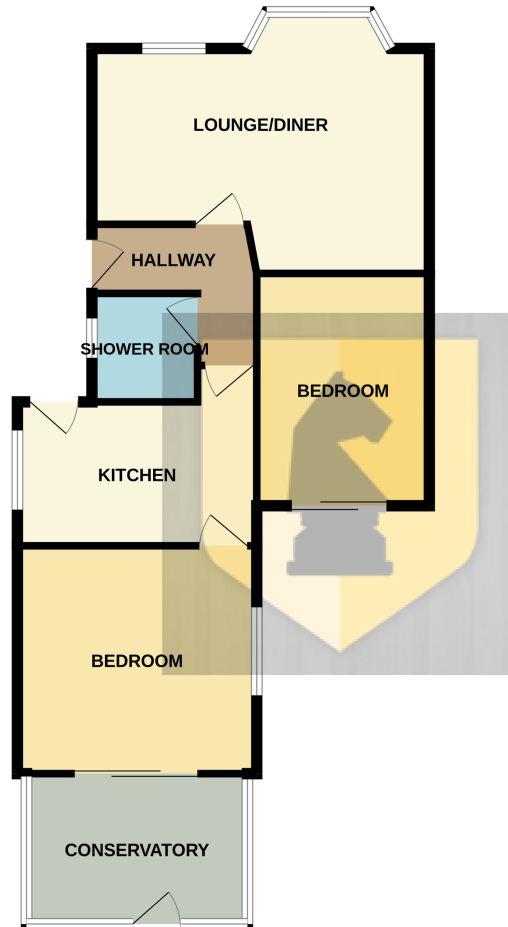

TOTAL FLOOR AREA: 713 sq.ft. (66.2 sq.m.) approx.

Whilst every attempt has been made to ensure the accuracy of the floorplan contained here, measurements of doors, windows, rooms and any other items are approximate and no responsibility is taken for any error, omission or mis-statement. This plan is for illustrative purposes only and should be used as such by any prospective purchaser. The services, systems and appliances shown have not been tested and no guarantee as to their operability or efficiency can be given.
Made with Metropix ©2024