

FOR SALE

Apartment 5 Aspects, 1 Wyndham
Road, Poole, Dorset BH14 8TY



PHILIPPA SOLE



£475,000

Stunning first floor apartment

Two double bedrooms

Ensuite to main bedroom and family bathroom

Modern kitchen/breakfast room

Two balconies

Close to Ashley Cross Village

Railway links

Share of freehold

Band D - £1,948.24

Maintenance £2,000 pa

Share of Freehold

[Click here for virtual tour](#)

About this property

A beautifully presented, bright and contemporary, two double bedroom, first floor flat approaching 1,000 sq.ft of accommodation and occupying an enviable position in this exclusive award winning development of just 8 apartments, located under 500 meters from Ashley Cross. Designed for modern and contemporary living featuring curved walls and windows, two balconies, ensuite to master and two allocated parking spaces.

An inviting hallway leads you to the impressive living dining room with a feature circular bay window and access on to the west facing balcony. The contemporary kitchen has been well designed and boasts a range of integrated appliances complimented with granite worktop, breakfast bar and table. The balcony enjoys the morning sunshine and is an ideal place for breakfast and a coffee. The sizeable main bedroom enjoys a fully tiled and luxuriously appointed en-suite shower room and a built-in double wardrobe. The second double bedroom also benefits from fitted wardrobes and has use of the large family bathroom. Outside the development is set within beautifully established and well-tended communal grounds. The apartment is also conveyed with 2 allocated parking spaces.

Location

The property is located in an exclusive private cul-de-sac. Ashley Cross is approximately 480 metres (0.2 miles) away and within a few minutes' walk of the train station at Parkstone, giving direct access into London Waterloo in under two hours. Ashley Cross itself is centred around the green with an array of coffee shops, bars and restaurants.





Approximate Gross Internal Area = 92.3 sq m / 993 sq ft

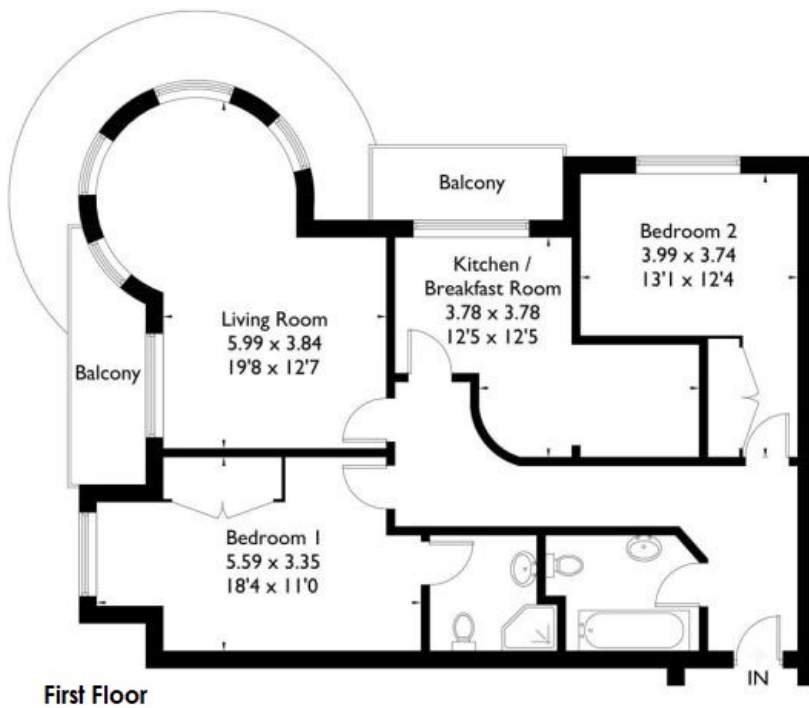

Measurements are approximate and should not be relied upon. The floor plan is for illustrative purposes only and Philippa Sole take no responsibility for their accuracy.

PHILIPPA SOLE

enquiries@philippasole.co.uk — www.philippasole.co.uk — 01202 747999