



6 Winston Drive, Bexhill-on-Sea, East Sussex,  
TN39 3RP

£579,950



- Immaculate Three Bedroom Bungalow
- Spacious Dual Aspect Lounge-Diner
- South Facing UPVC Conservatory
- Modern Fitted Kitchen & Bathroom
- Ground Floor Master Bed With En-Suite
- Open Plan First Floor Study Area
- First Floor Guest Bed With En-suite
- Neutral Colour Scheme Throughout
- Integral Single Garage With Remote Door
- Secure UPVC Entrance Porch
- Block Paved Drive & Ample Parking
- Lovely South Facing Rear Garden
- Immaculate Decoration Throughout
- Central Heated & Fully Double Glazed
- Highly Sought After & Quiet Location





GROUND FLOOR

1ST FLOOR

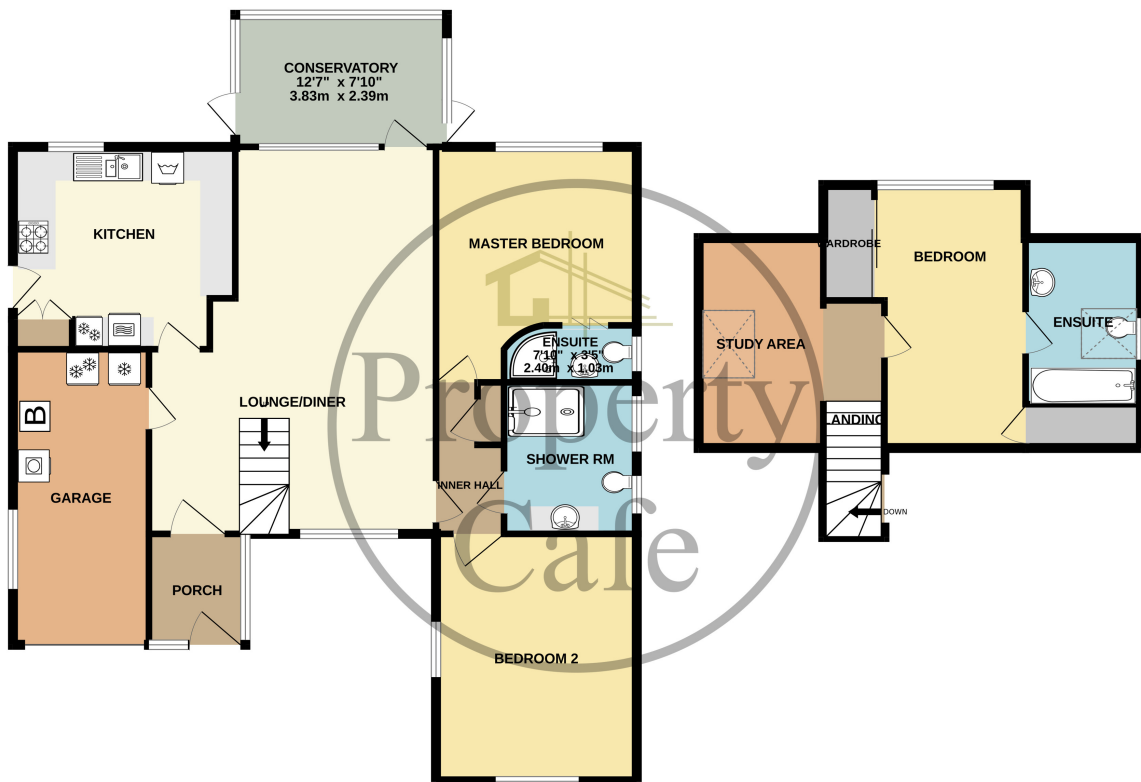

Whilst every attempt has been made to ensure the accuracy of the floorplan contained here, measurements of doors, windows, rooms and any other items are approximate and no responsibility is taken for any error, omission or mis-statement. This plan is for illustrative purposes only and should be used as such by any prospective purchaser. The services, systems and appliances shown have not been tested and no guarantee as to their operability or efficiency can be given.  
 Made with MetroPix ©2024