



25 Church Street, Langford, Bedfordshire, SG18 9QT

£375,000

Three bedroom semi-detached property situated on a good sized plot backing onto paddocks. Offered with good sized lounge with log burner, kitchen/diner with casement doors to rear, useful utility room and a shower room plus three spacious bedrooms. Off road parking is provided by a gravelled driveway and to the rear is a mature rear garden with barn/store.





## 25 Church Street Langford SG18 9QT

Approximate Gross Internal Area  
1033 sq ft - 96 sq m

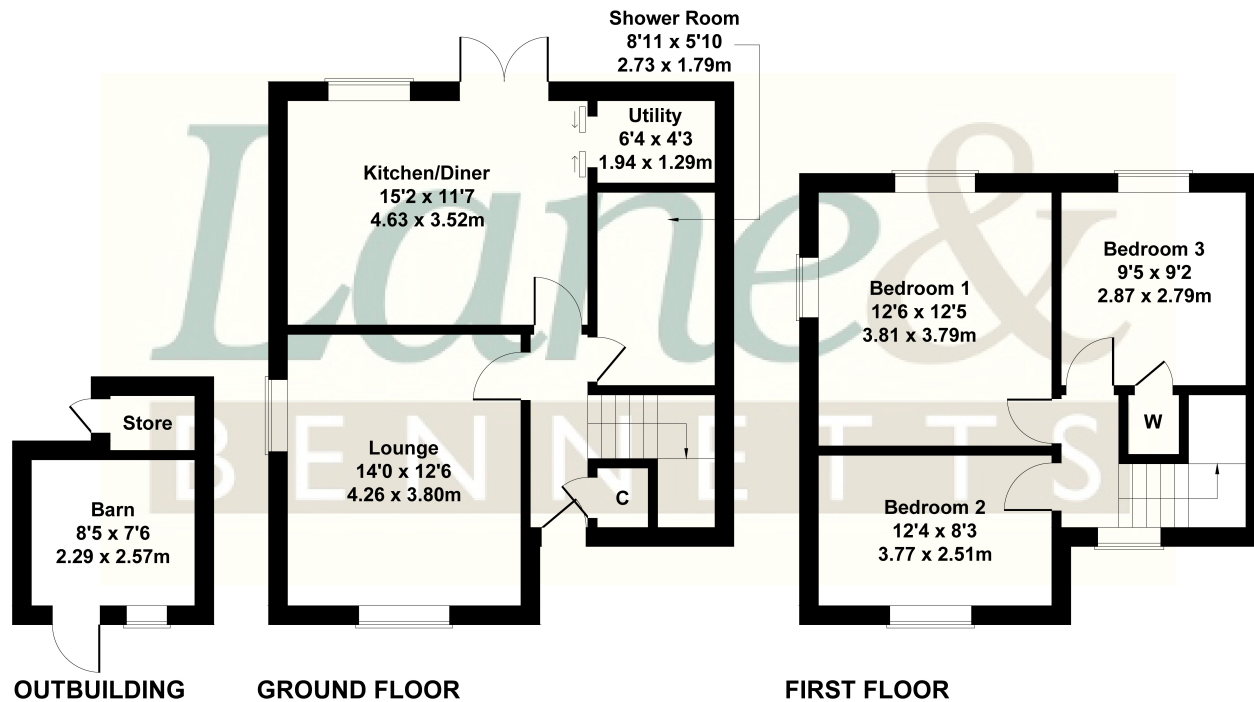

Not to Scale. Produced by The Plan Portal 2024  
For Illustrative Purposes Only.

- THREE BEDROOM SEMI-DETACHED
- LOUNGE WITH LOG BURNER
- OAK FLOORING TO HALL + LOUNGE + WOODPECKER LVT FLOORING TO KITCHEN
- KITCHEN/DINER + UTILITY ROOM
- THREE GOOD SIZE BEDROOMS
- OFF ROAD PARKING
- GOOD SIZED GARDEN
- BARN/STORE
- BACKS ONTO PADDOCKS

