



4 Millmount Court, Groves Lane, Douglas, Isle of Man. IM2 1HW

4 Millmount Court is a modern 2022-built semi-detached, modern home featuring a bright lounge, stylish kitchen/diner, three bedrooms, and two bathrooms including a master en-suite. It offers a private rear garden and two off-road parking spaces in a convenient Douglas location.



OPEN HOUSE
THIS SATURDAY 12 – 2 PM
NO APPOINTMENT NECESSARY

619966
manxmove.im



£375,000 Freehold

PROPERTY DESCRIPTION

ACCOMODATION: 4 Millmount Court is a stylish semi-detached home, built in 2022 and located on Groves Lane in Douglas. Designed with modern living in mind, the property features a bright, contemporary lounge and an elegant, well-appointed kitchen with space for a four-seater dining table — ideal for both everyday living and entertaining. A convenient downstairs W.C. adds to the practical layout of the ground floor.

Upstairs, the home offers three well-proportioned bedrooms, including a spacious master with a sleek en-suite shower room. A modern family bathroom serves the additional bedrooms. Outside, the enclosed rear garden provides a private space to relax or enjoy the outdoors, while the front of the property benefits from two off-road parking spaces. This home combines modern design with everyday convenience, perfect for families or professionals.

INCLUSIONS: Light Fittings, Floor Coverings, Blinds.

FEATURES

- OPEN HOUSE SATURDAY 12th APRIL @ 12pm - 2pm
- Semi-Detached Home in a Great Location
- Three Bedrooms with Family Bathroom
- Additional En-suite and W.C.
- Modern Lounge
- Elegant Fitted Kitchen/Diner
- Private Back Garden
- Fibre Internet Installed



Property Images



FLOORPLAN

GROUND FLOOR
438 sq.ft. (40.7 sq.m.) approx.

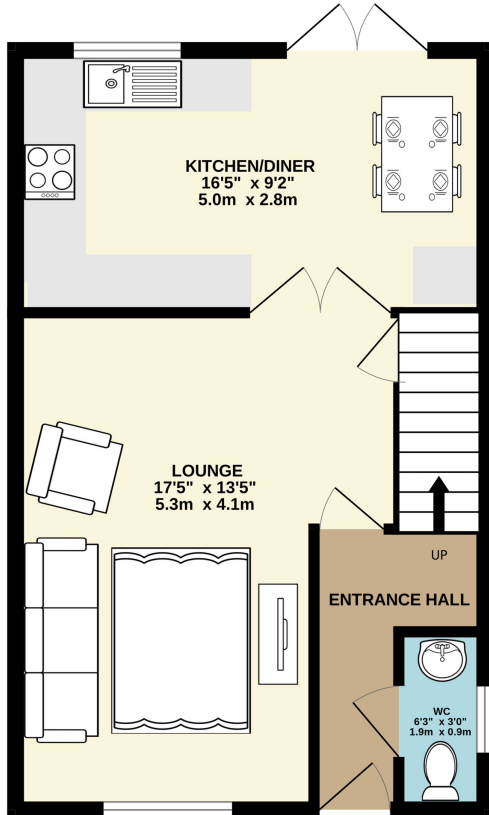

1ST FLOOR
438 sq.ft. (40.7 sq.m.) approx.

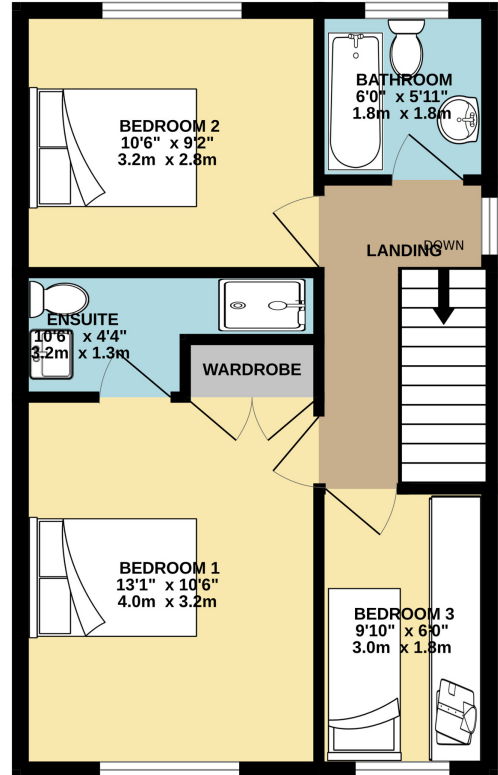

TOTAL FLOOR AREA : 876 sq.ft. (81.4 sq.m.) approx.

Whilst every attempt has been made to ensure the accuracy of the floorplan contained here, measurements of doors, windows, rooms and any other items are approximate and no responsibility is taken for any error, omission or mis-statement. This plan is for illustrative purposes only and should be used as such by any prospective purchaser. The services, systems and appliances shown have not been tested and no guarantee as to their operability or efficiency can be given.
Made with Metropix ©2025

DISCLAIMER: Whilst Manxmove Ltd believe that these details are correct, neither Manxmove Ltd or their clients guarantee their accuracy in any way. Consequently, these details are not to be used to form part of any legally binding contract. Prospective purchasers or tenants are advised to visit this property to satisfy themselves as to the correctness of these details. Please note, we use wide angle camera lenses in order to show as much of each room as possible. This is not intended to mislead any prospective purchasers or tenants in any way and an honest verbal description is always available prior to viewing if required.