

FOR  
SALE



Overdine Rowden Lane, Bredenbury, Bromyard HR7 4TF

£495,000 - Freehold

37, High Street, Bromyard, HR7 4AE 01885 488166 [bromyard@flintandcook.co.uk](mailto:bromyard@flintandcook.co.uk)



## PROPERTY SUMMARY

Situated 3 miles West of Bromyard in the village of Bredenbury, a delightful four bedroom detached house offering ideal family/retirement accommodation and being sold with the added benefit of no onward chain. This four bedroom property, features off road parking, an enclosed rear garden, fantastic countryside views, a modern farmhouse style kitchen, two shower rooms and a utility. Additionally, the property benefits from underfloor pipework installed for a central heating system, with a header tank located in the attic—currently unused but offering potential for future activation, along with hot and cold water pipework that has been run to the bedrooms, also presently unused. An internal inspection is highly recommended.

Within the village of Bredenbury, there is a church, primary school, village hall and wonderful countryside walks. Bromyard sits 3 miles away with a range of amenities and the market town of Leominster is approximately 8 miles providing a further range of amenities.

## POINTS OF INTEREST

- *Four bedrooms, 2 shower rooms*
- *No onward chain!*
- *Rural location*
- *Ideal family / retirement accommodation*
- *Must be viewed!*
- *Outstanding Countryside views*



## ROOM DESCRIPTIONS

### Ground floor

With wooden stable door leading into

### Entrance hall area

With quarry tiled floor, two ceiling light points, ample space for coats and shoes, freestanding fridge/freezer opening into the kitchen area and with door in to the

### Lounge/dining room

With fitted carpet, dual aspect double glazed windows with a view across the garden. Two electric night storage heaters, a feature wood burning stove with exposed brickwork, tiled hearth and wooden mantle over, exposed character beams, door leading into the traditional entrance hall and another door into the

### Utility room

With quarry tiled floor, washing machine, night storage heater, double glazed window, wall mounted fuse boxes and door into

### Downstairs shower room

With fitted corner shower cubicle, tiled surround and glass sliding doors, pedestal wash hand basin with tiled splash back, low flush WC, tiled floor and double glazed window.

### Traditional entrance hall

With quarry tiled floor, stairs leading up, night storage heater, ceiling light points, useful under stair storage cupboard, door into the conservatory and door leading back into the kitchen.

### Kitchen/breakfast room

Fitted with a modern farmhouse style kitchen with matching wall and base units, ample wooden work surfaces, stainless steel sink and drainer, integrated dishwasher and free standing cooker, microwave, double glazed window, feature exposed beam, quarry tiled floor, a feature multi fuel wood burning stove with an attractive exposed brick surround and opening into the

### Conservatory

With wood effect flooring, power points, double glazed windows and French doors out to the rear garden and single door leading to the stoned patio area.

### First floor landing

With exposed wooden floorboards, double glazed window, ceiling light point, loft hatch with pull down ladder and light, doors to

### Bedroom 1

A good sized double bedroom with exposed floorboards, ceiling light point, night storage heater, double glazed window.

### Bedroom 2

A generously sized double bedroom with exposed floorboards, ceiling light point, night storage heater, double glazed window with views across towards the Malvern Hills.

### Bedroom 3

With exposed floorboards, ceiling light point, night storage heater and double glazed window with views towards open countryside.

### Bedroom 4

With exposed floorboards, ceiling light point, night storage heater and double glazed window.

### Shower room

A fitted shower cubicle with electric shower over and glass sliding door, low flush WC, pedestal wash hand basin, exposed wooden floorboards and double glazed window.

### Outside

Approached through a 5 bar wooden gate, this property welcomes you via a stone laid driveway, offering generous off road parking for several vehicles with a full sized street light at the entrance to the yard. The grounds feature a thoughtfully designed outdoor area including a timber frame storage shed, wood store and a wooden storage shed. The yard opens out onto a patio area with beautiful views across the countryside and mature garden. The garden itself is fruitful, with Victoria plum, damson, cherry, two apple trees and three gooseberry bushes. Further into the garden stands a summerhouse with decking, ideal for relaxing or entertaining in the warmer months. The entire outdoor space is securely enclosed by mature hedging, with a pedestrian gate providing convenient access to the rear garden. There are also useful outside power points, outdoor tap and the flood lights to the yard and lawn.

### Services

Mains water and electricity are connected. Private drainage system.

### Directions

From Bromyard, proceed on the A44 towards Leominster, after 3 miles take the right hand turning signposted for Edwyn Ralph and proceed for approximately 0.7 miles and the property is situated on the right hand side.

### Outgoings

Council tax band E - £2993 for 2025/2026

Water rates are payable.

### Viewings

Strictly by appointment through the Agent, Flint & Cook, Bromyard (01885) 488166.

Opening Hours

Monday - Friday 9.00 am - 5.30 pm

Saturday 9.00 am - 1.00 pm

### Money Laundering Regulations

Prospective purchasers will be asked to produce identification, address verification and proof of funds at the time of making an offer.

## Ground Floor

Approx. 66.0 sq. metres (710.2 sq. feet)

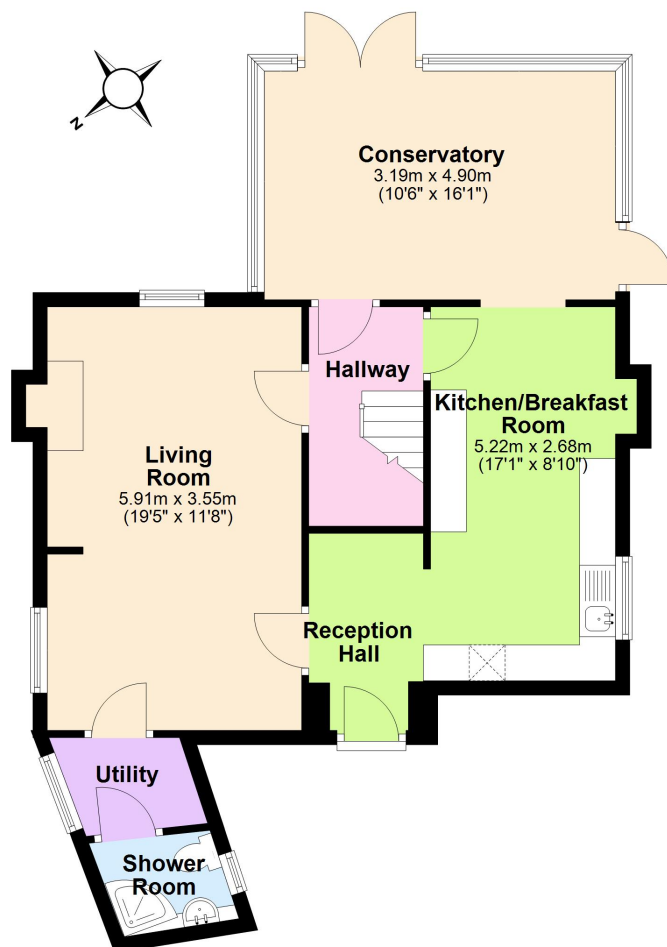

## First Floor

Approx. 45.0 sq. metres (484.5 sq. feet)

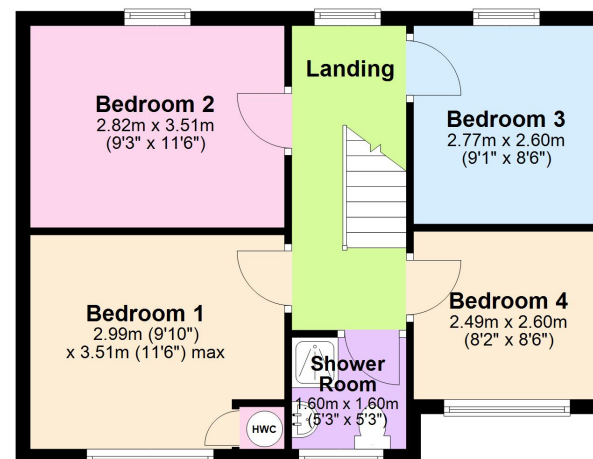

Total area: approx. 111.0 sq. metres (1194.7 sq. feet)

**Overdene, Bredenbury, Bromyard**

These particulars are prepared for the guidance only of prospective purchasers. They are intended to give a fair and overall description of the property and do not constitute the whole or any part of an offer or contract. Any information contained herein (whether in text, plans or photographs) is given in good faith but should not be relied upon as being a statement or representation of fact. Any plans provided by the agents and/or with the sales particulars are intended for guidance purposes only; we cannot guarantee the accuracy and scale of any plans, and they do not form any part of the sales contract. Nothing in these particulars shall be deemed to be a statement that the property is in good condition or otherwise nor that any services or facilities are in good working order. Any movable contents, fixtures and fittings, (whether wired or not) referred to in these property particulars (including any shown in the photographs) are, unless the particulars say otherwise, excluded from the sale. In the event that the buyer proposes to purchase any movable contents or include them in any offer for the property, the buyer cannot in any respect imply any such inclusion from the property particulars. Any areas, measurements or distances referred to herein are approximate only and may be subject to amendment. It should not be assumed that the property has all necessary planning, building regulation or other consents and these matters must be verified by an intending purchaser. The information in these particulars is given without responsibility on the part of the agents or their clients and neither the agents nor their employees have any authority to make or give any representations or warranties whatever in relation to this property.

**Flint & Cook Privacy Statement:** We take your privacy very seriously. Your data will not be shared with any other parties without your express permission. Our Data protection Policy can be read in full on the Flint & Cook website, [www.flintandcook.co.uk](http://www.flintandcook.co.uk)