

Set on a 0.205 acre plot within an exclusive enclave in the heart of Beaconsfield Old Town, Stable House is a beautifully converted Grade II listed barn, originally built in 1998, offering an exceptional blend of historic character and contemporary comfort.

Showcasing striking exposed oak beams, elegant stone and wooden flooring, and an abundance of natural light, this unique home provides versatile living space designed for modern family life. On the ground floor there is plenty of warmth, space, and versatility. The impressive sitting room forms the heart of the home, featuring rich wooden floors, dramatic oak beams, and a charming reading nook. A characterful stone fireplace with an open fire creates a cosy focal point, while bi-fold doors and skylights flood the space with light and open seamlessly onto the patio—perfect for indoor-outdoor living. The spacious kitchen/breakfast/family room is thoughtfully designed for both everyday living and entertaining. It boasts a large central island with breakfast bar, granite worktops, and a full suite of high-spec integrated Miele appliances, including oven, microwave, gas hob, dishwasher, and ample refrigeration with a large fridge and freezer. Recessed spotlighting and stone floors add a sleek finish, while bi-fold doors lead directly to a patio ideal for BBQs and social gatherings. A separate utility room provides further practicality with excellent waste disposal solutions. A particularly attractive feature is the ground floor principal bedroom suite, offering privacy and flexibility. This beautiful room includes a skylight, built-in storage, neutral décor, and views over the courtyard. The en-suite bathroom is beautifully appointed with Mediterranean-style tiles, a bath, and a walk-in shower.



Property Information

-  SECLUDED FOUR BEDROOM PROPERTY ADJACENT BEACONSFIELD OLD TOWN
-  STUNNING EXPOSED OAK BEAMS
-  INTEGRATED KITCHEN WITH MIELE APPLIANCES
-  GRADE TWO LISTED PROPERTY
-  EPC - D
-  NO ONWARD CHAIN
-  QUIET LOCATION
-  EASY ACCESS FOR M4/M25 NETWORKS
-  PRIVATE ROAD AND PARKING FOR THREE VEHICLES
-  COUNCIL TAX BAND - G

					
x4	x4	x3	x3	Y	Y
Bedrooms	Reception Rooms	Bathrooms	Parking Spaces	Garden	Garage

Floor Plan

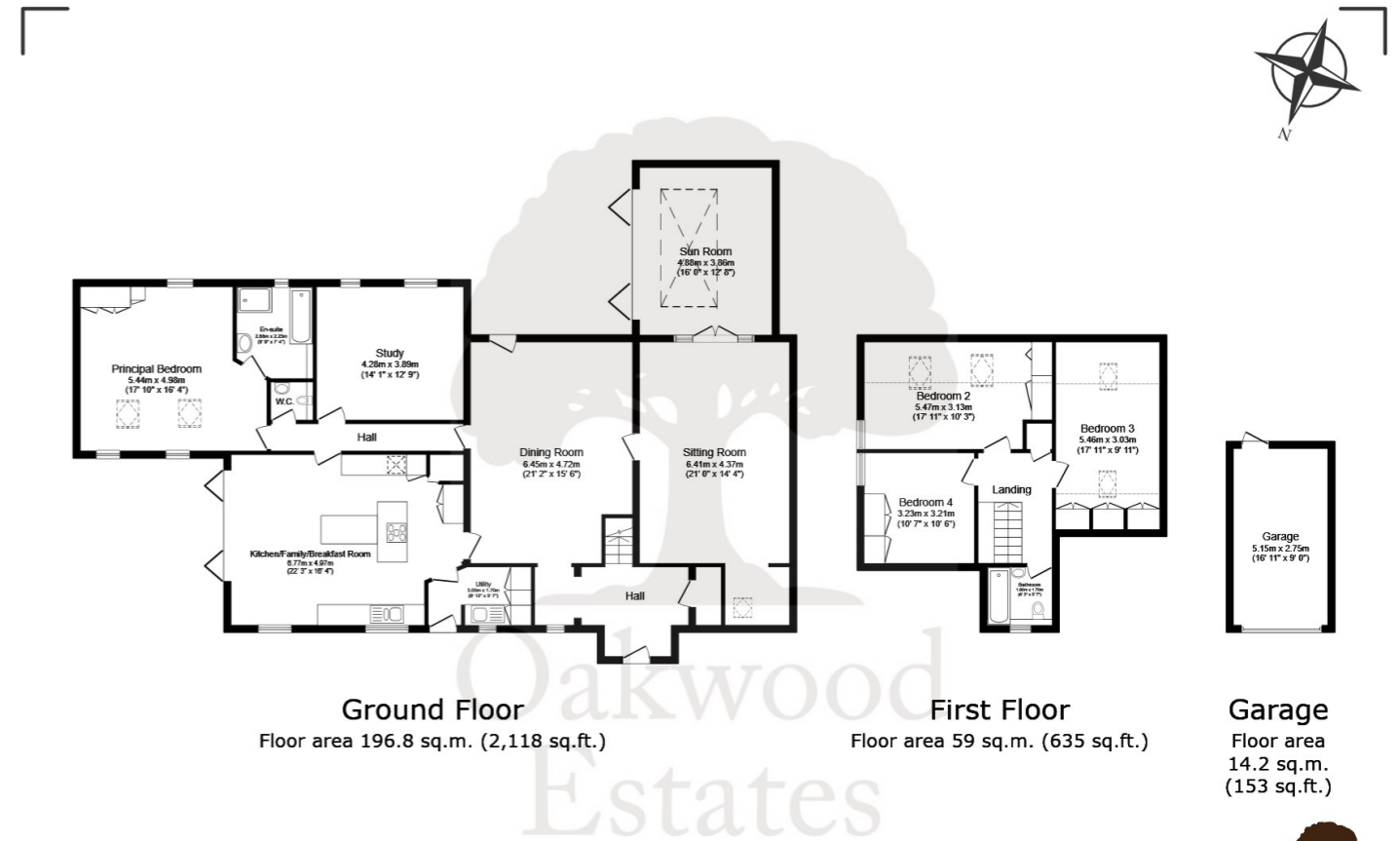

Total floor area: 270 sq.m. (2,906 sq.ft.)

This floor plan is for illustrative purposes only. It is not drawn to scale. Any measurements, floor areas (including any total floor area), openings and orientations are approximate. No details are guaranteed, they cannot be relied upon for any purpose and do not form any part of any agreement. No liability is taken for any error, omission or misstatement. A party must rely upon its own inspection(s). Powered by www.Propertybox.io

Prospective purchasers should be aware that these sales particulars are intended as a general guide only and room sizes should not be relied upon for carpets or furnishing. We have not carried out any form of survey nor have we tested any appliance or services, mechanical or electrical. All maps are supplied by Goview.co.uk from Ordnance Survey mapping. Care has been taken in the preparation of these sales particulars, which are thought to be materially correct, although their accuracy is not guaranteed and they do not form part of any contract.

Local Area

Beaconsfield Old Town is a picturesque, historic market town in Buckinghamshire, known for its wide Georgian high street, 16th-century timber-framed buildings, and traditional coaching inns. It offers a charming, village-like atmosphere, featuring independent boutiques, antique shops, and a weekly Tuesday market.

Local Schools

South Buckinghamshire is well renowned for its schooling options, being one of the last counties to still offer Grammar School education.

Some of the local schools include:

- Dr Challoner's Grammar School
- John Hampden Grammar School
- Royal Grammar School
- Davenies School
- High March School
- Beaconsfield High School
- The Beaconsfield School
- Butlers Court School
- Holtspur School & Pre-School

We recommend that you check with the local authority to ensure that the property falls in the catchment (if applicable) of your chosen educational institution.

Transport Links

The town is served by Beaconsfield Railway Station, operated by Chiltern Railways, which provides frequent services to London Marylebone with a journey time of about 24 minutes. The station also connects to

