

FOR SALE

£170,000

Park Road North, Claughton, Wirral. CH41 8AE



Fantastic Period Home! This is a wonderful opportunity to purchase this spacious three bedroom traditional mid terrace home in Claughton Village. Situated nearby to excellent amenities such as local shops, schools, doctors and public Transport to Liverpool, this is an ideal property for a first time buyer or young family.





Ground Floor

1st Floor

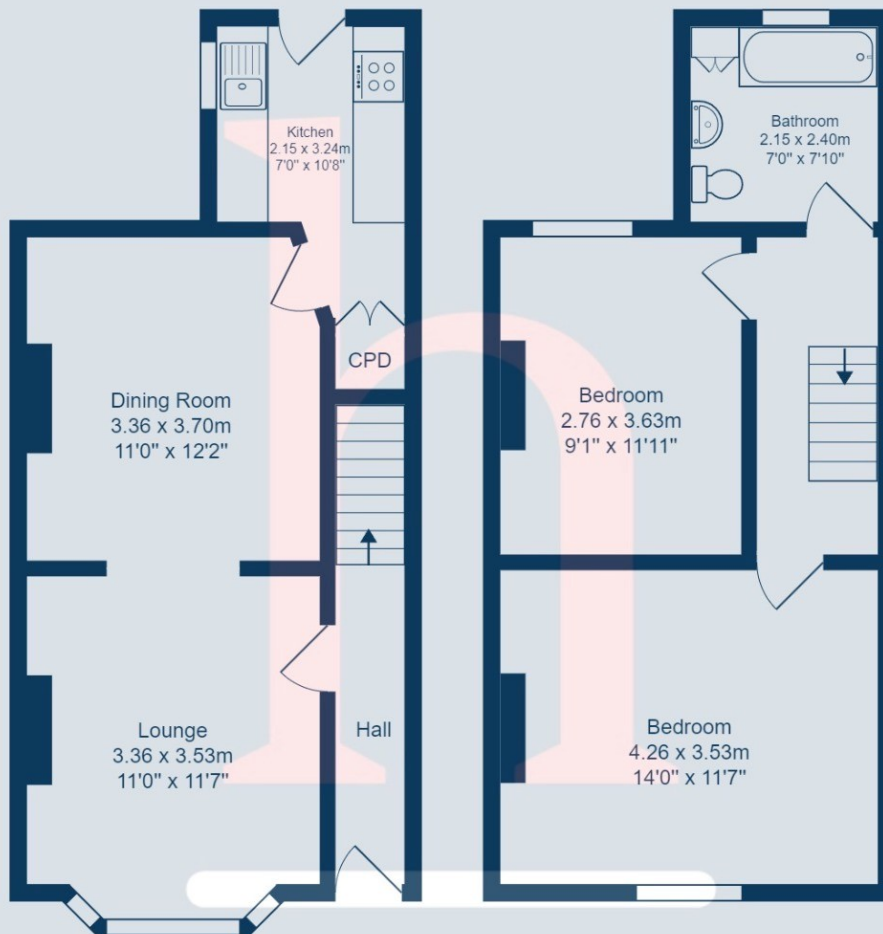

Total Area: 75.2 m² ... 810 ft²

All measurements are approximate and for display purposes only.

Energy Efficiency Rating		
	Current	Potential
Very energy efficient - lower running costs		
(92+) A		84
(81-91) B		
(69-80) C		
(55-68) D	67	
(39-54) E		
(21-38) F		
(1-20) G		
Not energy efficient - higher running costs		
England, Scotland & Wales		EU Directive 2002/91/EC