



The Windermere, Kempston, Bedford MK42 8TL

WALDENS ESTATE AGENTS



The Windermere
Kempston
Bedford
MK42 8TL

Guide Price £225,000

Located within the heart of Kempston is this well presented two double bedroom terraced property. No onward chain. Comprising of spacious lounge, kitchen diner. Two double bedrooms. Enclosed rear garden & off road parking.

- Well presented 2 Double bedroom terraced property
- Entrance hall
- Spacious lounge
- Kitchen diner
- Two double bedrooms
- Bathroom
- Enclosed rear garden
- Front garden
- Off road parking
- No onward chain

- Council Tax Band B
- Energy Efficiency Rating C



Within walking distance to all round amenities



Entering the property, you step into the entrance hall with a further door leading into the lounge. The lounge features stairs rising to the first floor and a door through to the kitchen. The kitchen is fitted with a range of units and built-in appliances, with ample space for a table and chairs, as well as an under-stairs storage cupboard. To the first floor are two bedrooms, with bedroom one benefiting from built-in wardrobes. A three-piece bathroom is conveniently positioned between both bedrooms. Outside, the rear garden is low-maintenance and enclosed by wooden fencing, while the front garden is open-plan. Parking is located close to the property.



Approx Gross Internal Area
52 sq m / 565 sq ft

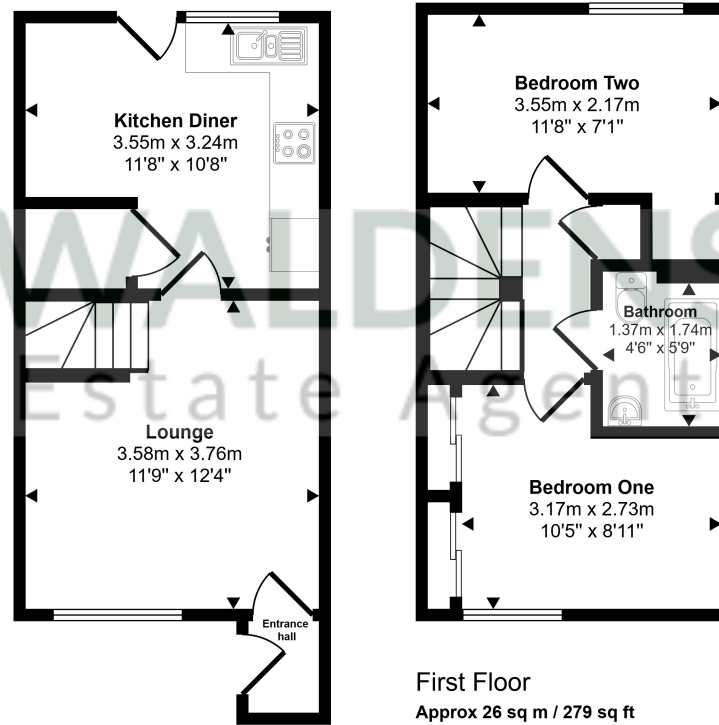

Energy Efficiency Rating		Current	Potential
Very energy efficient - lower running costs			
(92+)	A		
(81-91)	B		89
(69-80)	C	72	
(55-68)	D		
(39-54)	E		
(21-38)	F		
(1-20)	G		
Not energy efficient - higher running costs			
England, Scotland & Wales		EU Directive 2002/91/EC	

This floorplan is only for illustrative purposes and is not to scale. Measurements of rooms, doors, windows, and any items are approximate and no responsibility is taken for any error, omission or mis-statement. Icons of items such as bathroom suites are representations only and may not look like the real items. Made with Made Snappy 360.

01234 856684 | sales@waldens.co.uk | www.waldens.co.uk | 188-190 Bedford Road, Bedford, MK42 8BL

The information contained in the property details are designed to help you decide whether you would like to view the property and to avoid wasting your time in viewing unsuitable properties. We endeavour to ensure accurate information is detailed, but we are largely guided by information supplied to us by the seller. We are unable to check all aspects of the property as this would be prohibitive. Some of the photographs are taken using a wide- angled lens. Where a floor plan has been provided, this is for guidance purposes only.

