

## 150 Wear Bay Road

Folkestone  
CT19 6PZ

**£500,000 FREEHOLD**

DRAFT DETAILS... FOR SALE WITH BURNAP + ABEL... Burnap + Abel are delighted to offer this stunning four bedroom semi-detached chalet bungalow situated in the sought after location of Wear Bay Road on Folkestone's East Cliff. The property is in our opinion in superb decorative order and offers a lounge, open plan kitchen/diner, conservatory, family bathroom, four bedrooms and en-suite bathroom. Additional benefits include off road parking, a large rear garden with home office/gym, sea views, double glazing including Velux Balcony and storage cellar. For your chance to view call sole agent Burnap + Abel now on 01303 258590.



**Entrance Hall**

**Lounge**

18' 7" x 10' 11" (5.66m x 3.33m)

**Kitchen/Dining Room**

28' 3" x 11' 2" (8.61m x 3.40m)

**Conservatory**

10' 10" x 10' 0" (3.30m x 3.05m)

**Shower Room**

8' 4" x 7' 9" (2.54m x 2.36m)

**Bedroom Four**

14' 4" x 11' 11" (4.37m x 3.63m)

**First Floor Landing**

**Bedroom One**

11' 5" x 7' 1" (3.48m x 2.16m)

**En-Suite**

9' 7" x 8' 10" (2.92m x 2.69m)

**Bedroom Two**

15' 3" x 11' 11" (4.65m x 3.63m)

**Bedroom Three**

8' 10" x 6' 10" (2.69m x 2.08m)

**Off Road Parking**

**Rear Garden**

**Outbuilding/Gym**

15' 7" x 9' 2" (4.75m x 2.79m)

**Cellar Storage Room**

12' 6" x 12' 0" (3.81m x 3.66m)

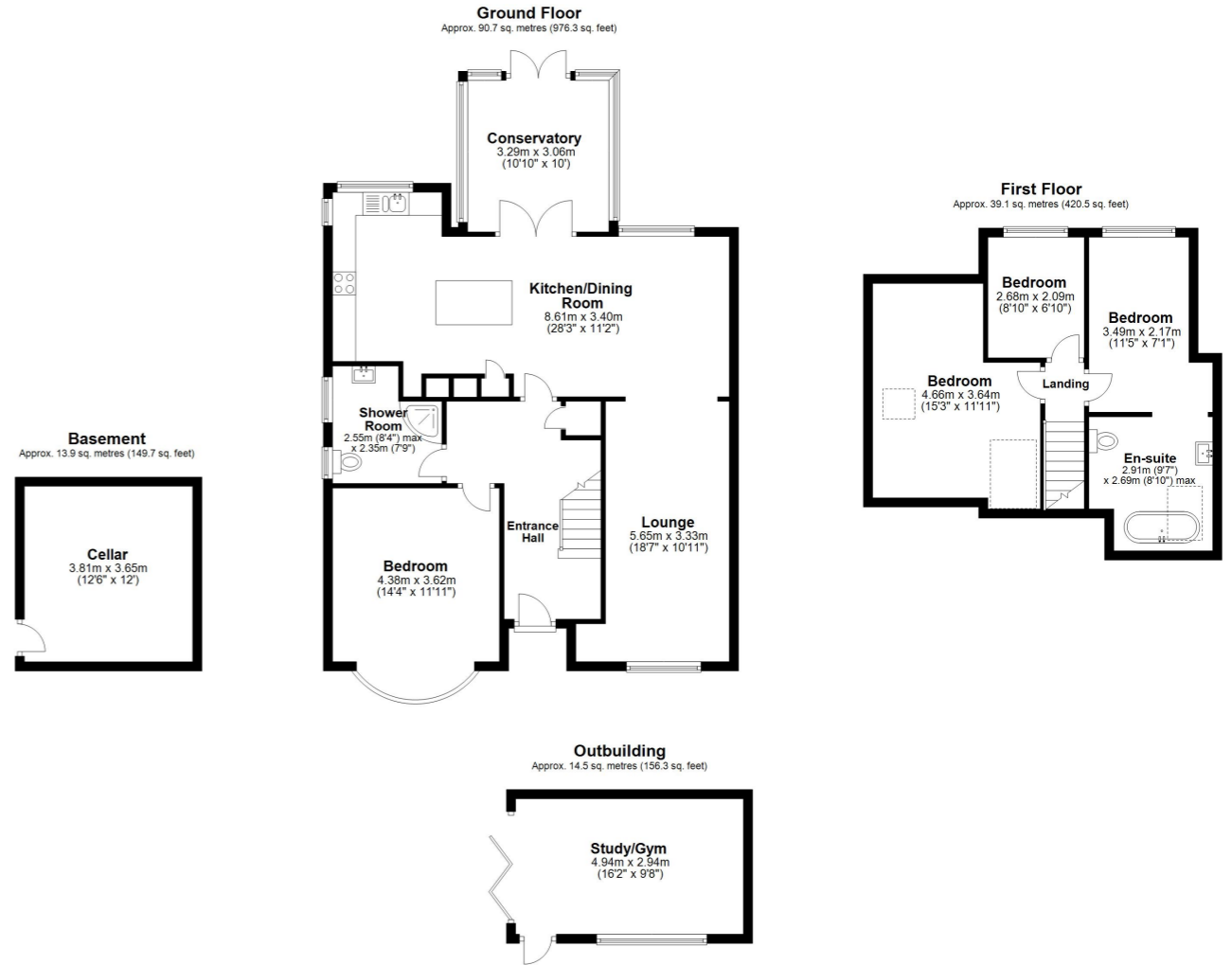

Whilst every attempt has been made to ensure the accuracy of the floor plan contained here, measurements of doors, windows, rooms and any other items are approximate and no responsibility is taken for any error, omission or mis-statement. This plan is for illustrative purposes only and should be used as such by any prospective purchaser. Plan produced using PlanUp.

