





Hillside Rise, Belper, Derbyshire DE56 1NH  
£325,000 - Freehold



## PROPERTY DESCRIPTION

Derbyshire Properties are pleased to offer for sale this much improved and extended detached bungalow benefiting from an elevated position that provides stunning countryside views. Internally the property briefly comprises of. :- entrance hallway, lounge/dining room, bedroom, bathroom, kitchen, rear hall/utility with door leading to an attached annex. The annex comprises of a fully equipped kitchen and studio apartment with sleeping/living space and en-suite shower facility. To the first floor is an open plan master bedroom suite with en-suite facility. Externally the property offers beautifully landscaped gardens with off street parking, side entertaining terrace and rear garden.

## POINTS OF INTEREST

- Detached Bungalow & Attached Annex
- 3 Bedrooms & 2 Bathrooms
- Landscaped Gardens
- COUNCIL TAX BAND C
- Elevated Position With Beautiful Views
- Close To Belper Town Centre
- Annex Studio Self Contained Living Area
- Off Street Parking
- Viewing Advised

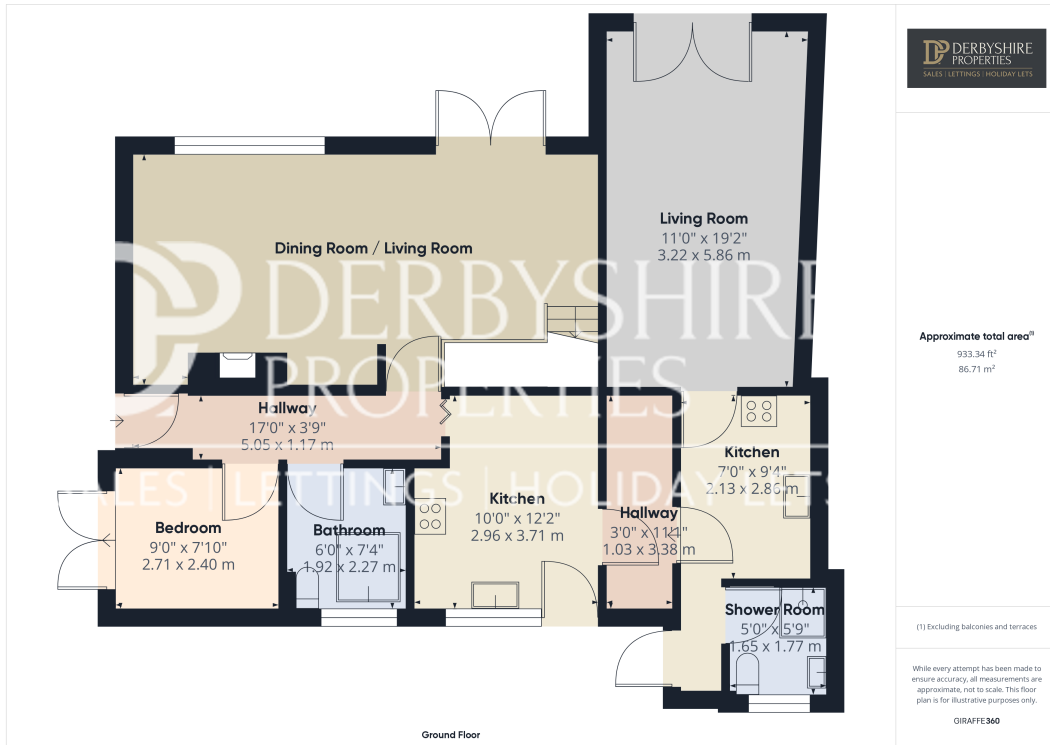

**DERBYSHIRE PROPERTIES**  
SALES LETTINGS HOLIDAY LETS

Approximate total area<sup>(1)</sup>  
933.34 ft<sup>2</sup>  
86.71 m<sup>2</sup>

(1) Excluding balconies and terraces

While every attempt has been made to ensure accuracy, all measurements are approximate, not to scale. This floor plan is for illustrative purposes only.

**GIRAFFE 360**

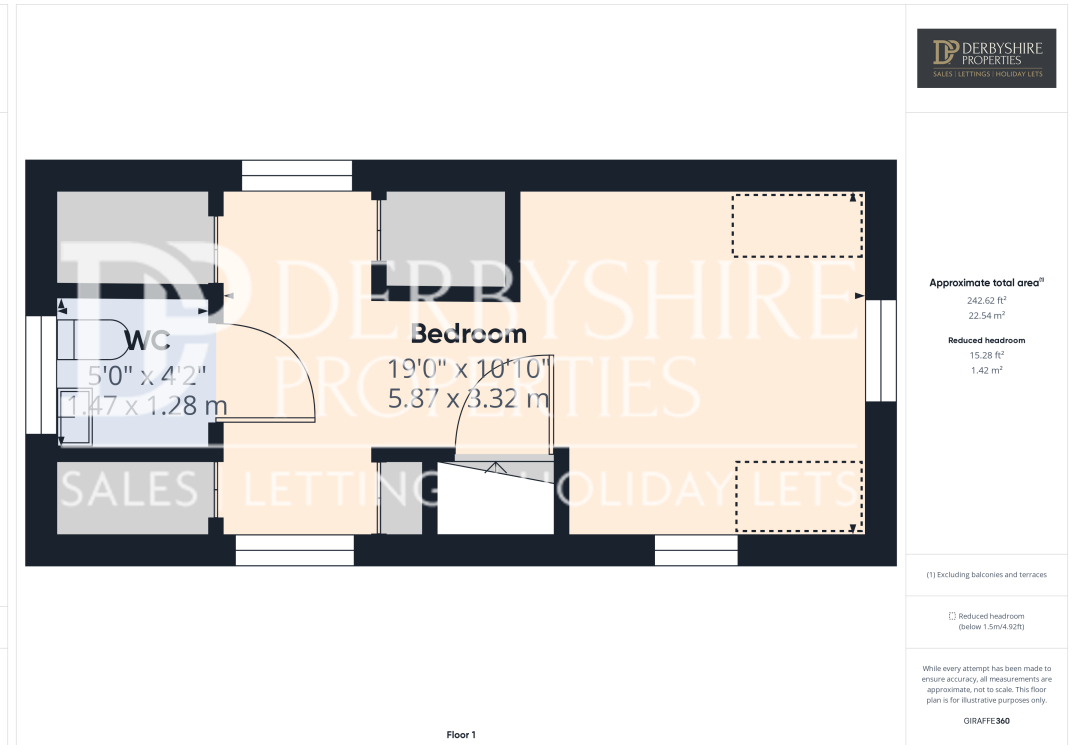

**DERBYSHIRE PROPERTIES**  
SALES LETTINGS HOLIDAY LETS

Approximate total area<sup>(1)</sup>  
242.62 ft<sup>2</sup>  
22.54 m<sup>2</sup>

Reduced headroom  
15.28 ft<sup>2</sup>  
1.42 m<sup>2</sup>

(1) Excluding balconies and terraces

Reduced headroom  
(below 1.5m/4.92ft)

While every attempt has been made to ensure accuracy, all measurements are approximate, not to scale. This floor plan is for illustrative purposes only.

**GIRAFFE 360**