

Coldershaw Road, W13

Approximate Floor Area = 105.2 sq m / 1132 sq ft

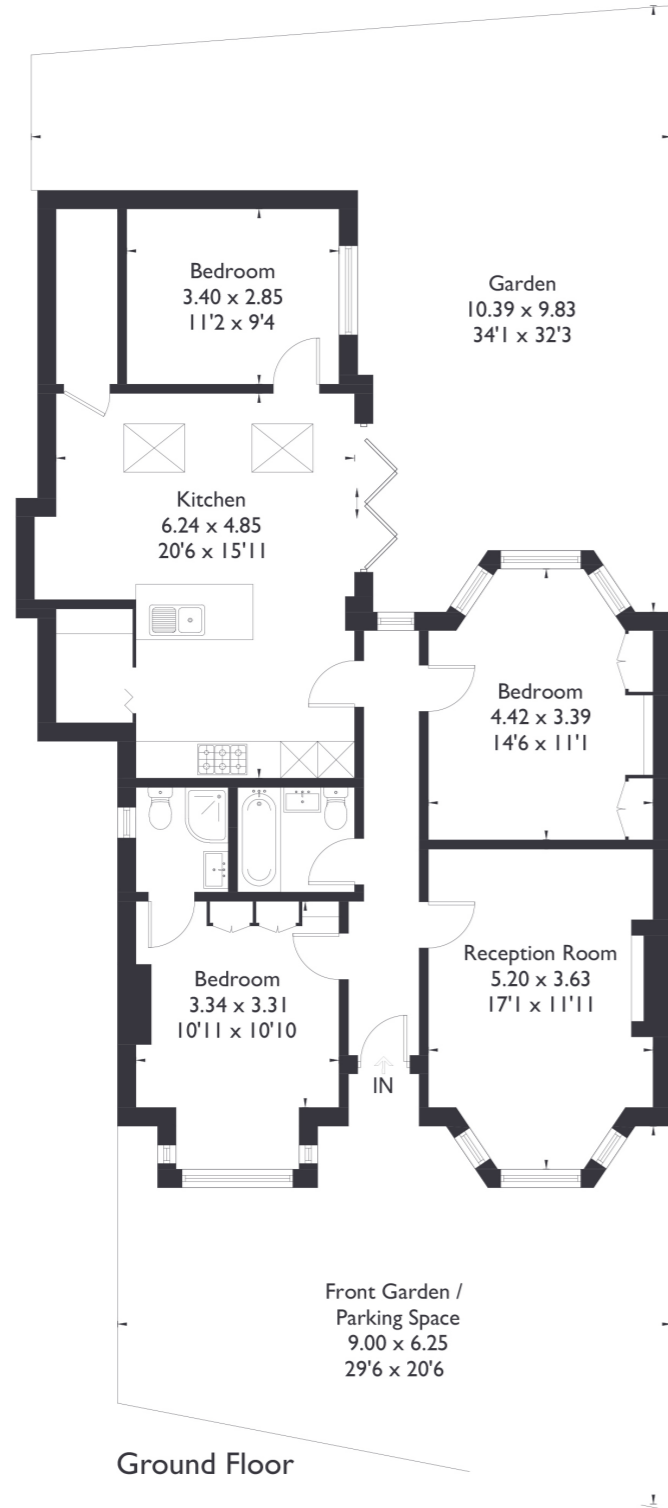

3 BEDROOM FLAT

Coldershaw Road, W13

GUIDE PRICE £700,000 - £725,000

Welcome to this beautifully presented three bedroom, two bathroom ground floor flat, perfectly situated in a sought after location. This charming property features off-street parking and is beautifully appointed throughout. The bay windows bring in plenty of natural light, while the wonderful extension showcases a spacious open plan kitchen and living area ideal for modern living.

FEATURES

- Three Bedrooms
- Two Bathrooms
- Open Plan Kitchen/Dining
- Off Street Parking
- Oaklands Primary School
- West Ealing Station (Elizabeth Line) & Northfields Station
- EPC Rating TBC



3 BEDROOM FLAT

Coldershaw Road, W13

Additionally, there's a separate reception room, and the flat opens onto a lovely private garden, offering a serene outdoor retreat.

Conveniently located just a 15 minute walk from the Elizabeth line in West Ealing, as well as Northfields station and local amenities, this property is also within excellent school catchment such as Oaklands Primary school. EPC Rating TBC.

