



159 Spectrum Apartments, Central Promenade, Douglas, Isle of Man. IM2 4JL

Immaculately presented one bedroom top floor apartment with pleasant outlook over communal courtyard and water feature, ideal for first time buyers and investors.



169950 £169,950

PROPERTY DESCRIPTION

A beautifully presented top floor apartment in the popular Spectrum Apartments complex in the heart of Douglas.

ACCOMMODATION Open-plan living with a fully integrated kitchen, and a spacious lounge and dining area that opens onto - Private balcony overlooking the communal courtyard and water feature – a perfect spot for morning coffee or evening relaxation. Well appointed double bedroom complimented by a modern three piece bathroom.

Secure building with lift access and well-maintained communal areas and a underground allocated parking space.

TENURE Leasehold with the remainder of a 999 year lease. Management company in place with management fees approximately £2000 per annum.

FEATURES

- Purpose Built Apartment
- Open Plan Kitchen/Lounge/Diner with Balcony
- Double Bedroom and Modern Bathroom
- Convenient Central Location
- Allocated Underground Parking Space
- Ideal for First Time Buyers or Investors

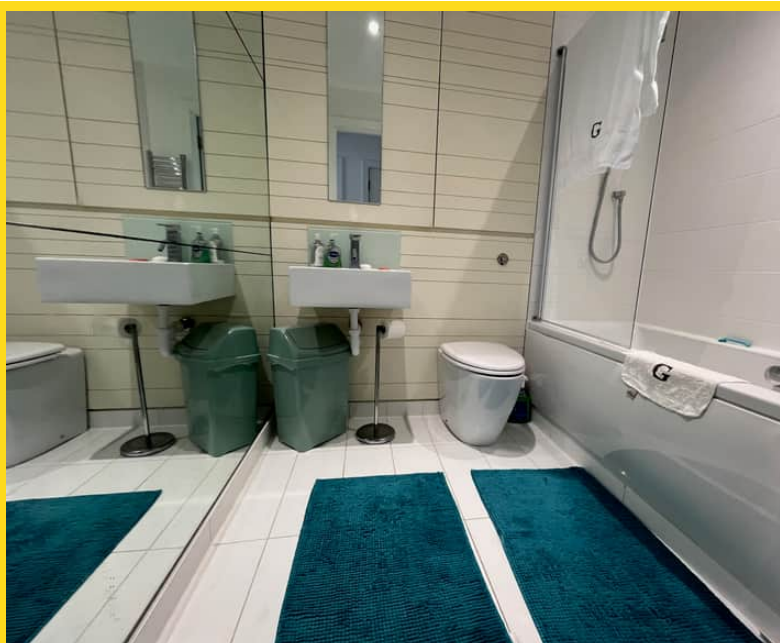

Property Images



FLOORPLAN



GROUND FLOOR
391 sq.ft. (36.3 sq.m.) approx.

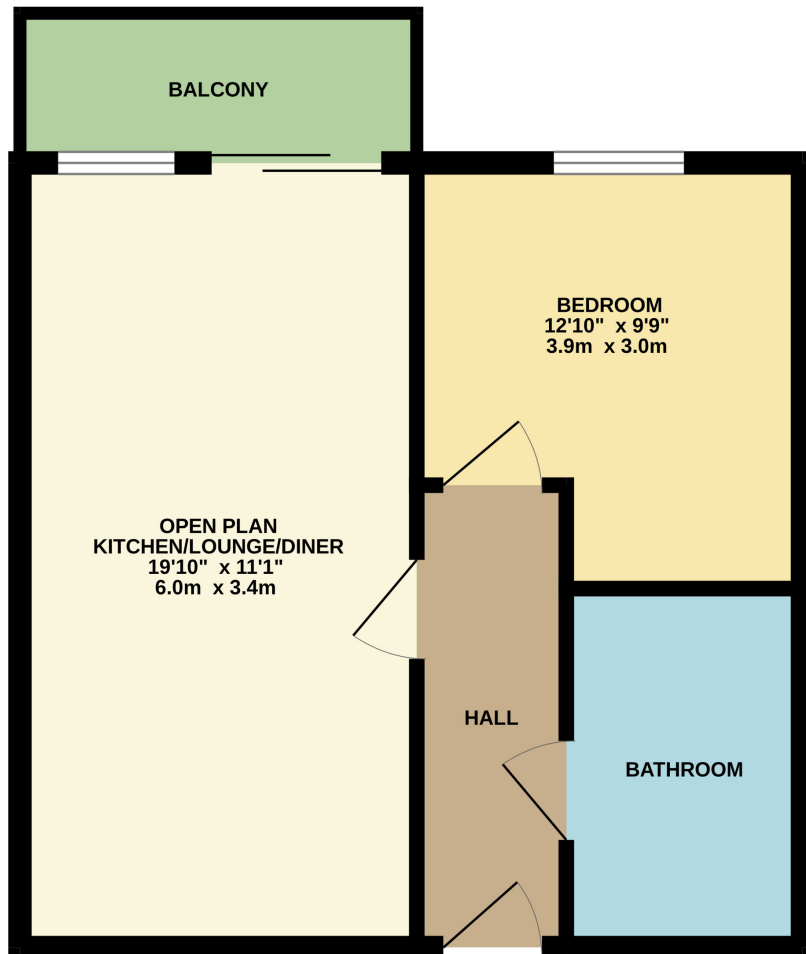

TOTAL FLOOR AREA : 391 sq.ft. (36.3 sq.m.) approx.

Whilst every attempt has been made to ensure the accuracy of the floorplan contained here, measurements of doors, windows, rooms and any other items are approximate and no responsibility is taken for any error, omission or mis-statement. This plan is for illustrative purposes only and should be used as such by any prospective purchaser. The services, systems and appliances shown have not been tested and no guarantee as to their operability or efficiency can be given.
Made with Metropix ©2025

DISCLAIMER: Whilst Manxmove Ltd believe that these details are correct, neither Manxmove Ltd or their clients guarantee their accuracy in any way. Consequently, these details are not to be used to form part of any legally binding contract. Prospective purchasers or tenants are advised to visit this property to satisfy themselves as to the correctness of these details. Please note, we use wide angle camera lenses in order to show as much of each room as possible. This is not intended to mislead any prospective purchasers or tenants in any way and an honest verbal description is always available prior to viewing if required.

Manxmove Estate Agents - Douglas
Victoria Road, Douglas, IM2 4HD
01624 619966
info@manxmove.im