



# Parkdale, Danbury, CM3 4EH

Council Tax Band E (Chelmsford City Council)



Guide Price £600,000 Freehold



GUIDE PRICE £600,000 - £625,000

This stunning four bedroom detached house offers light and spacious accommodation in a sought-after and convenient location, close to local schools and amenities and has the additional benefit of having planning approved in 2021 (21/01530/FUL) to add a two storey extension to further enhance the accommodation available.

This property is ideal for those looking for convenience and comfort. As you enter the property there is an entrance lobby with useful cloaks storage, you are then greeted by the large and light l-shaped living room and double doors leading through to the rear of the house and a separate dining room therefore providing plenty of space for entertaining guests or relaxing with the family. The fitted kitchen features shaker style units with integrated appliances which include 5 ring gas hob with cooker hood above, electric oven with microwave oven over and an integrated dishwasher. A rear lobby provides access to a ground floor cloakroom and also the utility room which in turn leads into the garage ensuring practicality for everyday living. Upstairs, you will find four bedrooms and a family bathroom which is well-appointed and features a freestanding clawfoot bath and separate walk in shower.

This property benefits from gas central heating and double glazing and the highlight of this home is undoubtedly the 100ft x 39ft west facing rear garden which provides the perfect space for children to enjoy outdoor activities as well as entertaining guests. In addition, this property offers a garage and a block paved driveway provides parking for 3/4 cars.

With its desirable location and spacious layout, this property is sure to impress. Internal viewing is highly recommended to fully appreciate the full potential of this wonderful family home. Don't miss out on the opportunity to make this house your dream home.

Call us today on 01245 222856 to book your viewing.

#### AGENTS NOTE

We are informed by the current sellers that during their purchase of the property in 2016 they were made aware that in 1996 the property had suffered from subsidence. Full documentation is available to interested parties to show that underpinning works were undertaken and a certificate of structural adequacy was issued and there have been no further issues experienced.

#### LOCATION

The property is conveniently situated within walking distance of the Village Centre. Danbury offers a range of local facilities which include local Co-op supermarket and Tesco convenience store, public houses and a parish church. Schooling includes Danbury Park and St Johns primary schools as well as Elm Green and Heathcote. For the commuter, Chelmsford and Hatfield Peverel mainline stations lie approximately 5 miles from the village. Chelmsford city centre offers an extensive range of shopping and leisure activities whilst Maldon town centre and South Woodham Ferrers are also within easy reach of the village. The A12 trunk road which links to the M25 and beyond is less than 2.5 miles from the property.

- Four bedroom detached house
- Fitted kitchen with integrated appliances
- Ground floor cloakroom and family bathroom
- 100ft x 39ft west facing rear garden
- Close to local schools and amenities
- Two separate reception rooms
- Utility room
- Gas central heating and double glazing
- Garage and parking for 3/4 cars
- Internal viewing recommended



















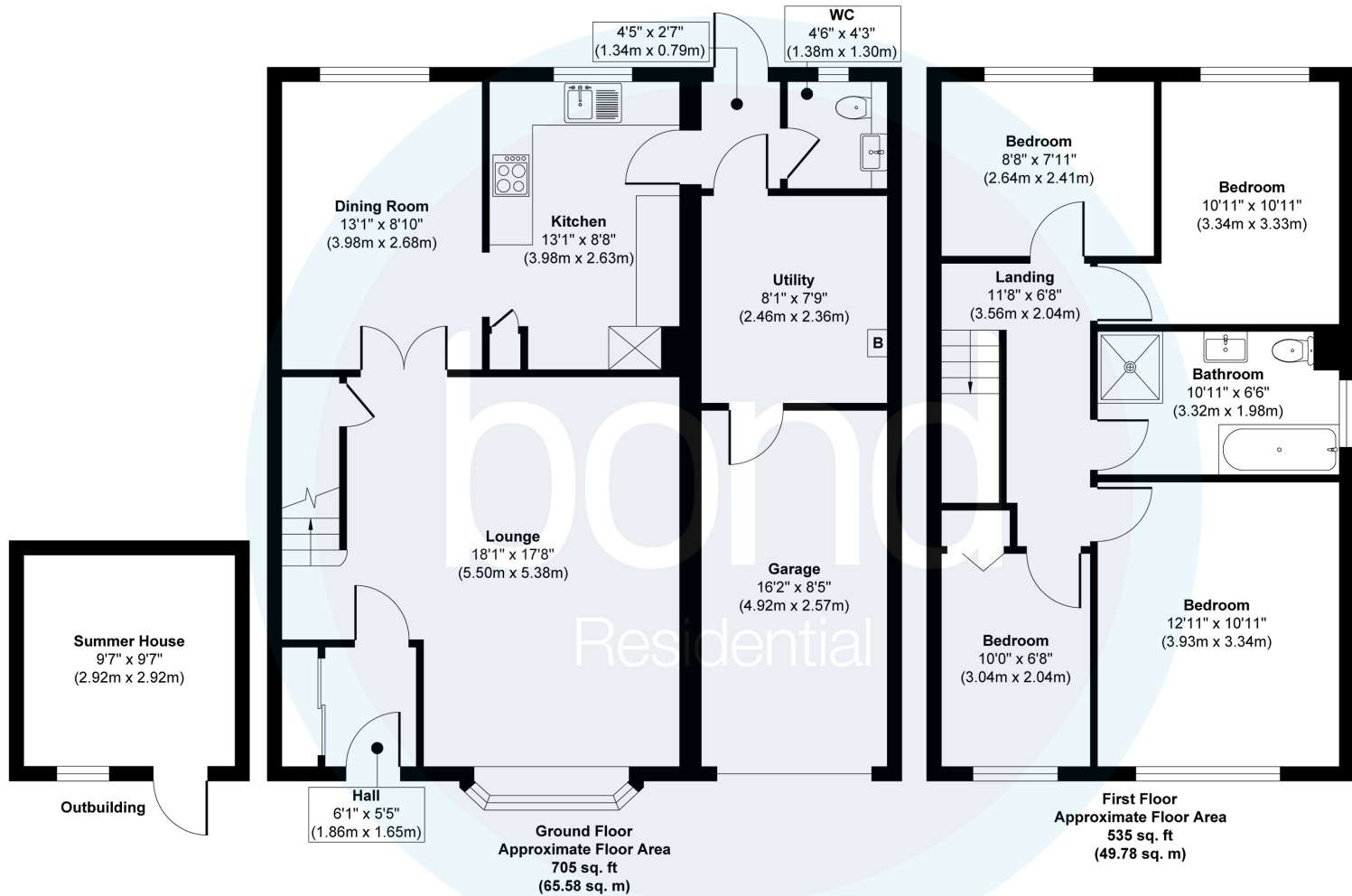

**Approx. Gross Internal Floor Area 1240 sq. ft / 115.36 sq. m**

Illustration for identification purposes only, measurements are approximate, not to scale.

Produced by Elements Property

Consumer Protection from Unfair Trading Regulations 2008 and the Business Protection from Misleading Marketing Regulations 2008. Bond Residential have made every effort to ensure that consumers and/or businesses are treated fairly and provided with accurate material information as required by law. We have not tested any apparatus, equipment, fixture, fitting or any services and as such are unable to verify they are in working order, fit for their purpose, or within the ownership of the seller or landlord. Neither have we been able to check the legal documentation to verify the legal status of the property. We therefore advise potential buyers or tenants to verify these matters with their own solicitors or other advisers.

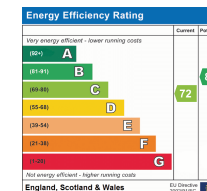

10, Maldon Road,  
Danbury, Essex, CM3 4QQ  
Telephone: 01245 222856  
Website: [www.bondresidential.co.uk](http://www.bondresidential.co.uk)