

FOR SALE

£480,000

White Stack Close, Bromborough, Wirral. CH62 6AQ



DETACHED GARAGE! Exclusive New Build Development in Sought After Bromborough Location! This is a wonderful opportunity to purchase this incredible, four bedroom new build detached family home. 'White Stack' is an exclusive development of just four properties which have been built by a very reputable, local Wirral developer that has an excellent reputation for creating luxury living spaces as well as a keen eye for detail.

Ground Floor

Entrance Hallway

Lounge

11' 3" x 10' 8" (3.43m x 3.25m)

Study/Playroom

10' 6" x 8' 7" (3.20m x 2.62m)

Utility

7' 2" x 5' 9" (2.18m x 1.75m)

Downstairs WC

5' 9" x 3' 5" (1.75m x 1.04m)

Open Plan Kitchen/Diner

24' 5" x 15' 6" (7.44m x 4.72m)

First Floor

Bedroom

11' 5" x 11' 2" (3.48m x 3.40m)

En-Suite

Bedroom

12' 0" x 11' 9" (3.66m x 3.58m)

Bedroom

12' 8" x 9' 4" (3.86m x 2.84m)

Bedroom

13' 0" x 10' 11" (3.96m x 3.33m)

Bathroom

7' 6" x 5' 6" (2.29m x 1.68m)





GROUND FLOOR

1ST FLOOR

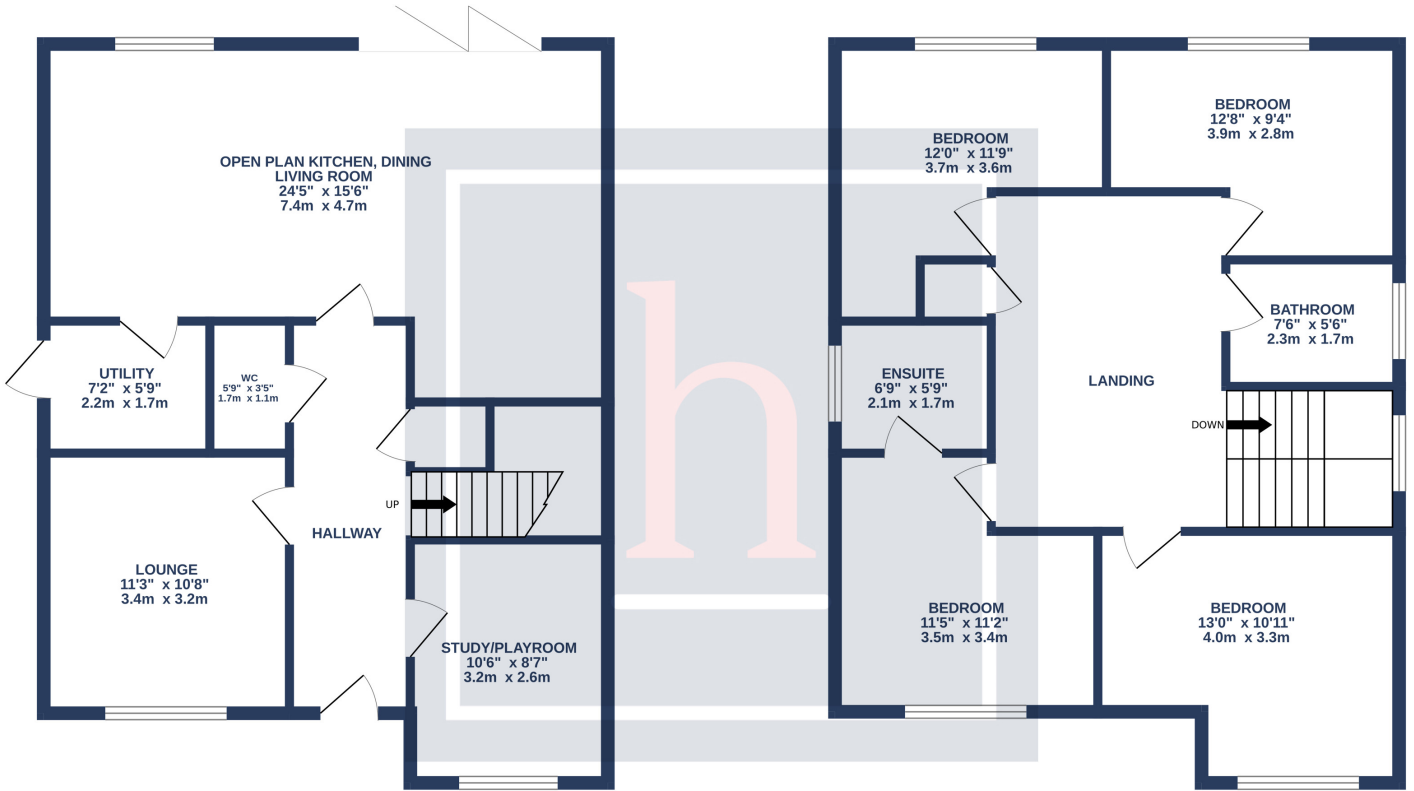

TOTAL FLOOR AREA : 1498sq.ft. (139.2 sq.m.) approx.

Whilst every attempt has been made to ensure the accuracy of the floorplan contained here, measurements of doors, windows, rooms and any other items are approximate and no responsibility is taken for any error, omission or mis-statement. This plan is for illustrative purposes only and should be used as such by any prospective purchaser. The services, systems and appliances shown have not been tested and no guarantee as to their operability or efficiency can be given.
Made with Metropix ©2023