



25 Maple Avenue, Onchan, Isle of Man. IM3 3HJ

Charming detached two bedroom bungalow with garage, conservatory and private rear garden.



£299,950 Freehold

PROPERTY DESCRIPTION

Manxmove are delighted to bring to market this well presented two bedroom true bungalow situated in a quiet and popular residential area of Onchan. Offering comfortable and low-maintenance living, 25 Maple Avenue is perfect for downsizers, professionals or anyone looking for single-level accommodation in a convenient location.

Key Features:

Welcoming and spacious lounge with feature fireplace, flowing seamlessly into a bright conservatory – an ideal space for relaxing or entertaining.

Well-appointed galley kitchen with generous storage and direct access to the rear garden.

Two double bedrooms, both with fitted wardrobes offering excellent storage.

Stylish and modern four-piece bathroom including a separate shower and bath.

Attached garage with internal access, housing a newly installed gas-fired boiler. Off-road parking for added convenience.

Private lawned rear garden, perfect for enjoying the outdoors in peace and privacy.

Located within easy reach of Onchan's local shops, amenities, public transport, and nearby scenic walks, this delightful bungalow offers a blend of comfort, practicality and location.

FEATURES

- Detached True Bungalow
- Quiet Residential Location
- Lounge plus Kitchen and Conservatory
- 2 Double Bedrooms plus Bathroom
- Attached Garage & Driveway
- Private Rear Garden



Property Images



FLOORPLAN



GROUND FLOOR
928 sq.ft. (86.3 sq.m.) approx.

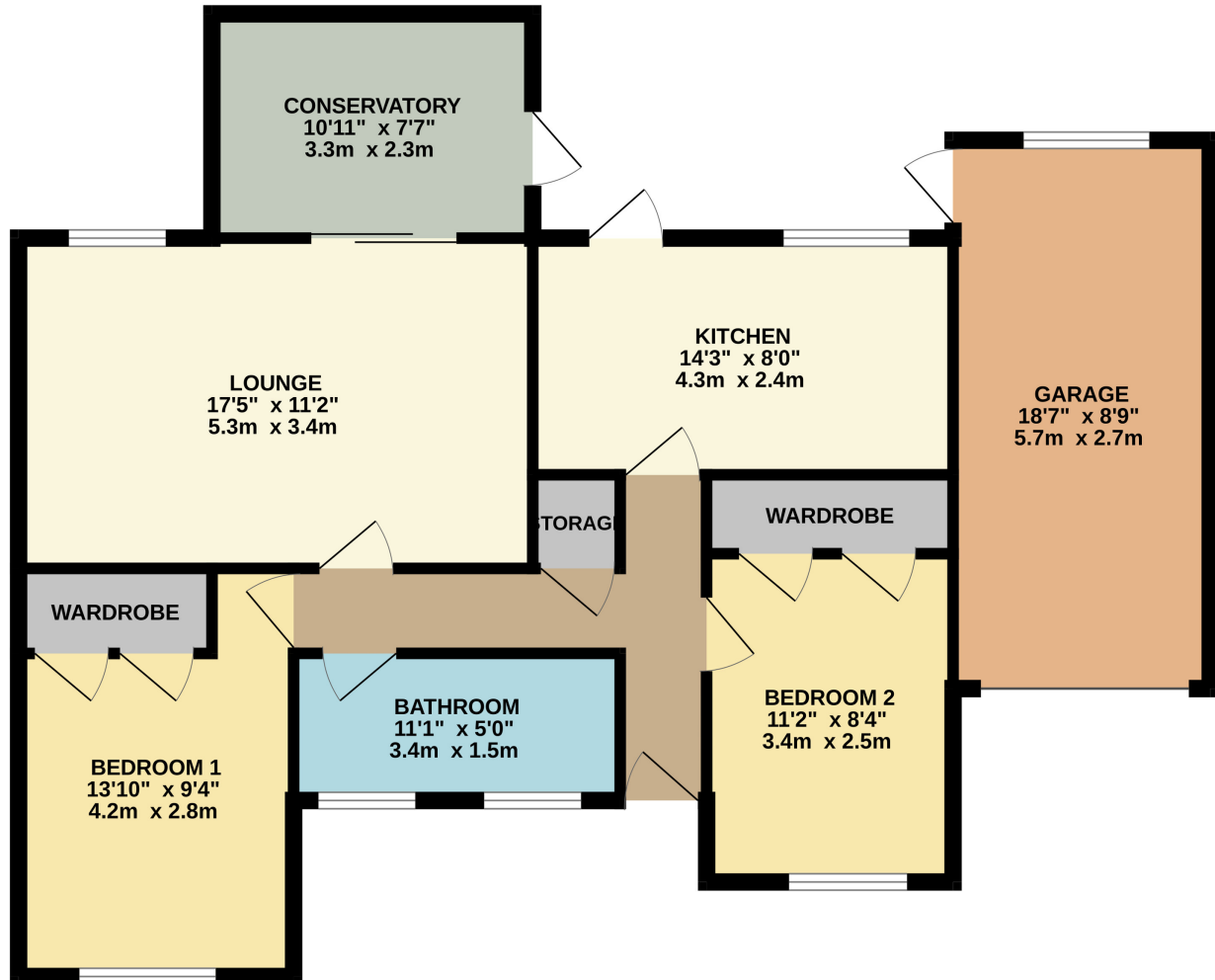

TOTAL FLOOR AREA : 928 sq.ft. (86.3 sq.m.) approx.

Whilst every attempt has been made to ensure the accuracy of the floorplan contained here, measurements of doors, windows, rooms and any other items are approximate and no responsibility is taken for any error, omission or mis-statement. This plan is for illustrative purposes only and should be used as such by any prospective purchaser. The services, systems and appliances shown have not been tested and no guarantee as to their operability or efficiency can be given.
Made with Metropix ©2025

DISCLAIMER: Whilst Manxmove Ltd believe that these details are correct, neither Manxmove Ltd or their clients guarantee their accuracy in any way. Consequently, these details are not to be used to form part of any legally binding contract. Prospective purchasers or tenants are advised to visit this property to satisfy themselves as to the correctness of these details. Please note, we use wide angle camera lenses in order to show as much of each room as possible. This is not intended to mislead any prospective purchasers or tenants in any way and an honest verbal description is always available prior to viewing if required.

Manxmove Estate Agents - Douglas
Victoria Road, Douglas, IM2 4HD
01624 619966
info@manxmove.im