

# Truuli



## 13 Oakmead Road, Croydon, Surrey, CR0 3AS

£410,000 Freehold

- Off street parking for two cars
- First floor bathroom
- Well maintained family home
- Close to Beddington Lane tram stop
- Close to the Green open spaces of Mitcham common
- Conservatory

Southbridge Place, Surrey, CR0 4HA

Tel: 0330 043 0002

Email: [save@truuli.co.uk](mailto:save@truuli.co.uk) Web: [www.truuli.co.uk](http://www.truuli.co.uk)

# 13 Oakmead Road, Croydon, Surrey, CR0 3AS

£410,000 Freehold

A well maintained three bedroom family home situated on Oakmead Road, Croydon. The property benefits from having off-street parking and an array of transport links.

Ground Floor  
477 sq.ft. (44.3 sq.m.) approx.

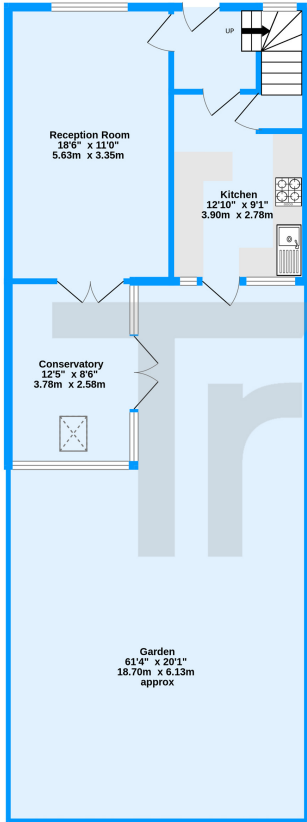

1st Floor  
367 sq.ft. (34.1 sq.m.) approx.

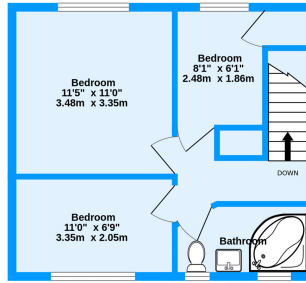

Oakmead Road, Croydon, CR0

TOTAL FLOOR AREA: 845 sq.ft. (78.5 sq.m.) approx.  
Measurements are approximate. Not to scale. Illustrative purposes only  
Made with Metropix ©2023

