



Milton Road  
Luton  
Bedfordshire  
LU1 5JB

Offers In Excess Of £234,000

bettermove 

# Milton Road Luton

Bettermove are proud to present this 2 bedroom terraced house in Luton available with no forward chain.

The property is currently tenanted and rental yields can be obtained through Bettermove.

The property benefits from double glazing, gas central heating throughout.

The council tax band is B.

The interior of this beautifully presented property comprises a spacious living room and fitted kitchen on the ground floor. The first floor consists of 2 bedrooms and the family bathroom. The exterior boasts a private rear garden, perfect for enjoying the summer months.

Located in the popular town of Luton, the property is close to a range of amenities, including shops, supermarkets, restaurants and pubs. Excellent transport connections can be found from the A505, M1 and many local bus routes.

This exciting opportunity should not be missed! All enquiries can be made through Bettermove on 0330 004 0050.

You can secure the purchase today by paying an exclusivity fee of £1,000 which gives you the rights to purchase within a given timeframe.

Paying this fee ensures that the seller takes their property off the market and reserves it exclusively for you, therefore eliminating the risk of gazumping and aborted costs.

The exclusivity fee is returned to you upon successful completion of the property.



GROUND FLOOR  
340 sq.ft. (31.6 sq.m.) approx.

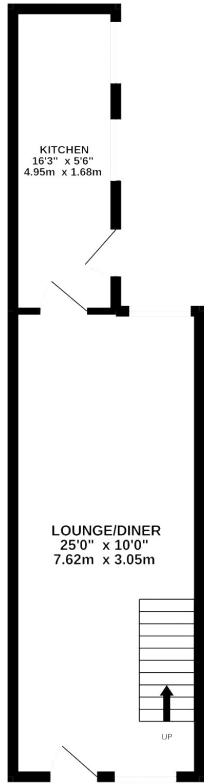

1ST FLOOR  
328 sq.ft. (30.5 sq.m.) approx.

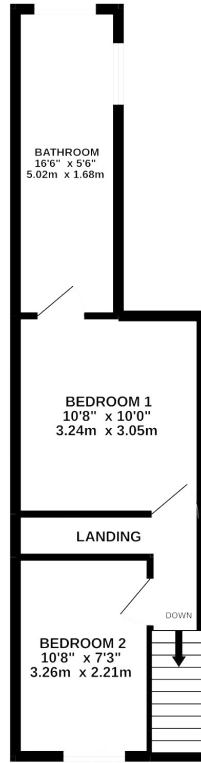

TOTAL FLOOR AREA - 668 sq.ft. (62.1 sq.m.) approx.

Whilst every attempt has been made to ensure the accuracy of the floorplans contained here, measurements of doors, windows, rooms and any other items are approximate and no responsibility is taken for any errors, omissions or mis-statements. This plan is for illustrative purposes only and should be used as such by any prospective purchaser. The services, systems and appliances shown have not been tested and no guarantee as to their operability or efficiency can be given.  
Made with Homestyler © 2022

20-22 Bridge End, Leeds, LS1 4DJ  
t: 0330 004 0050 e: hello@bettermove.co.uk  
[www.bettermove.co.uk](http://www.bettermove.co.uk)