

Birch Grove, Shepperton, TW17 8SS

Guide Price £700,000



- Outbuilding With Power
- Cul-De-Sac Location
- Extended
- Four Piece Bathroom Suite
- Three Good Size Bedrooms
- South Facing Rear Garden
- Kitchen Breakfast Room
- Close To Schools & Mainline Train Station

Birch Grove, TW17 8SS

Approximate Gross Internal Area
Main House 1001 sq ft - 93 sq m
Outbuilding 161 sq ft - 15 sq m
Total 1162 sq ft - 108 sq m

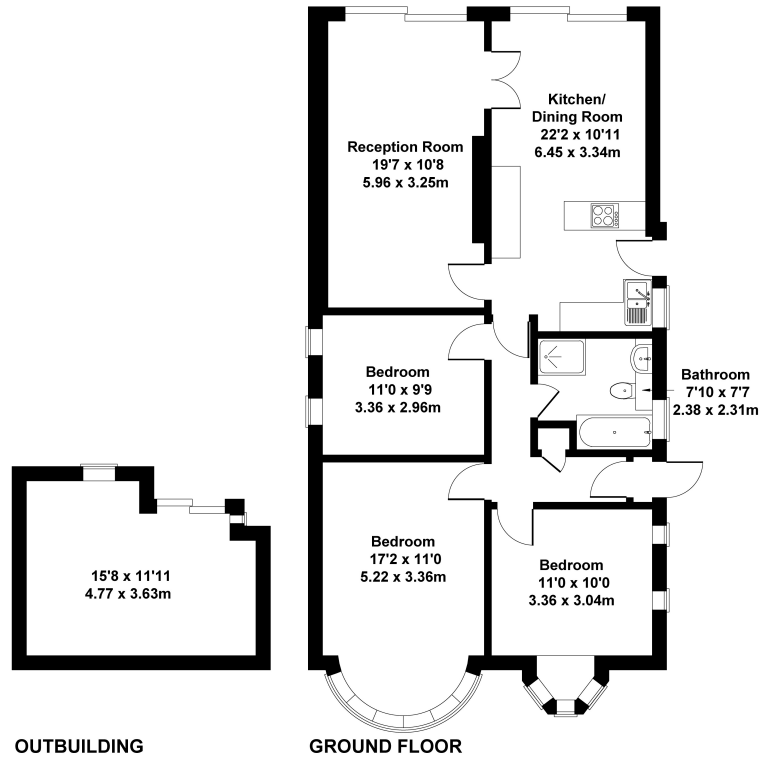

This floorplan is for guidance only and does not form part of an offer or contract.
Buyers or tenants should verify all details through inspection, searches, and surveys.
Measurements are approximate and should not be relied upon for valuation or transactions.
Produced by Plan Portal.
www.evolve.london.co.uk

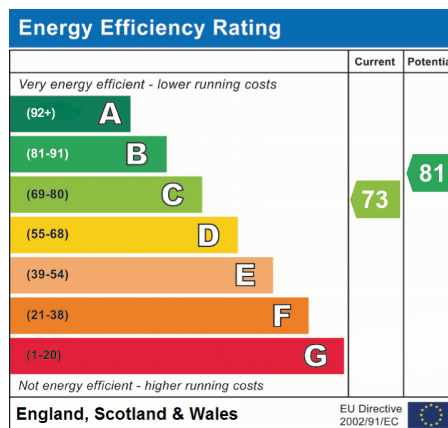

We have not tested the services or domestic appliances so we cannot verify that they are in working order. The buyer is advised to obtain verification from their solicitor or surveyor. These particulars form no part of any offer or contract and their accuracy cannot be guaranteed.