



7 Holkham Close

Widnes, WA8 7EE



0151 424 5100
info@mylerestates.com



Holkham Close

Widnes, WA8 7EE

£350,000

This immaculate detached house offers a spacious and flexible layout ideal for families, featuring three bedrooms, modern amenities, a contemporary kitchen, a cozy reception room with a fireplace, and a garden, all in a sought-after location with convenient access to schools, parks, and public transport.



MYLER&Co



Ground Floor

Lounge

3.40m x 4.48m (11' 2" x 14' 8")

Office

3.07m x 2.34m (10' 1" x 7' 8")

Kitchen/Dining Room

7.14m x 2.97m (23' 5" x 9' 9")

Utility Room

Downstairs WC

Lean To

First Floor

Bedroom One

3.21m x 3.16m (10' 6" x 10' 4")

Ensuite

Bedroom Two

3.91m x 3m (12' 10" x 9' 10")

Bedroom Three

3.66m x 3.50m (12' 0" x 11' 6")

Family Bathroom



7 Holkham Close, Widnes, WA8 7EE

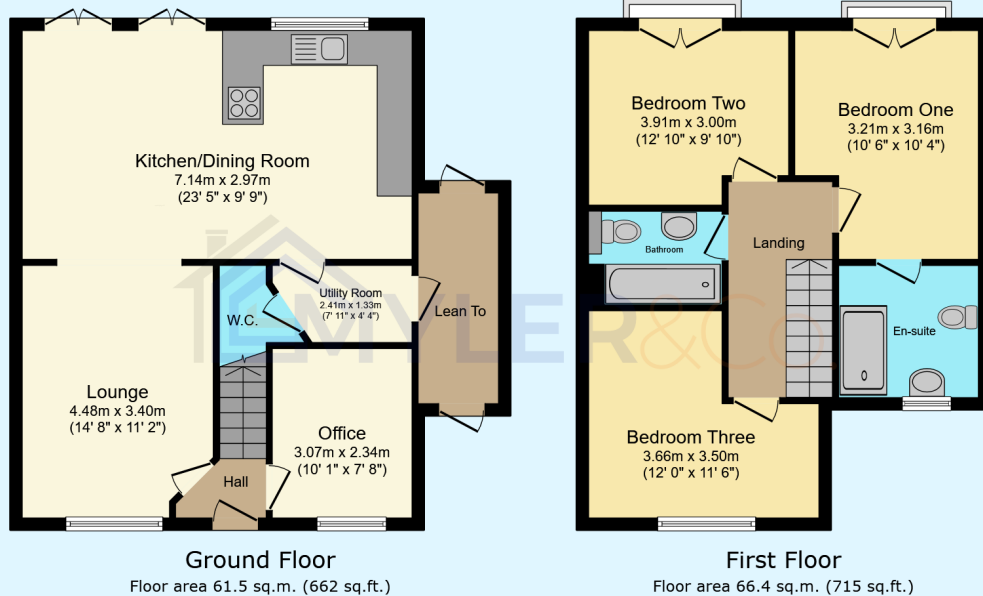

This floor plan is for illustrative purposes only. It is not drawn to scale. Any measurements, floor areas (including any total floor area), openings and orientations are approximate. No details are guaranteed, they cannot be relied upon for any purpose and do not form any part of any agreement. No liability is taken for any error, omission or misstatement. A party must rely upon its own inspection(s). Powered by www.Propertybox.io



Myler & Co
77, Albert Road, Widnes, Cheshire, WA8 6JS
0151 424 5100
info@mylerestates.com