



Flat 4, 6 Parkhead Terrace, Edinburgh, EH11 4RB

Immaculately Presented, Two-Bedroom, First-Floor Flat

Up to date price and viewing info at [mov8realestate.com/property](https://www.mov8realestate.com/property)

éspc rightmove  Zoopla
find your happy

Property Description

Immaculately presented, two-bedroom, first-floor flat, with a generous, private garden. Located in the popular Parkhead residential area, south-west of Edinburgh city centre.

Comprises an entrance hallway, living/dining room, kitchen, two double bedrooms and a family bathroom.

Highlights include a modern, fitted kitchen with appliances, a stylish bathroom, contemporary flooring, double glazing and HIVE gas central heating.

Externally, a particularly generous garden plot features a lawn, a shed, a patio and low-maintenance borders whilst, to the front, is ample, unrestricted street parking.

Quick access to the city centre is provided by a regular bus service, whilst a tram stop is a ten-minute walk from the property.

A welcoming entrance hall, with storage, is finished with neutral decor and wood-effect flooring, which continues into a living and dining room ahead. The tastefully presented reception room offers a versatile floor plan for freestanding furniture and opens into a kitchen. Fitted with traditional, white units, marble-effect worktops and splashback tiling, the kitchen also includes a cooker, a washing machine and an integrated fridge/freezer.

Set to either aspect, two good-sized bedrooms are carpeted and benefit from built-in cupboard storage whilst, completing the accommodation, a good-sized, naturally lit bathroom comprises a contemporary, three-piece suite, a shower-over-bath, a chrome, ladder-style radiator and tiled splash walls and flooring.



Flat 4, 6 Parkhead Terrace, Edinburgh EH11 4RB

Approximate Gross Internal Area: (646 sq ft - 60 sq m.)

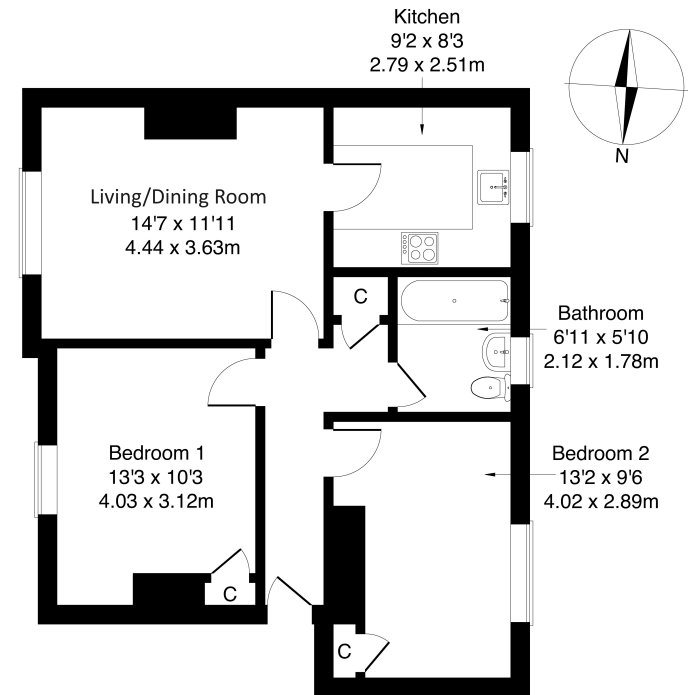

Legal Disclaimer : Floor-plan and measurements are for illustrative guidance only, and not intended to form part of any contract.

Area Description

Parkhead is an established residential area, a short distance from Edinburgh College and the Sighthill campus of Napier University, with schooling at all levels available locally. There is a good variety of shops and amenities to hand, with more extensive facilities provided by The Gyle and Hermiston Gait retail parks. Nearby Longstone is home to a large Sainsbury's store.

with an Asda close by at Chesser. Many recreational facilities are available within the area, including a cinema at the nearby Westside Plaza, and leisure facilities and a swimming pool at The Wester Hailes Education Centre, just a few hundred yards distant. There is also Kingsknowe Golf Course, Sighthill Bowling Club, Pure Gym, and The Corn Exchange.





Our Services

- Free pre-sale property valuations
- Great value fixed estate agency fees
- Extensive buyer matching database
- Purchase and sale conveyancing

Contact Us

0345 646 0208

sales@mov8realestate.com

www.mov8.com

Head Office

6 Redheughs Rigg, Edinburgh, EH12 9DQ

Glasgow Office

77 Renfrew Street, Glasgow, G2 3BZ



Estate Agents and Solicitors



These particulars do not form part of any contract and the statements or plans contained herein are not warranted nor are they to scale. All descriptions, dimensions, areas, reference to condition and necessary permissions for use and occupation and other details are given in good faith, and are believed to be correct, but any prospective purchaser should not rely on them as statements or representations of fact, and any prospective purchaser must satisfy themselves by inspection or otherwise as to the correctness of each of them. The Seller shall not be bound to accept the highest or any offer nor to accept a full offer of the Fixed Price where this is applicable. Approximate measurements have been taken by sonic device and measurements are most often taken to the widest point of any room or space. Services and appliances have not been tested for efficiency or safety and no warranty is given as to their compliance with any Regulations. Offers should be made using the Combined Standard Clauses.