

34 Green Way, Bromley, Kent, BR2 8EY

Property Images









Green Way, Bromley, BR2

Approximate Gross Internal Area
119.7 sq m / 1288 sq ft
(Including Room In Roof / Excluding Bar)

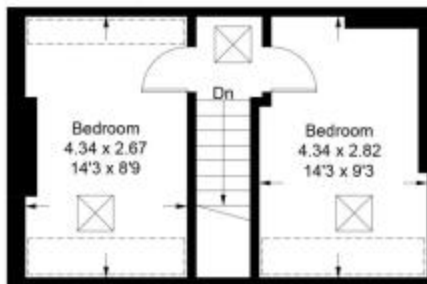

Room In Roof



= Reduced headroom below 1.5m / 5'0

Ground Floor

First Floor

This plan is for layout guidance only. Not drawn to scale unless stated. Windows and door openings are approximate. Whilst every care is taken in the preparation of this plan, please check all dimensions, shapes and compass bearings before making any decisions reliant upon them.
Produced by Planpix on behalf of Sinclair Hammelton (ID811588)