



27 Farmers Road, Staines-upon-Thames, Surrey, TW18 3JE

WELL PRESENTED END-TERRACED CHARACTER COTTAGE SITUATED IN THIS MUCH SOUGHT AFTER CLOSE IDEALLY LOCATED FOR TOWN CENTRE, THE RIVER THAMES & LOCAL MOTORWAY NETWORKS. The property benefits from a spacious lounge, separate kitchen/diner, two well-proportioned bedrooms, modern first floor bathroom, secluded rear garden with brick-built office with shower room. Residents Permit Parking. NO ONWARD CHAIN. Viewings Highly Recommended!

ROOM DESCRIPTIONS

Hardwood door leading to:

Entrance Hall

Light point, stairs to first floor.

Lounge

Front aspect Sash window, light and power points, radiator, cast-iron feature fireplace, stripped wooden floorboards, TV point.



Kitchen/Diner

Rear aspect Sash window, range of fitted units at eye and base level, roll edged worktops, sink drainer unit, space for washing machine, slim-line dishwasher and cooker. Understairs storage cupboard, stripped wooden floorboards, stable door to Garden.



First Floor

Landing

Light point, radiator, access to loft space.

Bedroom 1

Front aspect window, light and power points, radiator, built-in storage cupboard.



Bedroom 2

Rear aspect window, light and power points, radiator.

Bathroom

Side aspect window, panel enclosed bath, low level W.C, pedestal wash hand basin, Victorian-style radiator, partly tiled walls, light point.



Outside

Front Garden

With gate leading to front door.

ROOM DESCRIPTIONS

Rear Garden

Enclosed by wood-panel fencing and brick wall, gated side access to front. Astro-turf.



Brick-Built Office

Front aspect Sash window, light and power points, shower room with low level W.C & pedestal wash-hand basin.



Residents Parking Permit

We have been advised the cost is £100 per Annum.

FLOORPLAN

Ground Floor

Approx. 35.0 sq. metres (377.0 sq. feet)

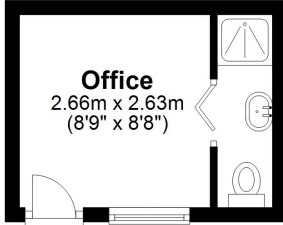

First Floor

Approx. 25.7 sq. metres (277.1 sq. feet)

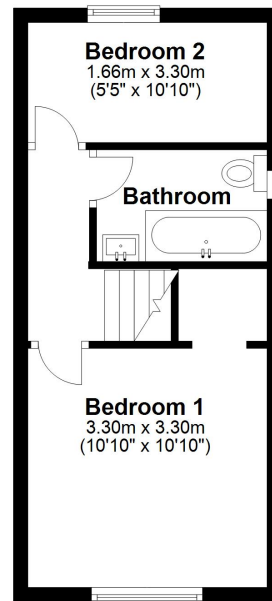
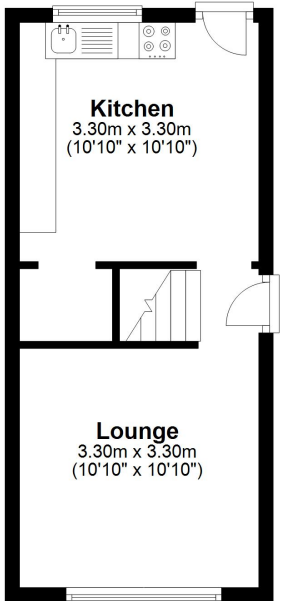

Total area: approx. 60.8 sq. metres (654.0 sq. feet)