

Withies Way

Midsomer Norton, BA3 2NE

COOPER
AND
TANNER



£359,950

🛏️ 4 🛋️ 1 🚿 2 EPC B

Description

A well presented modern town house, constructed by David Wilson Homes in 2013, and situated on this ever popular Withies Bridge residential estate within easy walking distance of the town centre and all its amenities. Benefits include driveway parking for three cars and a detached garage. A spacious property offering flexible accommodation over three floors. All the Bedrooms are doubles with two having bespoke fitted wardrobes.

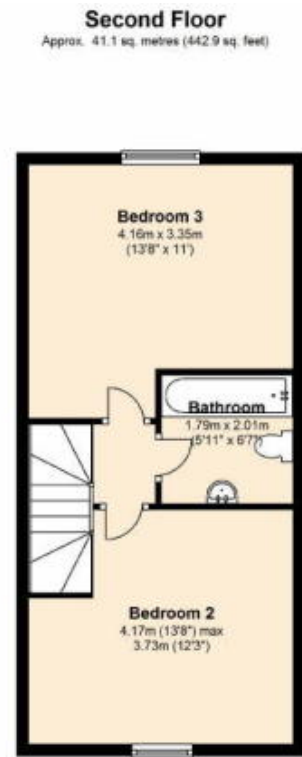
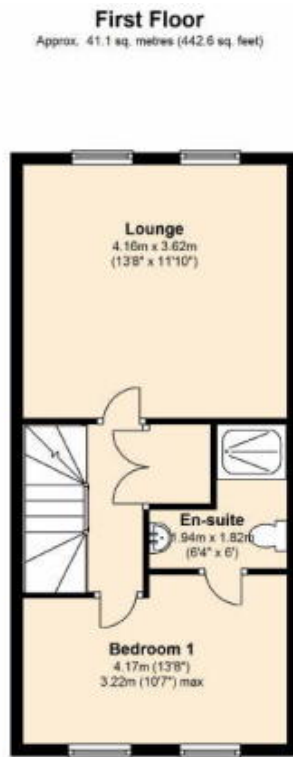
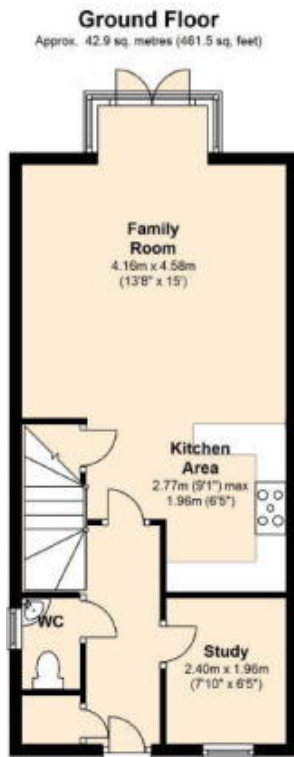

Total area: approx. 125.1 sq. metres (1347.0 sq. feet)



Features

- THREE/FOUR DOUBLE BEDROOMS
- OPEN PLAN KITCHEN/FAMILY ROOM
- STUDY
- CLOAKROOM/WC
- FAMILY BATHROOM
- EN-SUITE SHOWER ROOM TO MASTER BEDROOM
- ENCLOSED REAR GARDEN
- FURTHER DRIVEWAY PARKING FOR TWO CARS
- GARAGE AND GATED PARKING FOR ONE CAR
- WORKSHOP & BIKE SHED

Local Information

- Council Tax Band D
- Tenure
- EPC Rating B

MIDSOMER NORTON OFFICE

Telephone 01761 411010

14, High Street, Midsomer Norton, Somerset BA3 2HP

midsomernorton@cooperandtanner.co.uk

**COOPER
AND
TANNER**

Important Notice: These particulars are set out as a general outline only for the guidance of intended purchasers and do not constitute, nor constitute part of, an offer or contract. All descriptions, dimensions, reference to condition and necessary permissions for use and occupation, warranties and other details are given without responsibility and any intending purchasers should not rely on the m as statements or representations of fact but must satisfy themselves by inspection or otherwise as to the correctness of each of them.

