



Park Lane | Billericay | £4,000 pcm



Park Lane

Billericay | Essex | CM11 1NF

Available Late April/Early May 2024!!

The Property Specialists are delighted to offer for let, this substantial high specification four-bedroom detached family home, which is available to let from the end of April/beginning of May. Situated in the popular village of Ramsden Heath, you will find pleasant countryside nearby, whilst also still being within easy reach of Billericay High Street, the mainline train station and schools.

Internally, this impressive home boasts large reception rooms to the ground floor, including a fantastic and beautifully presented kitchen family room, which is a great place for entertaining. Bi-folding doors open to enjoy views over the rear garden and swimming pool, whilst an imposing mezzanine landing really adds character to the area. The kitchen itself comprises of a range of modern units and beautiful contrasting worktops, with integrated appliances, a large freestanding Rangemaster cooker and a butler sink. An island provides space for stools to be used as a breakfast bar, whilst there is also ample space for a large dining table and chairs. Additional ground floor accommodation includes a cinema room to the front of the home, a great size double bedroom, a large playroom/tv room, a utility room which could effectively be used as a second kitchen and a ground floor shower room and W/C.

Upstairs there are three double bedrooms, all benefitting from en-suite bathrooms, with the large master bedroom boasting a high specification four-piece suite including a large shower, freestanding bathtub and custom made his and hers hand basins. In addition, the master bedroom also boasts a walk-in wardrobe/dressing room with a Juliette balcony overlooking the rear garden. The remaining two bedrooms are both carpeted with fully tiled and modern en-suite shower rooms.

Externally the impressive features of this property continue, with the sunny, westerly facing rear garden commencing with a large patio, fantastic for outdoor entertaining. In addition, there is a swimming pool which can be heated all year round, with the remainder of the garden being laid to lawn, backing onto an open field. Side access will lead you to the front of this beautiful home, where you will find access to an integral garage and a large 'in and out' block paved driveway, providing off street parking for at least four vehicles.

For more information on how to apply for this property, please call The Property Specialists now and we will be happy to discuss this with you.

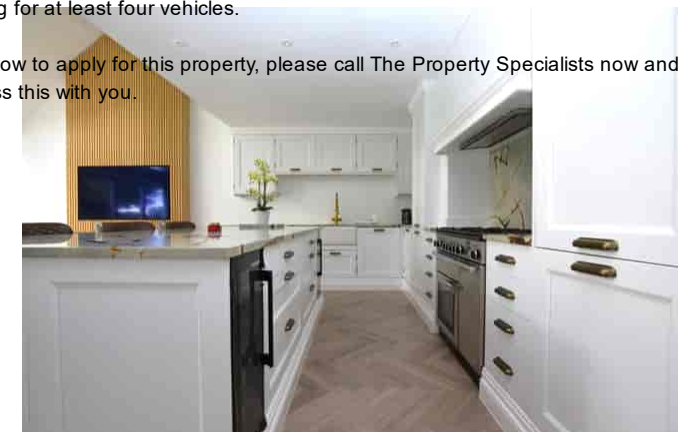
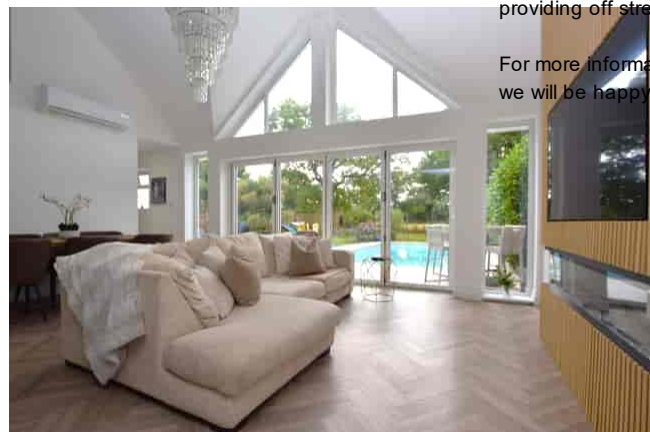



- High Specification Four Bedroom Family Home
- Available Late April/Early May 2024
- Village Location Within Easy Reach of Billerica High Street & Train Station
- Beautifully Presented Throughout
- Large Kitchen/Family Room Fantastic For Entertaining
- Ground Floor Cinema Room
- Playroom/TV Room
- Large Utility Room
- Impressive Master Bedroom With High Specification En-Suite Bathroom and Dressing Room
- Three Additional Double Bedrooms
- Two Additional En-Suite Shower Rooms
- Mezzanine Landing Over Looking The Kitchen/Family Room
- Large Garden With Heated Swimming Pool
- Integral Garage
- Large Block Paved In and Out Driveway



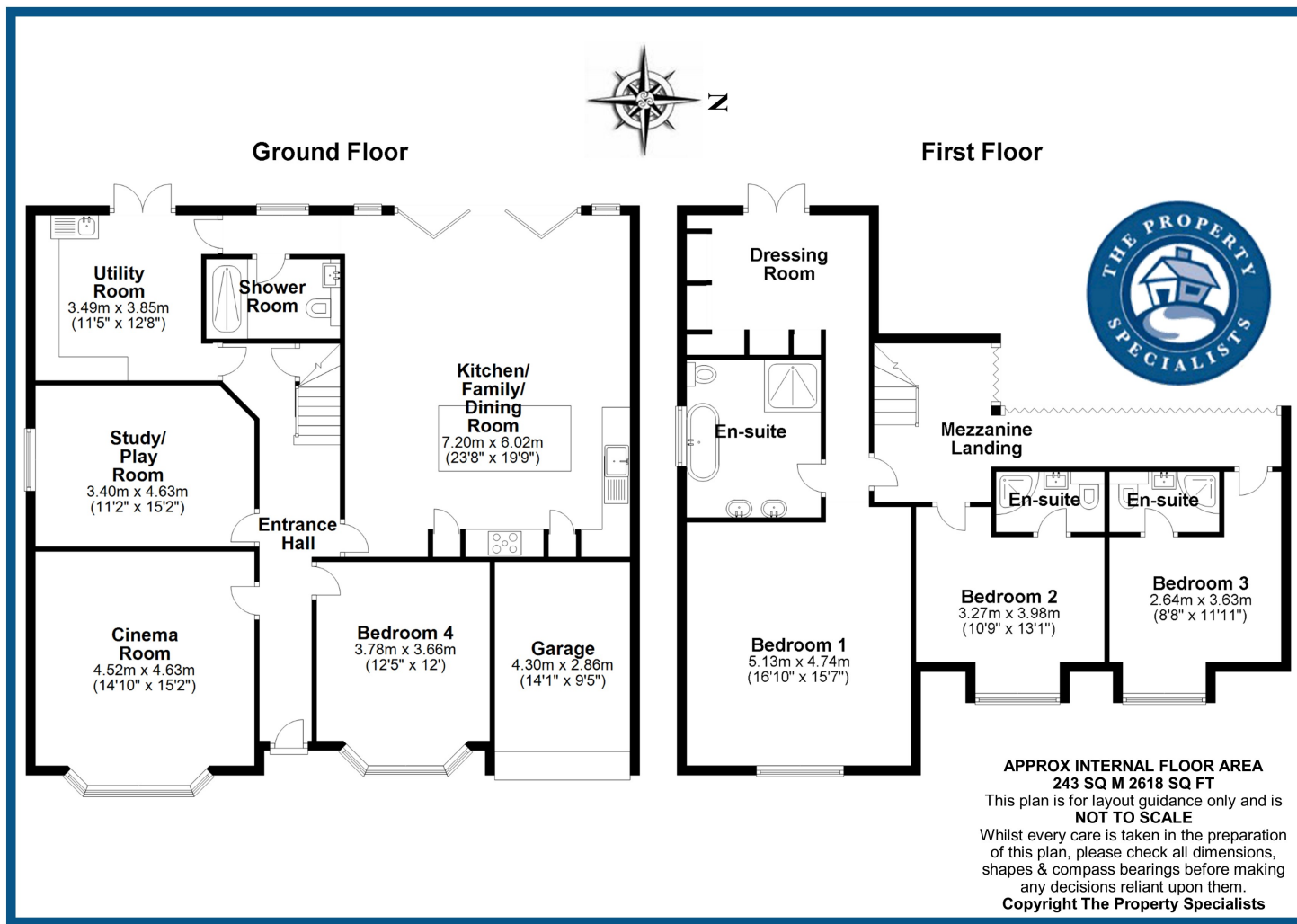

Viewing strictly by appointment with The Property Specialists



Making Moving Home
Less Stressful

135 High Street, Billericay,
 Essex, CM12 9AB
Tel: 01277 654446
sales@thepropertyspecialists.co.uk