

233 Crofton Lane, Petts Wood, Orpington, Kent, BR6 0BL

## Property Images









# Crofton Lane, Petts Wood, Orpington, BR6

Approximate Area = 1431 sq ft / 133 sq m

Garage = 140 sq ft / 13 sq m

Outbuilding = 139 sq ft / 13 sq m

Total = 1710 sq ft / 159 sq m

For identification only - Not to scale

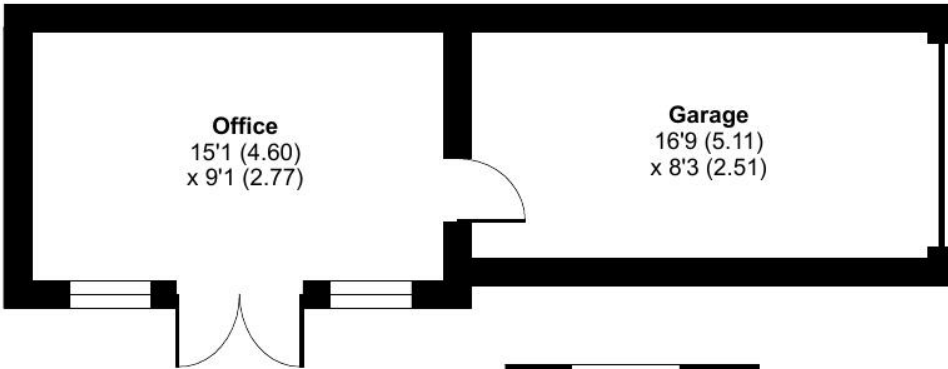

**Garden**  
Approximate  
36'5 (11.10)  
x 36'1 (10.99)

**Utility**  
16'4 (4.98)  
x 7'3 (2.21)

**Kitchen /  
Dining Room**  
21'3 (6.48)  
x 12'4 (3.76)

**Entrance Hall**  
21'3 (6.48)  
x 5'10 (1.78)

**Reception Room**  
21' (6.40)  
x 11'4 (3.45)

**GROUND FLOOR**

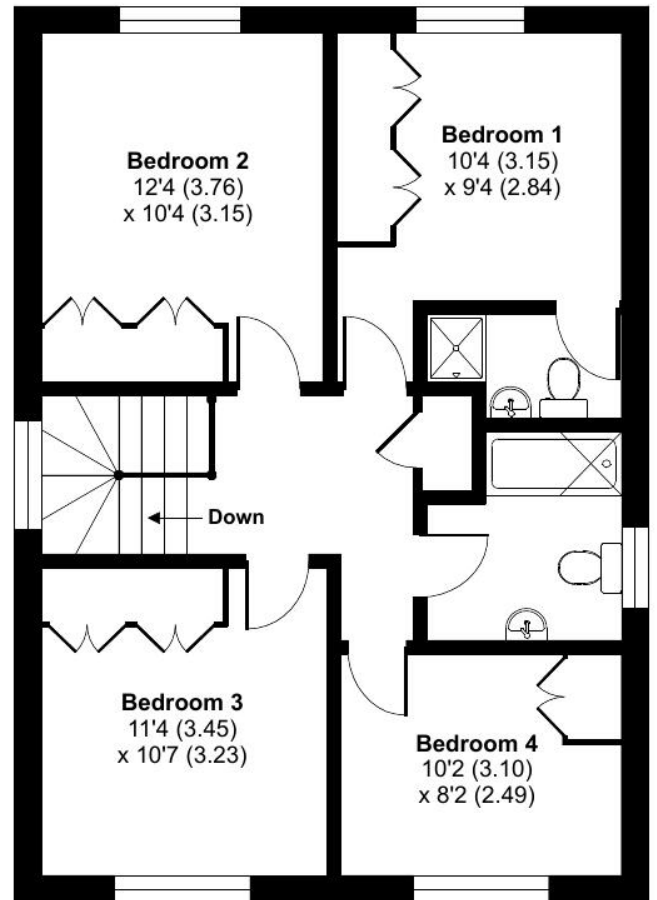

**FIRST FLOOR**